

M00110/M00120

SKIVE FERRULE FOR WIRE BRAID HOSES
 CASQUILLO CON PELADO PARA MANGUERAS CON TRENZA DE ACERO
 SCHÄLFASSUNG FÜR STAHLGEFLECHTSCHLÄUCHE
 GHIERA PER TUBI TRECCIATI CON PELATURA

PART. REF.	HOSE BORE			DIMENSIONS mm					
	DN	inch	Size	D	L				
M00120-03	5	3/16"	- 03	17,0	23,9				
M00120-04	6	1/4"	- 04	19,5	28,0				
M00120-05	8	5/16"	- 05	20,0	28,6				
M00120-06	10	3/8"	- 06	23,0	30,0				
M00120-08	12	1/2"	- 08	26,7	32,0				
M00120-10	16	5/8"	- 10	32,0	38,0				
M00120-12	19	3/4"	- 12	35,8	41,7				
M00120-16	25	1"	- 16	43,0	47,0				
M00110-20	31	1.1/4"	- 20	50,5	59,0				
M00110-24	38	1.1/2"	- 24	57,0	70,0				
M00110-32	51	1"	- 32	70,0	72,0				

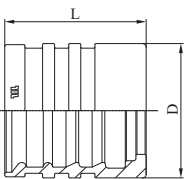

M00910/M00920

SKIVE FERRULE FOR WIRE BRAID AND SPIRAL HOSES
 CASQUILLO CON PELADO PARA MANGUERAS CON TRENZA Y ESPIRAL DE ACERO
 SCHÄLFASSUNG FÜR STAHLGEFLECHT- UND SPIRALSCHLÄUCHE
 GHIERA PER TUBI TRECCIATI E SPIRALATI CON PELATURA

PART. REF.	HOSE BORE			DIMENSIONS mm					
	DN	inch	Size	D	L				
M00910-03	5	3/16"	- 03	20,6	26,0				
M00910-04	6	1/4"	- 04	22,0	30,0				
M00910-05	8	5/16"	- 05	24,0	31,0				
M00910-06	10	3/8"	- 06	26,0	33,0				
M00910-08	12	1/2"	- 08	30,0	34,0				
M00910-10	16	5/8"	- 10	33,0	39,0				
M00920-12	19	3/4"	- 12	38,0	40,0				
M00920-16	25	1"	- 16	46,0	54,0				
M00920-20	31	1.1/4"	- 20	57,0	60,0				
M00910-24	38	1.1/2"	- 24	65,0	70,0				
M00910-32	51	2"	- 32	79,0	72,0				

FERRULE

M03400

NO-SKIVE FERRULE FOR WIRE BRAID HOSES

CASQUILLO SIN PELADO PARA MANGUERAS CON TRENZA DE ACERO

NICHT-SCHÄLFASSUNG FÜR STAHLGEFLECHTSCHLÄUCHE

GHIERA PER TUBI TRECCIATI SENZA PELATURA

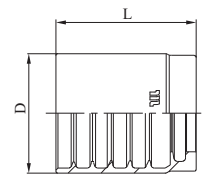

PART. REF.	HOSE BORE			DIMENSIONS mm					
	DN	inch	Size	D	L				
M03400-03	5	3/16"	- 03	21,0	23,0				
M03400-04	6	1/4"	- 04	23,0	30,1				
M03400-05	8	5/16"	- 05	24,0	30,0				
M03400-06	10	3/8"	- 06	26,0	31,1				
M03400-08	12	1/2"	- 08	29,0	33,4				
M03400-10	16	5/8"	- 10	33,0	37,0				
M03400-12	19	3/4"	- 12	37,0	42,0				
M03400-16	25	1"	- 16	46,0	51,0				
M03400-20	31	1.1/4"	- 20	59,0	57,2				
M03400-24	38	1.1/2"	- 24	67,0	64,8				
M03400-32	51	2"	- 32	80,0	68,3				
M03400-38	60	2.3/8"	- 38	82,5	69,0				
M03400-40	63	2. 1/2"	- 40	88,2	68,8				
M03400-48	76	3"	- 48	103,0	75,0				

! Available no-skive ferrule for one braid hoses for DN 6 (M03100-04) and DN 10 (M03100-06).
 Disponible casquillo sin pelado para mangueras de una trenza para DN 6 (M03100-04) y DN 10 (M03100-06).
 Verfügbar hülse ohne abschälen für 1-drahtgeflechschläuche für DN 6 (M03100-04) und DN 10 (M03100-06)
 Disponibile ghiera per tubi a una treccia senza pelatura per DN 6 (M03100-04) e DN 10 (M03100-06).

M00310

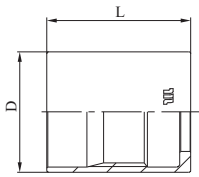

NO-SKIVE FERRULE FOR TEXTILE BRAID HOSES
 CASQUILLO SIN PELADO PARA MANGUERAS CON REFUERZO TEXTIL TRENZADO
 NICHT-SCHÄLFASSUNG FÜR TEXTILGEFLECHTSCHLÄUCHE
 GHIERA PER TUBI TESSILI SENZA PELATURA

PART. REF.	HOSE BORE			DIMENSIONS mm					
	DN	inch	Size	D	L				
M00310-03	5	3/16"	- 03	17,5	27,0				
M00310-04	6	1/4"	- 04	19,3	30,0				
M00310-05	8	5/16"	- 05	21,0	32,0				
M00310-06	10	3/8"	- 06	24,0	32,0				
M00310-08	12	1/2"	- 08	28,4	34,0				
M00310-10	16	5/8"	- 10	33,0	37,0				
M00310-12	19	3/4"	- 12	37,0	43,0				
M00310-16	25	1"	- 16	43,5	51,0				
M00310-20	31	1.1/4"	- 20	50,0	59,0				

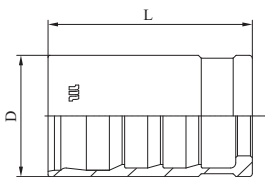

M00820/M00830

NO-SKIVE FERRULE FOR COMPACT HOSES
 CASQUILLO SIN PELADO PARA MANGUERA COMPACTA
 NICHT-SCHÄLFASSUNG FÜR KOMPAKT-SCHLÄUCHE
 GHIERA PER TUBI COMPATTI SENZA PELATURA

PART. REF.	HOSE BORE			DIMENSIONS mm					
	DN	inch	Size	D	L				
M00820-03	5	3/16"	- 03	14,0	26,4				
new M00830-04	6	1/4"	- 04	18,0	29,6				
new M00830-05	8	5/16"	- 05	19,0	31,9				
M00820-06	10	3/8"	- 06	22,0	33,0				
M00820-08	12	1/2"	- 08	26,0	33,9				
M00820-10	16	5/8"	- 10	29,0	35,9				
M00820-12	19	3/4"	- 12	33,0	41,7				
M00820-16	25	1"	- 16	41,0	49,7				
M00820-20	31	1.1/4"	- 20	48,0	57,0				
M00820-24	38	1.1/2"	- 24	55,5	66,0				
M00820-32	51	2"	- 32	68,6	70,0				

BS STANDARD CONNECTIONS

M10710

BSP MALE TAPERED - ISO 7

MACHO BSP (BSPT) ROSCA CONICA - ISO 7

AGR KONISCH (BSPT GEWINDE NACH) - ISO 7

MASCHIO CONICO GAS - ISO 7

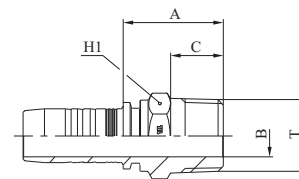

PART. REF.	HOSE BORE		THREAD	DIMENSIONS mm						
------------	-----------	--	--------	------------------	--	--	--	--	--	--

	DN	inch	Size	T	B	A	C			H ₁
M10710-03-02	5	3/16"	- 03	1/8" - 28	4,5	20,6	8,0			12
M10710-03-04	5	3/16"	- 03	1/4" - 19	4,5	24,5	12,0			14
M10710-04-02	6	1/4"	- 04	1/8" - 28	4,5	21,0	8,0			12
M10710-04-04	6	1/4"	- 04	1/4" - 19	4,5	25,0	12,0			14
M10710-04-06	6	1/4"	- 04	3/8" - 19	7,0	26,0	12,0			19
M10710-04-08	6	1/4"	- 04	1/2" - 14	10,0	29,5	15,0			22
M10710-05-04	8	5/16"	- 05	1/4" - 19	5,5	25,0	12,0			14
M10710-05-06	8	5/16"	- 05	3/8" - 19	7,0	26,5	12,0			19
M10710-05-08	8	5/16"	- 05	1/2" - 14	10,0	30,0	15,0			22
M10710-06-06	10	3/8"	- 06	3/8" - 19	7,0	27,1	12,0			19
M10710-06-08	10	3/8"	- 06	1/2" - 14	10,0	30,6	15,0			22
M10710-08-04	12	1/2"	- 08	1/4" - 19	4,5	26,0	12,0			19
M10710-08-08	12	1/2"	- 08	1/2" - 14	10,0	31,1	15,0			22
M10710-10-08	16	5/8"	- 10	1/2" - 14	10,0	31,0	15,0			22
M10710-10-12	16	5/8"	- 10	3/4" - 14	17,0	37,0	17,0			27
M10710-12-12	19	3/4"	- 12	3/4" - 14	17,0	35,5	17,0			27
M10710-16-12	25	1"	- 16	3/4" - 14	17,0	38,0	17,0			32
M10710-16-16	25	1"	- 16	1" - 11	22,5	41,8	21,0			36
M10710-20-20	31	1.1/4"	- 20	1.1/4" - 11	28,5	47,5	23,0			46
M10710-24-24	38	1.1/2"	- 24	1.1/2" - 11	32,0	50,0	23,0			50
M10710-32-32	51	2"	- 32	2" - 11	44,0	55,4	27,0			65

M10510

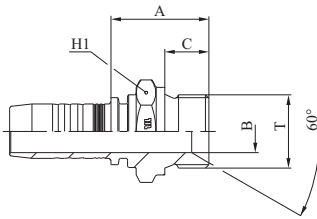

BSP MALE PARALLEL 60° CONE SEAT - BS5200 / ISO 8434-6
 MACHO BSP PARALELO ASIENTO A 60° - BS5200 / ISO 8434-6
 AGR 60° INNENKONUS (BSP-GEWINDE NACH BS5200 / ISO 8434-6)
 MASCHIO GAS CILINDRICO 60° - BS5200 / ISO 8434-6

PART. REF.	HOSE BORE			THREAD	DIMENSIONS mm				
	DN	inch	Size		T	B	A	C	H ₁
M10510-03-02	5	3/16"	- 03	1/8" - 28	3,5	22,5	10,0		14
M10510-03-04	5	3/16"	- 03	1/4" - 19	5,0	25,0	11,0		19
M10510-04-02	6	1/4"	- 04	1/8" - 28	3,5	22,5	10,0		14
M10510-04-04	6	1/4"	- 04	1/4" - 19	5,0	25,5	11,0		19
M10510-04-06	6	1/4"	- 04	3/8" - 19	8,0	27,0	12,0		22
M10510-04-08	6	1/4"	- 04	1/2" - 14	11,0	30,0	14,0		27
M10510-05-04	8	5/16"	- 05	1/4" - 19	5,0	26,0	11,0		19
M10510-05-06	8	5/16"	- 05	3/8" - 19	8,0	27,5	12,0		22
M10510-06-04	10	3/8"	- 06	1/4" - 19	5,0	26,0	11,0		19
M10510-06-06	10	3/8"	- 06	3/8" - 19	8,0	28,1	12,0		22
M10510-06-08	10	3/8"	- 06	1/2" - 14	11,0	30,6	14,0		27
M10510-08-06	12	1/2"	- 08	3/8" - 19	8,0	28,1	12,0		22
M10510-08-08	12	1/2"	- 08	1/2" - 14	11,0	31,1	14,0		27
M10510-08-10	12	1/2"	- 08	5/8" - 14	14,5	33,1	16,0		30
M10510-08-12	12	1/2"	- 08	3/4" - 14	17,0	34,1	16,0		32
M10510-10-10	16	5/8"	- 10	5/8" - 14	14,5	33,1	16,0		30
M10510-10-12	16	5/8"	- 10	3/4" - 14	17,0	34,1	16,0		32
M10510-12-08	19	3/4"	- 12	1/2" - 14	11,0	32,0	14,0		27
M10510-12-12	19	3/4"	- 12	3/4" - 14	17,0	35,5	16,0		32
M10510-12-16	19	3/4"	- 12	1" - 11	22,5	39,5	19,0		41
M10510-16-12	25	1"	- 16	3/4" - 14	17,0	36,5	16,0		32
M10510-16-16	25	1"	- 16	1" - 11	22,5	40,8	19,0		41
M10510-16-20	25	1"	- 16	1.1/4" - 11	28,5	44,8	20,0		50
M10510-20-20	31	1.1/4"	- 20	1.1/4" - 11	28,5	46,5	20,0		50
M10510-20-24	31	1.1/4"	- 20	1.1/2" - 11	33,5	48,5	22,0		55
M10510-24-24	38	1.1/2"	- 24	1.1/2" - 11	33,5	49,5	22,0		55
M10510-32-32	31	2"	- 32	2" - 11	46,0	53,9	25,0		70

BS STANDARD CONNECTIONS

M20512

BSP FEMALE 60° CONE - BS5200 / ISO 12151-6 (THRUST-WIRE NUT)
 HEMBRA BSP ASIENTO A 60° - BS5200 / ISO 12151-6 (TUERCA CON SEGURO)
 DKR 60° KONUS (BSP-GEWINDE NACH BS5200 / ISO 12151-6, GESTIFTETE MUTTER)
 FEMMINA GAS CONO 60° - BS5200 / ISO 12151-6 (DADO SPINATO)

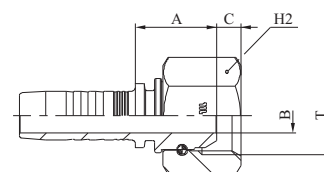

M20513

BSP FEMALE 60° CONE - BS5200 / ISO 12151-6 (SLIP-ON NUT)
 HEMBRA BSP ASIENTO A 60° - BS5200 / ISO 12151-6 (TUERCA LIBRE)
 DKR 60° KONUS (BSP-GEWINDE NACH BS5200 / ISO 12151-6, HINTERLEGTE MUTTER)
 FEMMINA GAS CONO 60° - BS5200 / ISO 12151-6 (DADO PASSANTE)

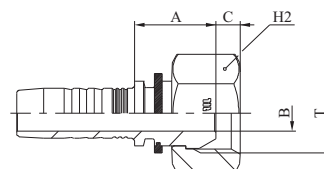

PART. REF.	HOSE BORE			THREAD	DIMENSIONS mm				
	DN	inch	Size		T	B	A	C	H ₂
M20512-03-02	5	3/16"	- 03	1/8" - 28	3,1	14,8	4,4		14
M20513-03-04	5	3/16"	- 03	1/4" - 19	4,0	16,5	5,4		19
M20512-04-02	6	1/4"	- 04	1/8" - 28	3,1	15,5	4,4		14
M20513-04-04	6	1/4"	- 04	1/4" - 19	4,0	17,0	5,4		19
M20513-04-06	6	1/4"	- 04	3/8" - 19	7,0	19,1	6,0		22
M20512-05-04	8	5/16"	- 05	1/4" - 19	4,1	17,5	4,2		19
M20513-05-06	8	5/16"	- 05	3/8" - 19	7,0	19,1	6,0		22
M20513-05-08	8	5/16"	- 05	1/2" - 14	9,3	20,5	6,5		27
M20512-06-04	10	3/8"	- 06	1/4" - 19	4,1	18,1	4,2		19
M20513-06-06	10	3/8"	- 06	3/8" - 19	7,0	19,6	6,0		22
M20513-06-08	10	3/8"	- 06	1/2" - 14	9,3	20,0	6,5		27
M20512-08-06	12	1/2"	- 08	3/8" - 19	7,1	20,9	6,0		22
M20513-08-08	12	1/2"	- 08	1/2" - 14	9,3	20,4	6,5		27
M20512-08-10	12	1/2"	- 08	5/8" - 14	12,1	21,9	10,2		28
M20512-08-12	12	1/2"	- 08	3/4" - 14	15,0	23,4	9,0		32
M20512-10-08	16	5/8"	- 10	1/2" - 14	9,8	24,0	6,5		27
M20512-10-10	16	5/8"	- 10	5/8" - 14	12,5	21,7	10,2		28
M20512-10-12	16	5/8"	- 10	3/4" - 14	15,0	23,2	9,0		32
M20512-12-08	19	3/4"	- 12	1/2" - 14	9,8	25,0	6,5		27
M20512-12-12	19	3/4"	- 12	3/4" - 14	15,0	24,5	9,0		32
M20512-12-16	19	3/4"	- 12	1" - 11	19,8	26,0	10,5		38
M20512-16-12	25	1"	- 16	3/4" - 14	15,0	25,5	9,0		32
M20512-16-16	25	1"	- 16	1" - 11	19,8	27,3	10,5		38

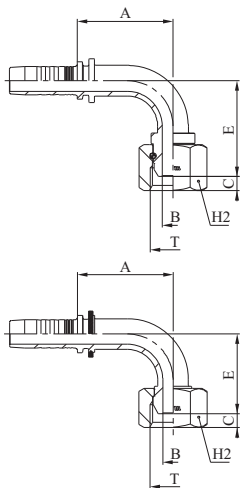

M20592

90° BSP FEMALE SWEPT ELBOW 60° CONE - BS5200 / ISO 12151-6 (THRUST-WIRE NUT)
 HEMBRA BSP CODO DE 90° ASIENTO A 60° - BS5200 / ISO 12151-6 (TUERCA CON SEGURO)
 DKR 90° BOGEN 60° KONUS - (BSP-GEWINDE NACH BS5200 / ISO 12151-6, GESTIFTETE MUTTER)
 FEMMINA GAS 90° CONO 60° - BS5200 / ISO 12151-6 (DADO SPINATO)

M20593

90° BSP FEMALE SWEPT ELBOW 60° CONE - BS5200 / ISO 12151-6 (SLIP-ON NUT)
 HEMBRA BSP CODO DE 90° ASIENTO A 60° - BS5200 / ISO 12151-6 (TUERCA LIBRE)
 DKR 90° BOGEN 60° KONUS - (BSP-GEWINDE NACH BS5200 / ISO 12151-6, HINTERLEGTE MUTTER)
 FEMMINA GAS 90° CONO 60° - BS5200 / ISO 12151-6 (DADO PASSANTE)

PART. REF.	HOSE BORE			THREAD	DIMENSIONS mm					
	DN	inch	Size		T	B	A	C	E	H ₂
M20592-03-02	5	3/16"	- 03	1/8" - 28	3,1	21,5	4,4	26,0		14
M20593-03-04	5	3/16"	- 03	1/4" - 19	4,0	29,0	5,4	29,0		19
M20592-04-02	6	1/4"	- 04	1/8" - 28	3,1	28,5	4,4	27,0		14
M20593-04-04	6	1/4"	- 04	1/4" - 19	4,0	29,5	5,4	29,0		19
M20593-04-06	6	1/4"	- 04	3/8" - 19	7,0	29,5	6,0	31,0		22
M20592-05-04	8	5/16"	- 05	1/4" - 19	4,1	26,5	5,4	29,5		19
M20593-05-06	8	5/16"	- 05	3/8" - 19	7,0	32,0	6,0	27,5		22
M20593-05-08	8	5/16"	- 05	1/2" - 14	9,3	36,5	6,5	32,0		27
M20592-06-04	10	3/8"	- 06	1/4" - 19	4,0	27,0	4,2	29,5		19
M20593-06-06	10	3/8"	- 06	3/8" - 19	7,0	36,5	6,0	31,5		22
M20593-06-08	10	3/8"	- 06	1/2" - 14	9,3	36,5	6,5	32,0		27
M20592-08-06	12	1/2"	- 08	3/8" - 19	7,0	45,0	6,0	41,0		22
M20593-08-08	12	1/2"	- 08	1/2" - 14	9,3	45,0	6,5	36,5		27
M20592-08-10	12	1/2"	- 08	5/8" - 14	12,1	44,0	10,2	44,0		28
M20592-08-12	12	1/2"	- 08	3/4" - 14	15,0	44,0	9,0	45,5		32
M20592-10-08	16	5/8"	- 10	1/2" - 14	9,3	53,5	6,5	54,5		27
M20592-10-10	16	5/8"	- 10	5/8" - 14	12,5	53,5	10,2	53,5		28
M20592-10-12	16	5/8"	- 10	3/4" - 14	15,0	53,5	9,0	55,0		32
M20592-12-08	19	3/4"	- 12	1/2" - 14	9,3	45,5	6,5	44,0		27
M20592-12-12	19	3/4"	- 12	3/4" - 14	15,5	61,5	9,0	59,5		32
M20592-12-16	19	3/4"	- 12	1" - 11	19,8	61,5	10,5	62,0		38
M20592-16-12	25	1"	- 16	3/4" - 14	15,0	64,5	9,0	59,5		32
M20592-16-16	25	1"	- 16	1" - 11	19,8	79,5	10,5	76,0		38

BS STANDARD CONNECTIONS

M20542

45° BSP FEMALE SWEPT ELBOW 60° CONE - BS5200 / ISO 12151-6 (THRUST-WIRE NUT)
 HEMBRA BSP CODO DE 45° ASIENTO A 60° - BS5200 / ISO 12151-6 (TUERCA CON SEGURO)
 DKR 45° BOGEN 60° KONUS - (BSP-GEWINDE NACH BS5200 / ISO 12151-6, GESTIFTETE MUTTER)
 FEMMINA GAS 45° CONO 60° - BS5200 / ISO 12151-6 (DADO SPINATO)

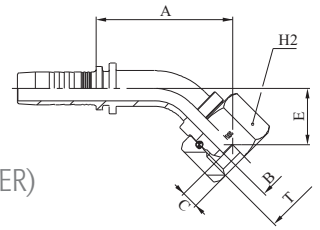

M20543

45° BSP FEMALE SWEPT ELBOW 60° CONE - BS5200 / ISO 12151-6 (SLIP-ON NUT)
 HEMBRA BSP CODO DE 45° ASIENTO A 60° - BS5200 / ISO 12151-6 (TUERCA LIBRE)
 DRK 45° BOGEN 60° KONUS - (BSP-GEWINDE NACH BS5200 / ISO 12151-6, HINTERLEGTE MUTTER)
 FEMMINA GAS 45° CONO 60° - BS5200 / ISO 12151-6 (DADO PASSANTE)

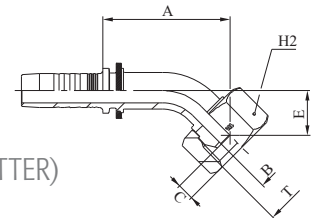

PART. REF.	HOSE BORE			THREAD	DIMENSIONS mm					
	DN	inch	Size		T	B	A	C	E	H ₂
M20542-03-02	5	3/16"	- 03	1/8" - 28	3,1	31,0	4,4	15,0		14
M20543-03-04	5	3/16"	- 03	1/4" - 19	4,0	35,5	5,4	14,5		19
M20542-04-02	6	1/4"	- 04	1/8" - 28	3,1	35,5	4,4	14,5		14
M20543-04-04	6	1/4"	- 04	1/4" - 19	4,0	36,0	5,4	15,0		19
M20543-04-06	6	1/4"	- 04	3/8" - 19	7,0	37,5	6,0	16,0		19
M20542-05-04	8	5/16"	- 05	1/4" - 19	4,0	35,5	5,4	16,0		19
M20543-05-06	8	5/16"	- 05	3/8" - 19	7,0	38,0	6,0	13,5		22
M20543-06-06	10	3/8"	- 06	3/8" - 19	7,0	42,0	6,0	15,0		22
M20543-06-08	10	3/8"	- 06	1/2" - 14	9,3	42,5	6,5	16,0		27
M20542-08-06	12	1/2"	- 08	3/8" - 19	7,1	52,0	6,0	20,0		22
M20543-08-08	12	1/2"	- 08	1/2" - 14	9,3	49,5	6,5	17,0		27
M20542-08-10	12	1/2"	- 08	5/8" - 14	12,1	54,5	10,2	22,5		28
M20542-08-12	12	1/2"	- 08	3/4" - 14	15,0	57,0	9,0	25,0		32
M20542-10-10	16	5/8"	- 10	5/8" - 14	12,5	63,0	10,2	26,0		28
M20542-10-12	16	5/8"	- 10	3/4" - 14	15,0	64,0	9,0	27,0		32
M20542-12-08	19	3/4"	- 12	1/2" - 14	9,3	55,5	6,5	22,5		27
M20542-12-12	19	3/4"	- 12	3/4" - 14	15,5	70,5	9,0	28,5		32
M20542-12-16	19	3/4"	- 12	1" - 11	19,8	72,5	10,5	30,0		38
M20542-16-16	25	1"	- 16	1" - 11	19,8	91,0	10,5	36,5		38

M20812

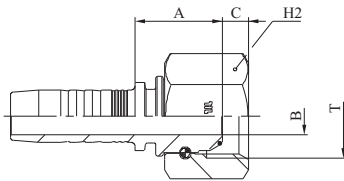

BSP O-RING FEMALE 60° CONE - BS5200 / ISO 12151-6 (THRUST-WIRE NUT)
 HEMBRA BSP CON O-RING ASIENTO A 60° - BS5200 / ISO 12151-6 (TUERCA CON SEGURO)
 DKOR 60° KONUS MIT O-RING -
 (BSP-GEWINDE NACH BS5200 / ISO 12151-6 GESTIFTETE MUTTER)
 FEMMINA GAS CONO 60° O-RING - BS5200 / ISO 12151-6 (DADO SPINATO)

M20813

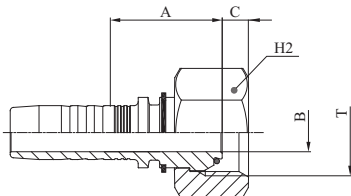

BSP O-RING FEMALE 60° CONE - BS5200 / ISO 12151-6 (SLIP-ON NUT)
 HEMBRA BSP CON O-RING ASIENTO A 60° - BS5200 / ISO 12151-6 (TUERCA LIBRE)
 DKOR 60° KONUS MIT O-RING
 (BSP-GEWINDE NACH BS5200 / ISO 12151-6 HINTERLEGTE MUTTER)
 FEMMINA GAS CONO 60° O-RING BS5200 / ISO 12151-6 (DADO PASSANTE)

PART. REF.	HOSE BORE			THREAD	DIMENSIONS mm				
	DN	inch	Size		T	B	A	C	H ₂
M20813-03-04	5	3/16"	- 03	1/4" - 19	4,0	16,5	4,9		19
M20813-04-04	6	1/4"	- 04	1/4" - 19	4,0	17,5	4,9		19
M20812-06-04	10	3/8"	- 06	1/4" - 19	4,0	18,1	4,9		19
M20813-06-06	10	3/8"	- 06	3/8" - 19	7,0	20,4	6,1		22
M20813-06-08	10	3/8"	- 06	1/2" - 14	9,3	21,0	6,5		27
M20813-08-08	12	1/2"	- 08	1/2" - 14	9,3	20,4	6,5		27
M20812-10-10	16	5/8"	- 10	5/8" - 14	12,5	22,1	9,7		28
M20812-12-12	19	3/4"	- 12	3/4" - 14	15,0	25,0	8,5		32
M20812-16-12	25	1"	- 16	3/4" - 14	15,0	26,0	8,5		32
M20812-16-16	25	1"	- 16	1" - 11	19,8	27,3	10,6		38
M20812-16-20	25	1"	- 16	1.1/4" - 11	26,1	30,8	10,5		50
M20812-20-16	31	1.1/4"	- 20	1" - 11	19,8	29,0	10,5		38
M20812-20-20	31	1.1/4"	- 20	1.1/4" - 11	26,0	31,5	10,5		50
M20812-20-24	31	1.1/4"	- 20	1.1/2" - 11	32,1	29,5	12,5		60
M20812-24-20	38	1.1/2"	- 24	1.1/4" - 11	26,0	31,5	10,5		50
M20812-24-24	38	1.1/2"	- 24	1.1/2" - 11	32,0	30,5	12,5		60
M20812-24-32	38	1.1/2"	- 24	2" - 11	42,0	30,0	16,1		70
M20812-32-32	51	2"	- 32	2" - 11	42,0	31,9	16,1		70

BS STANDARD CONNECTIONS

M20892

90° BSP O-RING FEMALE SWEEP ELBOW 60° CONE - BS5200 / ISO 12151-6 (THRUST-WIRE NUT)
 HEMBRA BSP CON O-RING CODO DE 90° ASIENTO A 60° - BS5200 / ISO 12151-6 (TUERCA CON SEGURO)
 DKOR 90° BOGEN 60° KONUS MIT O-RING (BSP-GEWINDE NACH BS5200 / ISO 12151-6, GESTIFTETE MUTTER)
 FEMMINA GAS 90° CONO 60° O-RING - BS5200 / ISO 12151-6 (DADO SPINATO)

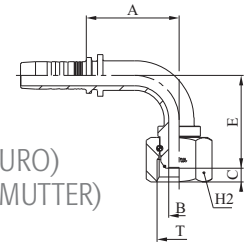

M20893

90° BSP O-RING FEMALE SWEEP ELBOW 60° CONE - BS5200 / ISO 12151-6 (SLIP-ON NUT)
 HEMBRA BSP CON O-RING CODO DE 90° ASIENTO A 60° - BS5200 / ISO 12151-6 (TUERCA LIBRE)
 DKOR 90° BOGEN 60° KONUS MIT O-RING (BSP-GEWINDE NACH BS5200 / ISO 12151-6 HINTERLEGTE MUTTER)
 FEMMINA GAS 90° CONO 60° O-RING BS5200 / ISO 12151-6 (DADO PASSANTE)

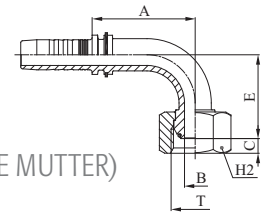

PART. REF.	HOSE BORE			THREAD	DIMENSIONS mm					
------------	-----------	--	--	--------	---------------	--	--	--	--	--

	DN	inch	Size	T	B	A	C	E		H ₂
M20893-03-04	5	3/16"	- 03	1/4" - 19	4,0	29,0	4,9	29,0		19
M20893-04-04	6	1/4"	- 04	1/4" - 19	4,0	28,5	4,9	28,5		19
M20892-06-04	10	3/8"	-06	1/4" - 19	4,0	35,5	4,9	33,0		19
M20893-06-06	10	3/8"	- 06	3/8" - 19	7,0	35,5	6,1	36,0		22
M20893-08-08	12	1/2"	- 08	1/2" - 14	9,3	44,5	6,5	42,0		27
M20892-10-10	16	5/8"	- 10	5/8" - 14	12,5	53,0	9,7	55,0		30
M20892-12-12	19	3/4"	- 12	3/4" - 14	15,0	61,5	8,5	60,0		32
M20892-12-16	19	3/4"	- 12	1" - 11	19,8	61,5	10,5	62,0		38
M20892-16-12	25	1"	- 16	3/4" - 14	15,0	79,5	8,5	60,0		32
M20892-16-16	25	1"	- 16	1" - 11	19,8	79,5	10,6	76,0		38
M20892-16-20	25	1"	- 16	1.1/4" - 11	26,1	79,5	10,5	78,5		50
M20892-20-16	31	1.1/4"	- 20	1" - 11	19,8	79,5	10,5	76,0		38
M20892-20-20	31	1.1/4"	- 20	1.1/4" - 11	26,0	90,5	10,5	83,5		50
M20892-20-24	31	1.1/4"	- 20	1.1/2" - 11	32,1	90,5	12,5	84,5		60
M20892-24-20	38	1.1/2"	- 24	1.1/4" - 11	26,0	95,0	10,5	90,5		50
M20892-24-24	38	1.1/2"	- 24	1.1/2" - 11	32,0	108,0	12,5	98,5		60
M20892-32-32	51	2"	- 32	2" - 11	42,0	131,0	16,1	110,5		70

M20842

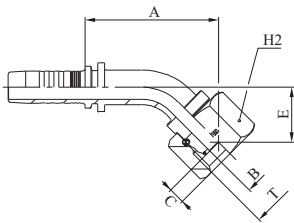

45° BSP O-RING FEMALE SWEPT ELBOW 60° CONE BS5200 / ISO 12151-6 (THRUST-WIRE NUT)
 HEMBRA BSP CON O-RING CODO DE 45° ASIENTO A 60°
 BS5200 / ISO 12151-6 (TUERCA CON SEGURO)
 DKOR 45° BOGEN 60° KONUS MIT O-RING
 (BSP-GEWINDE NACH BS5200 / ISO 12151-6, GESTIFTETE MUTTER)
 FEMMINA GAS 45° CONO 60° O-RING
 BS5200 / ISO 12151-6 (DADO SPINATO)

M20843

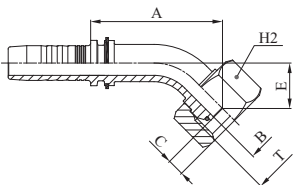

45° BSP O-RING FEMALE SWEPT ELBOW 60° CONE BS5200 / ISO 12151-6 (SLIP-ON NUT)
 HEMBRA BSP CON O-RING CODO DE 45° ASIENTO A 60°
 BS5200 / ISO 12151-6 (TUERCA LIBRE)
 DKOR 45° BOGEN 60° KONUS MIT O-RING
 (BSP-GEWINDE NACH BS5200 / ISO 12151-6, HINTERLEGTE MUTTER)
 FEMMINA GAS 45° CONO 60° O-RING
 BS5200 / ISO 12151-6 (DADO PASSANTE)

PART. REF.	HOSE BORE			THREAD	DIMENSIONS mm					
------------	-----------	--	--	--------	------------------	--	--	--	--	--

	DN	inch	Size	T	B	A	C	E		H ₂
M20843-04-04	6	1/4"	- 04	1/4" -19	4,0	36,0	4,9	15,0		19
M20843-06-06	10	3/8"	- 06	3/8" -19	7,0	44,5	6,1	18,5		22
M20843-08-08	12	1/2"	- 08	1/2" -14	9,3	52,0	6,5	20,5		27
M20842-10-10	16	5/8"	- 10	5/8" -14	12,5	63,5	9,7	27,5		30
M20842-12-12	19	3/4"	- 12	3/4" -14	15,5	71,0	8,5	29,0		32
M20842-16-12	25	1"	- 16	3/4" -14	15,0	79,5	8,5	29,0		32
M20842-16-16	25	1"	- 16	1" -11	19,8	90,5	10,6	35,6		38
M20842-16-20	25	1"	- 16	1.1/4" - 11	26,0	93,0	10,5	38,0		50
M20842-20-20	31	1.1/4"	- 20	1.1/4" - 11	26,0	101,5	10,5	39,0		50
M20842-20-24	31	1.1/4"	- 20	1.1/2" - 11	32,0	118,5	12,5	40,5		60
M20842-24-20	38	1.1/2"	- 24	1.1/4" - 11	26,0	106,5	10,5	42,0		50
M20842-24-24	38	1.1/2"	- 24	1.1/2" -11	32,0	118,0	12,5	45,0		60
M20842-32-32	51	2"	- 32	2" -11	42,0	134,0	16,1	47,0		70

BS STANDARD CONNECTIONS

M20882F

90° BSP O-RING FEMALE COMPACT ELBOW 60° CONE
 BS5200 / ISO 12151-6 (THRUST-WIRE NUT)
 HEMBRA BSP CON O-RING CODO COMPACTO DE 90° ASIENTO A 60°
 BS5200 / ISO 12151-6 (TUERCA CON SEGURO)
 DKOR 90° KOMPAKTBOGEN 60° KONUS MIT O-RING
 (BSP-GEWINDE NACH BS5200 / ISO 12151-6, GESTIFTETE MUTTER)
 FEMMINA GAS 90° CONO 60° O-RING TIPO COMPATTO
 BS5200 / ISO 12151-6 (DADO SPINATO)

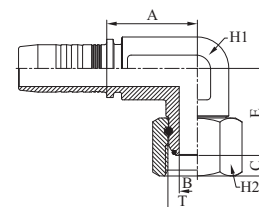

PART. REF.	HOSE BORE			THREAD	DIMENSIONS mm					
	DN	inch	Size		T	B	A	C	E	H ₁
M20882-04-04F	6	1/4"	- 04	1/4" - 19	4,0	20,0	4,9	22,0	14	19
M20882-06-06F	10	3/8"	- 06	3/8" - 19	7,0	23,1	6,1	27,5	19	22
M20882-08-08F	12	1/2"	- 08	1/2" - 14	9,3	24,9	6,5	31,1	22	27
M20882-10-10F	16	5/8"	- 10	5/8" - 14	12,5	24,6	9,7	32,5	24	28
M20882-12-12F	19	3/4"	- 12	3/4" - 14	15,0	37,5	8,5	36,0	27	32
M20882-16-16F	25	1"	- 16	1" - 11	20,0	51,8	10,6	44,0	36	38

M10610

BSP MALE FLAT SEAT
 MACHO BSP CARA PLANA
 AGR FLACH DICHTEND
 MASCHIO GAS CILINDRICO SEDE PIANA

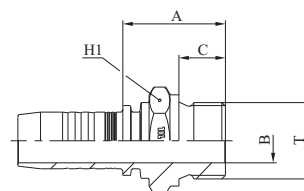

PART. REF.	HOSE BORE			THREAD	DIMENSIONS mm					
	DN	inch	Size		T	B	A	C	H ₁	
M10610-04-04	6	1/4"	- 04	1/4" - 19	6,0	25,5	11,0		19	
M10610-06-06	10	3/8"	- 06	3/8" - 19	9,5	28,1	12,0		22	
M10610-06-08	10	3/8"	- 06	1/2" - 14	13,0	30,6	14,0		27	
M10610-08-08	12	1/2"	- 08	1/2" - 14	13,0	31,1	14,0		27	
M10610-12-12	19	3/4"	- 12	3/4" - 14	18,0	35,5	16,0		32	

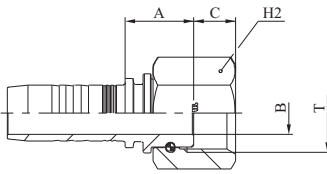

M20612

BSP FEMALE FLAT SEAT (THRUST-WIRE NUT)
 HEMBRA BSP CARA PLANA (TUERCA CON SEGURO)
 DKR FLACHDICHTEND (BSP-GEWINDE, GESTIFTETE MUTTER)
 FEMMINA GAS SEDE PIANA (DADO SPINATO)

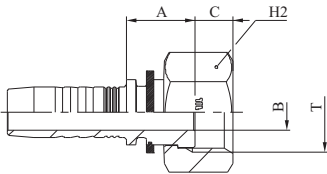

M20613

BSP FEMALE FLAT SEAT (SLIP-ON NUT)
 HEMBRA BSP CARA PLANA (TUERCA LIBRE)
 DKR FLACHDICHTEND (BSP-GEWINDE, HINTERLEGTE MUTTER)
 FEMMINA GAS SEDE PIANA (DADO PASSANTE)

PART. REF.	HOSE BORE			THREAD	DIMENSIONS mm				
	DN	inch	Size		T	B	A	C	H ₂
M20613-04-04	6	1/4"	- 04	1/4" - 19	4,0	14,5	7,9		19
M20613-05-06	8	5/16"	- 05	3/8" - 19	7,0	16,0	9,0		22
M20613-06-06	10	3/8"	- 06	3/8" - 19	7,0	16,6	9,0		22
M20613-06-08	10	3/8"	- 06	1/2" - 14	9,3	17,5	9,8		27
M20613-08-08	12	1/2"	08	1/2" - 14	9,3	17,9	9,8		27
M20612-08-12	12	1/2"	- 08	3/4" - 14	15,0	20,9	11,5		32
M20612-10-12	16	5/8"	- 10	3/4" - 14	15,0	20,7	11,5		32
M20612-12-12	19	3/4"	- 12	3/4" - 14	15,0	22,0	11,5		32
M20612-12-16	19	3/4"	- 12	1" - 11	19,8	23,5	13,0		38
M20612-16-16	25	1"	- 16	1" - 11	19,8	24,8	13,0		38

SAE STANDARD CONNECTIONS

M12510

JIC MALE 37° CONE - SAE J516 / ISO 12151-5

MACHO JIC ASIENTO A 37° - SAE J516 / ISO 12151-5

AGJ 37° AUSSENKONUS (UNF-GEWINDE NACH SAE J516 / ISO 12151-5)

MASCHIO JIC CONO 37° - SAE J516 / ISO 12151-5

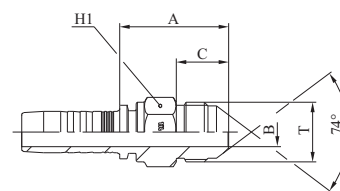

PART. REF.	HOSE BORE			THREAD	DIMENSIONS mm				
	DN	inch	Size		T	B	A	C	H ₁
M12510-04-04	6	1/4"	- 04	7/16" - 20	4,0	28,0	14,0		12
M12510-04-05	6	1/4"	- 04	1/2" - 20	5,5	29,0	14,0		14
M12510-04-06	6	1/4"	- 04	9/16" - 18	7,0	29,0	14,0		17
M12510-05-04	8	5/16"	- 05	7/16" - 20	4,0	29,0	14,0		14
M12510-05-05	8	5/16"	- 05	1/2" - 20	5,5	29,0	14,0		14
M12510-05-06	8	5/16"	- 05	9/16" - 18	7,0	29,0	14,0		17
M12510-06-05	10	3/8"	- 06	1/2" - 20	5,5	29,5	14,0		17
M12510-06-06	10	3/8"	- 06	9/16" - 18	7,0	29,6	14,0		17
M12510-06-08	10	3/8"	- 06	3/4" - 16	9,3	34,1	16,5		19
M12510-06-10	10	3/8"	- 06	7/8" - 14	12,5	38,6	19,5		24
M12510-08-06	12	1/2"	- 08	9/16" - 18	7,0	32,0	14,0		19
M12510-08-08	12	1/2"	- 08	3/4" - 16	9,3	34,4	16,5		19
M12510-08-10	12	1/2"	- 08	7/8" - 14	12,5	38,9	19,5		24
M12510-08-12	12	1/2"	- 08	1.1/16" - 12	15,0	42,9	22,0		27
M12510-10-10	16	5/8"	- 10	7/8" - 14	12,5	39,2	19,5		24
M12510-10-12	16	5/8"	- 10	1.1/16" - 12	15,0	42,7	22,0		27
M12510-12-10	19	3/4"	- 12	7/8" - 14	12,5	41,5	19,5		27
M12510-12-12	19	3/4"	- 12	1.1/16" - 12	15,0	44,0	22,0		27
M12510-12-14	19	3/4"	- 12	1.3/16" - 12	16,0	44,5	22,5		32
M12510-12-16	19	3/4"	- 12	1.5/16" - 12	19,8	47,0	23,0		34
M12510-16-12	25	1"	- 16	1.1/16" - 12	15,0	44,8	22,0		32
M12510-16-16	25	1"	- 16	1.5/16" - 12	19,8	47,8	23,0		34
M12510-16-20	25	1"	- 16	1.5/8" - 12	26,0	52,8	24,3		42
M12510-20-20	31	1.1/4"	- 20	1.5/8" - 12	26,0	53,5	24,3		42
M12510-20-24	31	1.1/4"	- 20	1.7/8" - 12	32,0	60,5	27,5		50
M12510-24-24	38	1.1/2"	- 24	1.7/8" - 12	32,0	60,5	27,5		50
M12510-32-32	51	2"	- 32	2.1/2" - 12	42,0	71,8	34,0		65

M22512

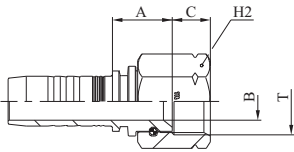

JIC FEMALE 37° CONE SEAT - SAE J516 / ISO 12151-5 (THRUST-WIRE NUT)
 HEMBRA JIC ASIENTO A 37° - SAE J516 / ISO 12151-5 (TUERCA CON SEGURO)
 DKJ 37° DICHTKOPF (UNF-GEWINDE NACH SAE J516 / ISO 12151-5, GESTIFTETE MUTTER)
 FEMMINA JIC CONO 37° - SAE J516 / ISO 12151-5 (DADO SPINATO)

M22513

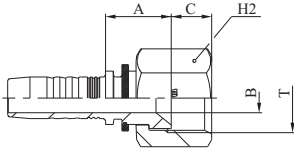

JIC FEMALE 37° CONE SEAT - SAE J516 / ISO 12151-5 (SLIP-ON NUT)
 HEMBRA JIC ASIENTO A 37° - SAE J516 / ISO 12151-5 (TUERCA LIBRE)
 DKJ 37° DICHTKOPF (UNF-GEWINDE NACH SAE J516 / ISO 12151-5, HINTERLEGTE MUTTER)
 FEMMINA JIC CONO 37° - SAE J516 / ISO 12151-5 (DADO PASSANTE)

PART. REF.	HOSE BORE			THREAD	DIMENSIONS mm				
------------	-----------	--	--	--------	------------------	--	--	--	--

	DN	inch	Size	T	B	A	C		H ₂
M22513-03-04	5	3/16"	- 03	7/16" - 20	3,0	15,1	9,0		15
M22512-03-05	5	3/16"	- 03	1/2" - 20	4,0	15,5	9,2		17
M22512-04-04	6	1/4"	- 04	7/16" - 20	4,0	15,5	8,2		17
M22512-04-05	6	1/4"	- 04	1/2" - 20	4,0	15,8	9,2		17
M22513-04-06	6	1/4"	- 04	9/16" - 18	4,0	16,5	9,8		19
M22512-05-04	8	5/16"	- 05	7/16" - 20	4,0	15,5	8,2		17
M22512-05-05	8	5/16"	- 05	1/2" - 20	5,5	16,0	9,2		17
M22512-05-06	8	5/16"	- 05	9/16" - 18	7,0	15,7	9,7		19
M22513-05-08	8	5/16"	- 05	3/4" - 16	5,5	16,7	10,7		22
M22512-06-05	10	3/8"	- 06	1/2" - 20	5,5	16,6	9,5		17
M22512-06-06	10	3/8"	- 06	9/16" - 18	7,0	16,1	9,2		19
M22513-06-08	10	3/8"	- 06	3/4" - 16	7,0	17,3	10,7		22
M22513-06-10	10	3/8"	- 06	7/8" - 14	9,3	18,1	12,4		27
M22512-08-08	12	1/2"	- 08	3/4" - 16	9,3	19,9	10,2		22
M22513-08-10	12	1/2"	- 08	7/8" - 14	9,3	18,5	12,4		27
M22513-08-12	12	1/2"	- 08	1.1/16" - 12	12,5	21,8	13,8		32
M22512-10-10	16	5/8"	- 10	7/8" - 14	12,5	19,9	12,3		27
M22513-10-12	16	5/8"	- 10	1.1/16" - 12	12,5	21,7	13,8		32
M22512-12-08	19	3/4"	- 12	3/4" - 16	9,3	21,5	10,2		22
M22512-12-10	19	3/4"	- 12	7/8" - 14	12,5	21,5	12,3		27
M22512-12-12	19	3/4"	- 12	1.1/16" - 12	15,0	22,5	14,2		32
M22512-12-14	19	3/4"	- 12	1.3/16" - 12	15,0	23,1	14,8		36
M22512-12-16	19	3/4"	- 12	1.5/16" - 12	19,8	23,0	15,2		38
M22512-16-12	25	1"	- 16	1.1/16" - 12	15,0	23,3	14,4		32
M22512-16-16	25	1"	- 16	1.5/16" - 12	19,8	23,8	15,2		38
M22512-16-20	25	1"	- 16	1.5/8" - 12	26,0	29,8	16,2		50
M22512-20-20	31	1.1/4"	- 20	1.5/8" - 12	26,0	30,0	16,2		50
M22512-20-24	31	1.1/4"	- 20	1.7/8" - 12	32,0	35,0	18,8		60
M22512-24-24	38	1.1/2"	- 24	1.7/8" - 12	32,0	35,0	18,8		60
M22512-32-24	51	2"	- 32	1.7/8" - 12	32,0	37,0	18,8		60
M22512-32-32	51	2"	- 32	2.1/2" - 12	44,0	35,4	24,0		75

SAE STANDARD CONNECTIONS

M22711

JIC FEMALE 37° CONE SEAT DOUBLE HEXAGON - SAE J516 / ISO 12151-5 (CRIMPED-BACK NUT)
 HEMBRA JIC ASIENTO A 37° DOBLE TUERCA - SAE J516 / ISO 12151-5 (TUERCA PRENSADA)
 DKJ 37° MIT KONTERSECHSKANT (UNF GEWINDE NACH SAE J516 / ISO 12151-5, VORGEKRIMPTE MUTTER)
 FEMMINA JIC CONO 37° DOPPIO ESAGONO SAE J516 / ISO 12151-5 (DADO PRESSATO)

M22711K

JIC FEMALE 37° CONE SEAT DOUBLE HEXAGON - SAE J516 / ISO 12151-5 (CRIMPED-BACK COMPACT NUT)
 HEMBRA JIC ASIENTO A 37° DOBLE TUERCA
 SAE J516 / ISO 12151-5 (TUERCA TIPO COMPACTO PRENSADA)
 DKJ (KOMPAKT) 37° MIT KONTERSECHSKANT
 (UNF GEWINDE NACH SAE J516 / ISO 12151-5, VORGEKRIMPTE MUTTER)
 FEMMINA JIC CONO 37° DOPPIO ESAGONO
 SAE J516 / ISO 12151-5 (DADO PRESSATO COMPATTO)

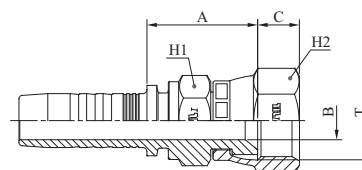

PART. REF.	HOSE BORE		THREAD	DIMENSIONS mm						
	DN	inch		T	B	A	C	H ₁	H ₂	
M22711-03-04K	5	3/16"	- 03	7/16" - 20	4,0	20	9	12	15	
M22711-04-04K	6	1/4"	- 04	7/16" - 20	4,0	20,5	9	12	15	
M22711-04-06K	6	1/4"	- 04	9/16" - 18	7,0	21,6	9,5	14	17	
M22711-06-06K	10	3/8"	- 06	9/16" - 18	7,0	22,1	9,5	17	17	
M22711-06-08	10	3/8"	- 06	3/4" - 16	9,3	21,7	10,7	19	22	
M22711-08-08	12	1/2"	- 08	3/4" - 16	9,3	26,9	10,7	19	22	
M22711-08-10K	12	1/2"	- 08	7/8" - 14	9,3	29,6	12,5	22	25	
M22711-10-10K	16	5/8"	- 10	7/8" - 14	9,3	29,5	12,5	22	25	
M22711-12-12	19	3/4"	- 12	1.1/16" - 12	15	30,1	14,1	27	32	
M22711-16-16	25	1"	- 16	1.5/16" - 12	19,8	35,5	15,3	32	38	
M22711-20-20	31	1.1/4"	- 20	1.5/8" - 12	26,0	42,0	16,1	41	50	
M22711-24-24	38	1.1/2"	- 24	1.7/8" - 12	32,0	46,5	18,6	50	60	
M22711-32-32	51	2"	- 32	2.1/2" - 12	42,0	50,5	23,5	65	75	

M22712K

JIC FEMALE 37° CONE SEAT DOUBLE HEXAGON - SAE J516 / ISO 12151-5 (THRUST-WIRE COMPACT NUT)

HEMBRA JIC ASIENTO A 37° DOBLE TUERCA

SAE J516 / ISO 12151-5 (TUERCA TIPO COMPACTO CON SEGURO)

DKJ KOMPAKT 37° DK MIT KONTERSECHSKANT

(UNF-GEWINDE NACH SAE J516 / ISO 12151-5, GESTIFTETE MUTTER)

FEMMINA JIC CONO 37° DOPPIO ESAGONO

SAE J516 / ISO 12151-5 (DADO SPINATO COMPATTO)

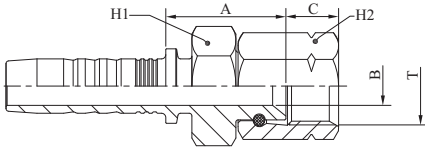

PART. REF.	HOSE BORE			THREAD	DIMENSIONS mm					
	DN	inch	Size		T	B	A	C	H ₁	H ₂
M22712-03-04K	5	3/16"	- 03	7/16" - 20	4,0	20,5	8,2		12	15
M22712-04-04K	6	1/4"	- 04	7/16" - 20	4,0	21,0	8,2		12	15
M22712-04-06K	6	1/4"	- 04	9/16" - 18	7,0	24,1	9,2		14	17
M22712-06-06K	10	3/8"	- 06	9/16" - 18	7,0	24,6	9,2		17	17
M22712-08-10K	12	1/2"	- 08	7/8" - 14	12,5	28,4	12,6		22	25
M22712-10-10K	16	5/8"	- 10	7/8" - 14	12,5	29,0	12,6		22	25

SAE STANDARD CONNECTIONS

M22712

JIC FEMALE 37° CONE SEAT DOUBLE HEXAGON SAE J516 / ISO 12151-5 (THRUST-WIRE NUT)

HEMBRA JIC ASIENTO A 37° DOBLE TUERCA SAE J516 / ISO 12151-5 (TUERCA CON SEGURO)

DKJ 37° DK MIT KONTERSECHSKANT

(UNF-GEWINDE NACH SAE J516 / ISO 12151-5, GESTIFTETE MUTTER)

FEMMINA JIC CONO 37° DOPPIO ESAGONO

SAE J516 / ISO 12151-5 (DADO SPINATO)

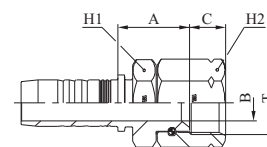

PART. REF.	HOSE BORE			THREAD	DIMENSIONS mm					
	DN	inch	Size		T	B	A	C	H ₁	H ₂
M22712-03-04	5	3/16"	- 03	7/16" - 20	4,0	20,5	8,2		12	17
M22712-04-04	6	1/4"	- 04	7/16" - 20	4,0	21,0	8,2		12	17
M22712-04-05	6	1/4"	- 04	1/2" - 20	4,0	21,5	9,2		12	17
M22712-04-06	6	1/4"	- 04	9/16" - 18	7,0	24,1	9,2		14	19
M22712-05-05	8	5/16"	- 05	1/2" - 20	5,5	21,5	9,2		14	17
M22712-05-06	8	5/16"	- 05	9/16" - 18	7,0	24,1	9,2		14	19
M22712-05-08	8	5/16"	- 05	3/4" - 16	9,3	26,0	10,6		19	22
M22712-06-04	10	3/8"	- 06	7/16" - 20	4,0	24,5	8,2		17	17
M22712-06-05	10	3/8"	- 06	1/2" - 20	5,5	25,0	9,2		17	17
M22712-06-06	10	3/8"	- 06	9/16" - 18	7,0	24,6	9,2		17	19
M22712-06-08	10	3/8"	- 06	3/4" - 16	9,3	27,1	10,2		19	22
M22712-06-10	10	3/8"	- 06	7/8" - 14	12,5	28,0	12,3		22	27
M22712-08-06	12	1/2"	- 08	9/16" - 18	7,0	24,7	9,2		19	19
M22712-08-08	12	1/2"	- 08	3/4" - 16	9,3	27,4	10,2		19	22
M22712-08-10	12	1/2"	- 08	7/8" - 14	12,5	28,4	12,3		22	27
M22712-08-12	12	1/2"	- 08	1.1/16" - 12	14,0	30,0	14,2		27	32
M22712-10-08	16	5/8"	- 10	3/4" - 16	9,3	28,5	10,2		22	22
M22712-10-10	16	5/8"	- 10	7/8" - 14	12,5	29,0	12,3		22	27
M22712-10-12	16	5/8"	- 10	1.1/16" - 12	15,0	29,5	14,2		27	32
M22712-12-08	19	3/4"	- 12	3/4" - 16	9,3	30,0	10,2		27	22
M22712-12-10	19	3/4"	- 12	7/8" - 14	12,5	30,0	12,3		27	27
M22712-12-12	19	3/4"	- 12	1.1/16" - 12	15,0	31,5	14,2		27	32
M22712-12-14	19	3/4"	- 12	1.3/16" - 12	15,0	33,0	14,8		30	36
M22712-12-16	19	3/4"	- 12	1.5/16" - 12	19,8	32,5	15,2		32	38
M22712-16-12	25	1"	- 16	1.1/16" - 12	12,5	33,8	14,2		32	32
M22712-16-16	25	1"	- 16	1.5/16" - 12	19,8	34,3	15,2		32	38
M22712-16-20	25	1"	- 16	1.5/8" - 12	26,0	42,8	16,2		41	50
M22712-20-16	31	1.1/4"	- 20	1.5/16" - 12	19,8	36,0	15,2		38	38
M22712-20-20	31	1.1/4"	- 20	1.5/8" - 12	26,0	43,5	16,2		41	50
M22712-24-24	38	1.1/2"	- 24	1.7/8" - 12	32,0	51,0	18,8		50	60
M22712-32-32	51	2"	- 32	2.1/2" - 12	42,0	55,5	24,0		65	75

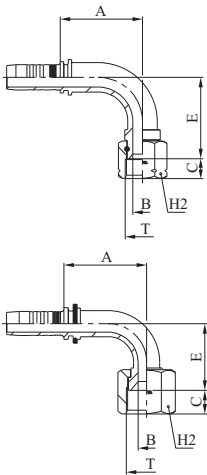

M22592

90° JIC FEMALE SWEPT ELBOW 37° CONE SEAT - SAE J516 / ISO 12151-5 (THRUST-WIRE NUT)
 HEMBRA JIC CODO DE 90° ASIENTO A 37° - SAE J516 / ISO 12151-5 (TUERCA CON SEGURO)
 DKJ 90° BOGEN 37° DICHTKOPF (UNF-GEWINDE NACH SAE J516 / ISO 12151-5, GESTIFTETE MUTTER)
 FEMMINA JIC 90° CONO 37° SAE J516 / ISO 12151-5 (DADO SPINATO)

M22593

90° JIC FEMALE SWEPT ELBOW 37° CONE SEAT - SAE J516 / ISO 12151-5 (SLIP-ON NUT)
 HEMBRA JIC CODO DE 90° ASIENTO A 37° - SAE J516 / ISO 12151-5 (TUERCA LIBRE)
 DKJ 90° BOGEN 37° DICHTKOPF (UNF-GEWINDE NACH SAE J516 / ISO 12151-5, HINTERLEGTE MUTTER)
 FEMMINA JIC 90° CONO 37° SAE J516 / ISO 12151-5 (DADO PASSANTE)

PART. REF.	HOSE BORE			THREAD	DIMENSIONS mm					
	DN	inch	Size		T	B	A	C	E	H ₂

	DN	inch	Size	T	B	A	C	E	H ₂
M22593-03-04	5	3/16"	- 03	7/16" - 20	3,0	26,0	9,0	23,5	15
M22592-04-04	6	1/4"	- 04	7/16" - 20	4,0	28,5	8,2	27,0	17
M22592-04-05	6	1/4"	- 04	1/2" - 20	4,0	28,5	9,2	27,5	17
M22593-04-06	6	1/4"	- 04	9/16" - 18	4,0	29,5	9,8	28,0	19
M22593-04-08	6	1/4"	- 04	3/4" - 16	7,0	29,3	11,0	30,5	22
M22592-05-05	8	5/16"	- 05	1/2" - 20	5,5	29,5	9,2	27,5	17
M22592-05-06	8	5/16"	- 05	9/16" - 18	7,0	31,0	9,2	28,5	19
M22592-06-05	10	3/8"	- 06	1/2" - 20	5,5	30,1	9,5	26,5	17
M22592-06-06	10	3/8"	- 06	9/16" - 18	7,0	35,5	9,2	32,5	19
M22593-06-08	10	3/8"	- 06	3/4" - 16	7,0	36,5	10,7	29,5	22
M22593-06-10	10	3/8"	- 06	7/8" - 14	9,3	36,5	12,4	31,5	27
M22592-08-06	12	1/2"	- 08	9/16" - 18	7,0	37,0	9,2	33,0	19
M22592-08-08	12	1/2"	- 08	3/4" - 16	9,3	44,0	10,2	41,0	22
M22593-08-10	12	1/2"	- 08	7/8" - 14	9,3	45,0	12,4	36,0	27
M22593-08-12	12	1/2"	- 08	1.1/16" - 12	12,5	45,0	13,8	36,0	32
M22592-10-10	16	5/8"	- 10	7/8" - 14	12,5	53,5	12,3	52,5	27
M22593-10-12	16	5/8"	- 10	1.1/16" - 12	12,5	51,5	13,8	50,0	32
M22592-12-10	19	3/4"	- 12	7/8" - 14	12,5	55,0	12,3	52,5	27
M22592-12-12	19	3/4"	- 12	1.1/16" - 12	15,0	62,0	14,2	58,0	32
M22592-12-14	19	3/4"	- 12	1.3/16" - 12	15,0	62,0	14,8	58,0	36
M22592-12-16	19	3/4"	- 12	1.5/16" - 12	19,8	62,0	15,2	57,5	38
M22592-16-16	25	1"	- 16	1.5/16" - 12	19,8	77,0	15,2	67,0	38
M22592-16-20	25	1"	- 16	1.5/8" - 12	26,0	77,5	16,2	74,5	50
M22592-20-20	31	1.1/4"	- 20	1.5/8" - 12	26,0	90,5	16,2	86,5	50
M22592-20-24	31	1.1/4"	- 20	1.7/8" - 12	32,0	90,5	18,8	91,0	60
M22592-24-24	38	1.1/2"	- 24	1.7/8" - 12	32,0	108,0	18,8	100,5	60
M22592-32-32	51	2"	- 32	2.1/2" - 12	44,0	142,0	24,0	137,0	75

SAE STANDARD CONNECTIONS

M24792

90° JIC FEMALE LONG DROP ELBOW 37° CONE SEAT - SAE J516 / ISO 12151-5 (THRUST-WIRE NUT)
 HEMBRA JIC CODO LARGO DE 90° ASIENTO A 37° - SAE J516 / ISO 12151-5 (TUERCA CON SEGURO)
 DKJ 90° BOGEN 37° DICHTKOPF (UNF-GEWINDE NACH SAE J516 / ISO 12151-5, GESTIFTETE MUTTER)
 FEMMINA JIC 90° CONO 37° CURVA LUNGA - SAE J516 / ISO 12151-5 (DADO SPINATO)

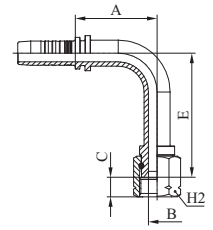

M24793

90° JIC FEMALE LONG DROP ELBOW 37° CONE SEAT - SAE J516 / ISO 12151-5 (SLIP-ON NUT)
 HEMBRA JIC CODO LARGO DE 90° ASIENTO A 37° - SAE J516 / ISO 12151-5 (TUERCA LIBRE)
 DKJ 90° BOGEN 37° DICHTKOPF (UNF-GEWINDE NACH SAE J516 / ISO 12151-5, HINTERLEGTE MUTTER)
 FEMMINA JIC 90° CONO 37° CURVA LUNGA - SAE J516 / ISO 12151-5 (DADO PASSANTE)

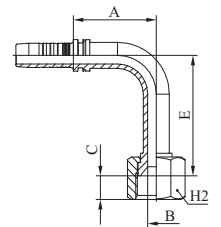

PART. REF.	HOSE BORE			THREAD	DIMENSIONS mm					
	DN	inch	Size		T	B	A	C	E	H ₂
M24792-04-04	6	1/4"	- 04	7/16" - 20	4,0	28,5	8,2	45,0		17
M24792-04-05	6	1/4"	- 04	1/2" - 20	4,0	28,5	9,2	45,0		17
M24793-04-06	6	1/4"	- 04	9/16" - 18	4,0	29,5	9,8	55,5		19
M24792-06-06	10	3/8"	- 06	9/16" - 18	7,0	35,5	9,2	55,0		19
M24793-06-08	10	3/8"	- 06	3/4" - 16	7,0	36,5	10,7	61,5		22
M24792-08-08	12	1/2"	- 08	3/4" - 16	9,4	40,6	10,3	61,5		22
M24793-08-10	12	1/2"	- 08	7/8" - 14	9,4	45,0	12,4	65,0		27
M24792-10-10	16	5/8"	- 10	7/8" - 14	12,5	53,5	12,3	65,5		27
M24792-12-12	19	3/4"	- 12	1.1/16" - 12	15,0	62,0	14,2	94,5		32
M24792-16-16	25	1"	- 16	1.5/16" - 12	19,8	77,0	15,2	110,0		38

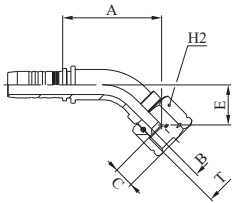

M22542

45° JIC FEMALE SWEPT ELBOW 37° CONE SEAT - SAE J516 / ISO 12151-5 (THRUST-WIRE NUT)
 HEMBRA JIC CODO DE 45° ASIENTO A 37° - SAE J516 / ISO 12151-5 (TUERCA CON SEGURO)
 DKJ 45° BOGEN 37° DICHTKOPF (UNF-GEWINDE NACH SAE J516 / ISO 12151-5, GESTIFTETE MUTTER)
 FEMMINA JIC 45° CONO 37° - SAE J516 / ISO 12151-5 (DADO SPINATO)

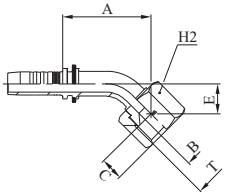

M22543

45° JIC FEMALE SWEPT ELBOW 37° CONE SEAT - SAE J516 / ISO 12151-5 (SLIP-ON NUT)
 HEMBRA JIC CODO DE 45° ASIENTO A 37° - SAE J516 / ISO 12151-5 (TUERCA LIBRE)
 DKJ 45° BOGEN 37° DICHTKOPF (UND-GEWINDE NACH SAE J516 / ISO 12151-5, HINTERLEGTE MUTTER)
 FEMMINA JIC 45° CONO 37° - SAE J516 / ISO 12151-5 (DADO PASSANTE)

PART. REF.	HOSE BORE			THREAD	DIMENSIONS mm				
	DN	inch	Size		T	B	A	C	E

PART. REF.	HOSE BORE			THREAD	DIMENSIONS mm					
	DN	inch	Size		T	B	A	C	E	H ₂
M22542-03-04	5	3/16"	- 03	7/16" - 20	4,0	35,0	8,2	14,5		17
M22542-04-04	6	1/4"	- 04	7/16" - 20	4,0	35,5	8,2	14,5		17
M22542-04-05	6	1/4"	- 04	1/2" - 20	4,0	35,7	9,2	14,5		17
M22543-04-06	6	1/4"	- 04	9/16" - 18	4,0	35,5	9,8	14,0		19
M22542-05-05	8	5/16"	- 05	1/2" - 20	5,5	37,5	9,2	14,5		17
M22542-05-06	8	5/16"	- 05	9/16" - 18	7,0	38,0	9,2	14,5		19
M22542-06-06	10	3/8"	- 06	9/16" - 18	7,0	42,0	9,2	16,5		19
M22543-06-08	10	3/8"	- 06	3/4" - 16	7,0	41,0	10,7	14,0		22
M22543-06-10	10	3/8"	- 06	7/8" - 14	9,3	42,5	12,4	15,5		27
M22542-08-08	12	1/2"	- 08	3/4" - 16	9,3	52,0	10,2	20,0		22
M22543-08-10	12	1/2"	- 08	7/8" - 14	9,3	49,5	12,4	17,0		27
M22543-08-12	12	1/2"	- 08	1.1/16" - 12	12,5	50,0	13,8	17,0		32
M22542-10-10	16	5/8"	- 10	7/8" - 14	12,5	62,0	12,3	25,5		27
M22543-10-12	16	5/8"	- 10	1.1/16" - 12	12,5	60,0	13,8	24,0		32
M22542-12-12	19	3/4"	- 12	1.1/16" - 12	15,0	70,0	14,2	27,5		32
M22542-12-14	19	3/4"	- 12	1.3/16" - 12	15,0	69,0	14,8	27,5		36
M22542-12-16	19	3/4"	- 12	1.5/16" - 12	19,8	70,0	15,2	27,5		38
M22542-16-12	25	1"	- 16	1.1/16" - 12	15,0	72,5	14,2	27,5		32
M22542-16-16	25	1"	- 16	1.5/16" - 12	19,8	86,0	15,2	32,0		38
M22542-16-20	25	1"	- 16	1.5/8" - 12	26,0	90,0	16,2	36,0		50
M22542-20-20	31	1.1/4"	- 20	1.5/8" - 12	26,0	103,5	16,2	41,5		50
M22542-20-24	31	1.1/4"	- 20	1.7/8" - 12	32,0	106,5	18,8	44,5		60
M22542-24-24	38	1.1/2"	- 24	1.7/8" - 12	32,0	119,0	18,8	46,5		60
M22542-32-32	51	2"	- 32	2.1/2" - 12	44,0	163,0	24,0	68,0		75

SAE STANDARD CONNECTIONS

M22582F

90° JIC FEMALE COMPACT ELBOW 37° CONE SEAT
 SAE J516 / ISO 12151-5 (THRUST-WIRE NUT)
 HEMBRA JIC CODO COMPACTO DE 90° ASIENTO A 37°
 SAE J516 / ISO 12151-5 (TUERCA CON SEGURO)
 DKJ 90° KOMPAKT BOGEN 37° DICHTKOPF
 (UNF-GEWINDE NACH SAE J516 / ISO 12151-5, GESTIFTETE MUTTER)
 FEMMINA JIC 90° TIPO COMPATTO CONO 37°
 SAE J516 / ISO 12151-5 (DADO SPINATO)

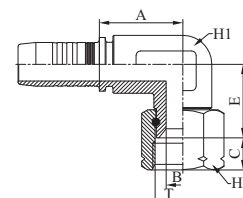

PART. REF.	HOSE BORE			THREAD	DIMENSIONS mm					
	DN	inch	Size		T	B	A	C	E	H ₁
M22582-04-04F	6	1/4"	- 04	7/16" - 20	4,0	20,0	8,2	20,5	14	17
M22582-04-06F	6	1/4"	- 04	9/16" - 18	7,0	20,0	9,2	21,5	14	19
M22582-06-06F	10	3/8"	- 06	9/16" - 18	7,0	23,1	9,2	24,0	19	19
M22582-06-08F	10	3/8"	- 06	3/4" - 16	9,3	26,6	10,2	28,0	22	22
M22582-08-08F	12	1/2"	- 08	3/4" - 16	9,3	24,9	10,2	28,0	22	22
M22582-08-10F	12	1/2"	- 08	7/8" - 14	12,5	24,9	12,3	29,0	22	27
M22582-12-12F	19	3/4"	- 12	1.1/16" - 12	15,0	37,5	14,2	33,0	27	32
M22582-16-16F	25	1"	- 16	1.5/16" - 12	20,0	51,8	15,2	40,0	36	38

M12410

ORFS MALE - SAE J516 / ISO 12151-1
 MACHO ORFS - SAE J516 / ISO 12151-1
 ORFS AUSSERGEWINDE NACH SAE J516 / ISO 12151-1
 MASCHIO ORFS - SAE J516 / ISO 12151-1

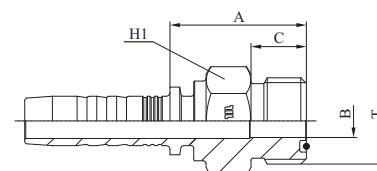

PART. REF.	HOSE BORE			THREAD	DIMENSIONS mm					
	DN	inch	Size		T	B	A	C	H ₁	
M12410-04-04	6	1/4"	- 04	9/16" - 18	4,0	24,0	9,8		16	
M12410-04-06	6	1/4"	- 04	11/16" - 16	6,7	26,6	11,2		19	
M12410-05-06	8	5/16"	- 05	11/16" - 16	6,7	27,0	11,2		19	
M12410-06-06	10	3/8"	- 06	11/16" - 16	6,7	27,6	11,2		19	
M12410-06-08	10	3/8"	- 06	13/16" - 16	9,3	30,0	12,8		22	
M12410-08-08	12	1/2"	- 08	13/16" - 16	9,3	30,6	12,8		22	
M12410-08-10	12	1/2"	- 08	1" - 14	12,5	35,0	15,5		27	
M12410-08-12	12	1/2"	- 08	1.3/16" - 12	15,0	37,5	17,0		32	
M12410-10-08	16	5/8"	- 10	13/16" - 16	9,3	30,5	12,8		22	
M12410-10-10	16	5/8"	- 10	1" - 14	12,5	34,7	15,5		27	
M12410-10-12	16	5/8"	- 10	1.3/16" - 12	15,0	37,5	17,0		32	
M12410-12-12	19	3/4"	- 12	1.3/16" - 12	15,0	39,0	17,0		32	
M12410-12-16	19	3/4"	- 12	1.7/16" - 12	19,8	40,5	17,5		38	
M12410-16-16	25	1"	- 16	1.7/16" - 12	19,8	41,8	17,5		38	
M12410-16-20	25	1"	- 16	1.11/16" - 12	26,0	44,0	17,5		46	
M12410-20-20	31	1.1/4"	- 20	1.11/16" - 12	26,0	46,3	17,5		46	
M12410-24-24	38	1.1/2"	- 24	2" - 12	32,0	48,6	17,5		55	

M22411

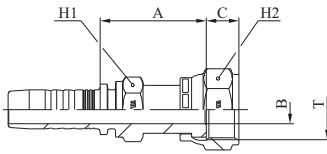

ORFS FEMALE - SAE J516 / ISO 12151-1 PULLBACK TYPE (CRIMPED BACK-NUT)
 HEMBRA ORFS - SAE J516 / ISO 12151-1 CUELLO LARGO (TUERCA PRENSADA)
 ORFS IG - SAE J516 / ISO 12151-1 RÜCKZUGSAUSFÜHRUNG (VERPRESSTE MUTTER)
 FEMMINA ORFS - SAE J516 / ISO 12151-1 VERSIONE RETRAIBILE (DADO PRESSATO)

PART. REF.	HOSE BORE			THREAD	DIMENSIONS mm					
	DN	inch	Size		T	B	A	C	H ₁	H ₂
M22411-04-04	6	1/4"	- 04	9/16" - 18	4,0	27,5	8,0		13	19
M22411-04-06	6	1/4"	- 04	11/16" - 16	7,0	30,0	9,5		16	22
M22411-04-08	6	1/4"	- 04	13/16" - 16	9,3	34,5	11,0		19	24
M22411-05-04	8	5/16"	- 05	9/16" - 18	4,0	28,5	8,0		16	19
M22411-05-06	8	5/16"	- 05	11/16" - 16	7,0	30,5	9,5		16	22
M22411-06-04	10	3/8"	- 06	9/16" - 18	4,0	29,0	8,0		16	19
M22411-06-06	10	3/8"	- 06	11/16" - 16	7,0	31,1	9,5		16	22
M22411-06-08	10	3/8"	- 06	13/16" - 16	9,3	35,6	11,0		19	24
M22411-08-06	12	1/2"	- 08	11/16" - 16	7,0	31,9	9,5		19	22
M22411-08-08	12	1/2"	- 08	13/16" - 16	9,3	35,9	11,0		19	24
M22411-08-10	12	1/2"	- 08	1" - 14	11,5	38,4	13,5		24	30
M22411-08-12	12	1/2"	- 08	1.3/16" - 12	13,9	41,9	14,5		28	36
M22411-10-08	16	5/8"	- 10	13/16" - 16	9,3	36,0	11,0		24	24
M22411-10-10	16	5/8"	- 10	1" - 14	11,5	38,7	13,5		24	30
M22411-10-12	16	5/8"	- 10	1.3/16" - 12	13,9	42,0	14,5		28	36
M22411-12-10	19	3/4"	- 12	1" - 14	11,5	41,0	13,5		28	30
M22411-12-12	19	3/4"	- 12	1.3/16" - 12	13,9	43,5	14,5		28	36
M22411-12-16	19	3/4"	- 12	1.7/16" - 12	19,8	45,5	15,0		36	41
M22411-16-12	25	1"	- 16	1.3/16" - 12	13,9	45,8	14,5		36	36
M22411-16-16	25	1"	- 16	1.7/16" - 12	19,8	46,3	15,0		36	41
M22411-16-20	25	1"	- 16	1.11/16" - 12	26,0	49,5	14,8		41	50
M22411-20-20	31	1.1/4"	- 20	1.11/16" - 12	26,0	49,0	14,8		41	50
M22411-24-24	38	1.1/2"	- 24	2" - 12	32,0	54,0	15,8		50	60

SAE STANDARD CONNECTIONS

M27411

ORFS FEMALE - SAE J516 / ISO 12151-1 SHORT TYPE (CRIMPED BACK-NUT)
 HEMBRA ORFS - SAE J516 / ISO 12151-1 CUELLO CORTO (TUERCA PRENSADA)
 ORFS VERPRESSTE MUTTER - SAE J516 / ISO 12151-1
 KURZE AUSFÜHRUNG (CRIMPED BACK-NUT)
 FEMMINA ORFS - SAE J516 / ISO 12151-1 VERSIONE CORTA (DADO PRESSATO)

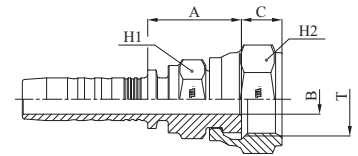

PART. REF.	HOSE BORE			THREAD	DIMENSIONS mm					
	DN	inch	Size		T	B	A	C	H ₁	H ₂
M27411-04-04	6	1/4"	- 04	9/16" - 18	4,0	20,5	8,0		13	19
M27411-04-06	6	1/4"	- 04	11/16" - 16	7,0	22,0	9,5		16	22
M27411-05-06	8	5/16"	- 05	11/16" - 16	7,0	25,5	9,5		16	22
M27411-06-06	10	3/8"	- 06	11/16" - 16	7,0	26,0	9,5		16	22
M27411-06-08	10	3/8"	- 06	13/16" - 16	9,3	25,0	11,0		19	24
M27411-08-08	12	1/2"	- 08	13/16" - 16	9,3	25,5	11,0		19	24
M27411-08-10	12	1/2"	- 08	1" - 14	11,5	26,5	13,5		24	30
M27411-08-12	12	1/2"	- 08	1.3/16" - 12	13,9	29,0	14,5		28	36
M27411-10-10	16	5/8"	- 10	1" - 14	11,5	26,5	13,5		24	30
M27411-10-12	16	5/8"	- 10	1.3/16" - 12	13,9	29,0	14,5		28	36
M27411-12-12	19	3/4"	- 12	1.3/16" - 12	13,9	30,5	14,5		28	36
M27411-16-16	25	1"	- 16	1.7/16" - 12	19,8	33,0	15,0		36	41

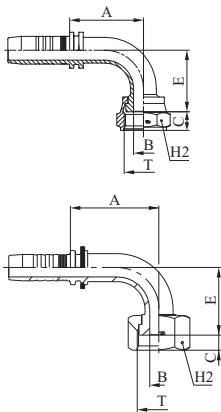

M22491

90° ORFS FEMALE SWEPT ELBOW - SAE J516 / ISO 12151-1 (CRIMPED BACK-NUT)
 HEMBRA ORFS CODO DE 90° - SAE J516 / ISO 12151-1 (TUERCA Prensada)
 DK 90° BOGEN ORFS (UNF-GEWINDE NACH SAE J516 / ISO 12151-1, PRESSMUTTER)
 FEMMINA ORFS 90° - SAE J516 / ISO 12151-1 (DADO PRESSATO)

M22493

90° ORFS FEMALE SWEPT ELBOW - SAE J516 / ISO 12151-1 (SLIP-ON NUT)
 HEMBRA ORFS CODO DE 90° - SAE J516 / ISO 12151-1 (TUERCA LIBRE)
 DK 90° BOGEN ORFS (UNF-GEWINDE NACH SAE J516 / ISO 12151-1, HINTERLEGTE MUTTER)
 FEMMINA ORFS 90° - SAE J516 / ISO 12151-1 (DADO PASSANTE)

PART. REF.	HOSE BORE			THREAD	DIMENSIONS mm					
	DN	inch	Size		T	B	A	C	E	H ₂

PART. REF.	HOSE BORE			THREAD	DIMENSIONS mm					
	DN	inch	Size		T	B	A	C	E	H ₂
M22493-04-04	6	1/4"	- 04	9/16" - 18	4,0	27,5	8,2	22,0		17
M22493-04-06	6	1/4"	- 04	11/16" - 16	7,0	27,5	9,5	22,0		22
M22493-05-06	8	5/16"	- 05	11/16" - 16	7,0	32,0	9,5	23,0		22
M22491-06-04	10	3/8"	- 06	9/16" - 18	4,0	28,0	8,0	23,0		19
M22493-06-06	10	3/8"	- 06	11/16" - 16	6,0	30,0	9,5	24,0		22
M22493-06-08	10	3/8"	- 06	13/16" - 16	9,3	30,0	11,0	26,5		24
M22491-08-06	12	1/2"	- 08	11/16" - 16	7,0	30,9	9,5	24,5		22
M22493-08-08	12	1/2"	- 08	13/16" - 16	9,3	40,5	11,0	30,0		24
M22493-08-10	12	1/2"	- 08	1" - 14	11,5	40,5	13,5	30,0		30
M22493-08-12	12	1/2"	- 08	1.3/16" - 12	13,9	39,5	14,5	37,5		36
M22491-10-08	16	5/8"	- 10	13/16" - 16	9,3	41,5	11,0	34,0		24
M22493-10-10	16	5/8"	- 10	1" - 14	11,5	48,0	13,5	37,5		30
M22493-10-12	16	5/8"	- 10	1.3/16" - 12	13,9	48,0	14,5	41,0		36
M22491-12-10	19	3/4"	- 12	1" - 14	11,5	49,0	13,5	38,0		30
M22493-12-12	19	3/4"	- 12	1.3/16" - 12	13,9	56,5	14,5	48,0		36
M22493-12-16	19	3/4"	- 12	1.7/16" - 12	19,8	56,5	14,8	47,5		41
M22491-16-12	25	1"	- 16	1.3/16" - 12	13,9	57,6	14,5	48,0		36
M22493-16-16	25	1"	- 16	1.7/16" - 12	19,8	71,5	14,8	56,0		41
M22493-16-20	25	1"	- 16	1.11/16" - 12	26,0	71,5	14,8	58,5		50
M22493-20-20	31	1.1/4"	- 20	1.11/16" - 12	26,0	83,0	14,8	66,0		50
M22493-24-24	38	1.1/2"	- 24	2" - 12	32,0	102,0	14,8	79,5		60

SAE STANDARD CONNECTIONS

M24493*

90° ORFS FEMALE LONG DROP ELBOW - SAE J516 / ISO 12151-1 (SLIP-ON NUT)

HEMBRA ORFS CODO DE 90° LARGO - SAE J516 / ISO 12151-1 (TUERCA LIBRE)

DK 90° BOGEN ORFS LANGE SCHENKEL (UNF-GEWINDE NACH SAE J516 / ISO 12151-1, HINTERLEGTE MUTTER)

FEMMINA ORFS A 90° CURVA LUNGA - SAE J516 / ISO 12151-1 (DADO PASSANTE)

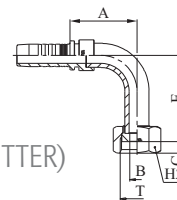

PART. REF.	HOSE BORE			THREAD	DIMENSIONS mm					
	DN	inch	Size		T	B	A	C	E	H ₂
M24493-04-04	6	1/4"	- 04	9/16" - 18	4,4	24,5	8,2	45,5		17
M24493-04-06	6	1/4"	- 04	11/16" - 16	7,0	24,5	9,5	53,5		22
M24493-06-06	10	3/8"	- 06	11/16" - 16	7,0	31,5	9,5	53,5		22
M24493-06-08	10	3/8"	- 06	13/16" - 16	6,7	32,0	11,0	53,5		24
M24493-08-08	12	1/2"	- 08	13/16" - 16	10,0	37,0	11,0	63,5		24
M24493-08-10	12	1/2"	- 08	1" - 14	9,6	37,0	13,5	64,0		30
M24493-10-10	16	1/2"	- 10	1" - 14	9,6	41,0	13,5	69,0		30
M24493-10-12	16	5/8"	- 10	1.3/16" - 12	12,7	41,0	14,5	73,0		36
M24493-12-12	19	5/8"	- 12	1.3/16" - 12	15,5	45,5	14,5	96,0		36
M24493-16-16	25	1"	- 16	1.7/16" - 12	20,6	58,5	14,8	113,5		41

* Brazed solution / Con soldadura / Lötäusführung / Con soldadura

M22441

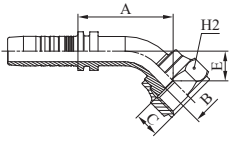

45° ORFS FEMALE SWEPT ELBOW - SAE J516 / ISO 12151-1 (CRIMPED-BACK NUT)
 HEMBRA ORFS CODO DE 45° - SAE J516 / ISO 12151-1 (TUERCA PRENSADA)
 DK 45° BOGEN ORFS (UNF-GEWINDE NACH SAE J516 / ISO 12151-1, PRESSMUTTER)
 FEMMINA ORFS 45° - SAE J516 / ISO 12151-1 (DADO PRESSATO)

M22443

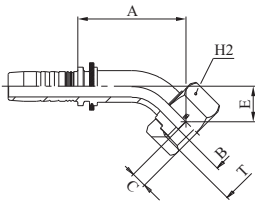

45° ORFS FEMALE SWEPT ELBOW - SAE J516 / ISO 12151-1 (SLIP-ON NUT)
 HEMBRA ORFS CODO DE 45° - SAE J516 / ISO 12151-1 (TUERCA LIBRE)
 DK 45° BOGEN ORFS (UNF-GEWINDE NACH SAE J516 / ISO 12151-1, HINTERLEGTE MUTTER)
 FEMMINA ORFS 45° - SAE J516 / ISO 12151-1 (DADO PASSANTE)

PART. REF.	HOSE BORE			THREAD	DIMENSIONS mm					
	DN	inch	Size		T	B	A	C	E	H ₂
M22443-04-04	6	1/4"	- 04	9/16" - 18	4,0	31,0	8,2	10,5		17
M22443-04-06	6	1/4"	- 04	11/16" - 16	7,0	31,0	9,5	10,5		22
M22443-05-06	8	5/16"	- 05	11/16" - 16	7,0	34,0	9,5	10,5		22
M22443-06-06	10	3/8"	- 06	11/16" - 16	7,0	32,5	9,5	11,0		22
M22443-06-08	10	3/8"	- 06	13/16" - 16	9,3	34,0	11,0	12,5		24
M22441-08-06	12	1/2"	- 08	11/16" - 16	7,0	33,0	9,5	11,0		22
M22443-08-08	12	1/2"	- 08	13/16" - 16	9,3	42,0	11,0	13,0		24
M22443-08-10	12	1/2"	- 08	1" - 14	11,5	42,0	13,5	13,5		30
M22443-08-12	12	1/2"	- 08	1.3/16" - 12	13,9	46,5	14,5	18,5		36
M22443-10-10	16	5/8"	- 10	1" - 14	11,5	49,0	13,5	16,0		30
M22443-10-12	16	5/8"	- 10	1.3/16" - 12	13,9	51,5	14,5	18,5		36
M22441-12-10	19	3/4"	- 12	1" - 14	11,5	50,5	13,5	16,5		30
M22443-12-12	19	3/4"	- 12	1.3/16" - 12	13,9	60,5	14,5	21,5		36
M22443-12-16	19	3/4"	- 12	1.7/16" - 12	19,8	61,0	14,8	21,0		41
M22441-16-12	25	1"	- 16	1.3/16" - 12	14,5	66,0	14,5	21,0		36
M22443-16-16	25	1"	- 16	1.7/16" - 12	19,8	72,0	14,8	23,5		41
M22443-16-20	25	1"	- 16	1.11/16" - 12	26,0	74,0	14,8	25,2		50
M22443-20-20	31	1.1/4"	- 20	1.11/16" - 12	26,0	82,0	14,8	27,0		50
M22443-24-24	38	1.1/2"	- 24	2" - 12	32,0	98,0	14,8	31,5		60

SAE STANDARD CONNECTIONS

M13010

SAE MALE O-RING BOSS TYPE - SAE J516 / ISO 11926

MACHO SAE CON O-RING TIPO BOSS - SAE J516 / ISO 11926

AGJO SAE O-RING (UNF-GEWINDE NACH SAE J516 / ISO 11926)

MASCHIO SAE O-RING - SAE J516 / ISO 11926

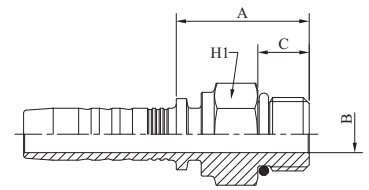

PART. REF.	HOSE BORE			THREAD	DIMENSIONS mm				
	DN	inch	Size		T	B	A	C	H ₁
M13010-04-04	6	1/4"	- 04	7/16" - 20	4,0	24,0	9,1	14	
M13010-04-06	6	1/4"	- 04	9/16" - 18	7,1	24,5	9,9	17	
M13010-06-06	10	3/8"	- 06	9/16" - 18	7,0	25,6	9,9	17	
M13010-06-08	10	3/8"	- 06	3/4" - 16	9,3	28,6	11,1	22	
M13010-06-10	10	3/8"	- 06	7/8" - 14	12,5	31,5	12,7	25	
M13010-08-08	12	1/2"	- 08	3/4" - 16	9,3	28,9	11,1	22	
M13010-08-10	12	1/2"	- 08	7/8" - 14	12,5	31,9	12,7	25	
M13010-08-12	12	1/2"	- 08	1.1/16" - 12	15,0	38,5	15,1	32	
M13010-10-10	16	5/8"	- 10	7/8" - 14	12,5	32,0	12,7	25	
M13010-10-12	16	5/8"	- 10	1.1/16" - 12	15,0	37,7	15,1	32	
M13010-12-12	19	3/4"	- 12	1.1/16" - 12	15,0	39,5	15,1	32	
M13010-12-16	19	3/4"	- 12	1.5/16" - 12	19,8	40,0	15,1	38	
M13010-16-16	25	1"	- 16	1.5/16" - 12	19,8	41,0	15,1	38	
M13010-20-20	31	1.1/4"	- 20	1.5/8" - 12	26,0	43,5	15,1	46	

M14310*

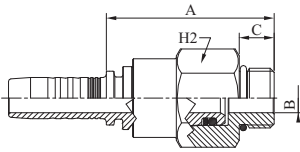

SAE SWIVEL MALE O-RING BOSS TYPE - SAE J516 / ISO 11926
 MACHO SAE GIRATORIO CON O-RING TIPO BOSS - SAE J516 / ISO 11926
 AGJO SAE O-RING DREHBAR (UNF-GEWINDE NACH SAE J516 / ISO 11926)
 MASCHIO SAE O-RING GIREVOLE - SAE J516 / ISO 11926

PART. REF.	HOSE BORE			THREAD	DIMENSIONS mm				
	DN	inch	Size		T	B	A	C	H ₂
M14310-04-04	6	1/4"	- 04	7/16" - 20	4,0	41,0	9,1		17
M14310-04-06	6	1/4"	- 04	9/16" - 18	7,0	44,0	9,9		22
M14310-06-06	10	3/8"	- 06	9/16" - 18	7,0	45,9	9,9		22
M14310-06-08	10	3/8"	- 06	3/4" - 16	7,0	47,8	11,1		22
M14310-08-08	12	1/2"	- 08	3/4" - 16	9,3	50,9	11,1		27
M14310-08-10	12	1/2"	- 08	7/8" - 14	9,3	42,2	13,0		27
M14310-08-12	12	1/2"	- 08	1.1/16" - 12	12,5	49,4	15,0		32
M14310-10-10	16	5/8"	- 10	7/8" - 14	9,3	41,4	13,0		27
M14310-12-12	19	3/4"	- 12	1.1/16" - 12	12,5	47,8	15,0		32

* Not to be used as a live swivel / No usar como una pieza giratoria viva / Nicht zu benutzen als Drehverschraubung / Da non usare come applicazione rotante

SAE STANDARD CONNECTIONS

M14390*

90° SAE SWIVEL MALE O-RING BOSS TYPE - SAE J516 / ISO 11926

MACHO SAE GIRATORIO CON O-RING CODO COMPACTO DE 90° TIPO BOSS - SAE J516 / ISO 11926

AGJO 90° KOMPAKT BOGEN DREHBAR MIT O-RING (UNF-GEWINDE NACH J516 / ISO 11926)

MASCHIO SAE O-RING GIREVOLE 90° - SAE J516 / ISO 11926

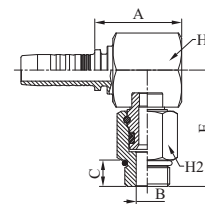

PART. REF.	HOSE BORE			THREAD	DIMENSIONS mm					
	DN	inch	Size		T	B	A	C	E	H ₁

M14390-06-06	10	3/8"	- 06	9/16" - 18	5,7	20,1	9,9	40,0	22	17
M14390-06-08	10	3/8"	- 06	3/4" - 16	7,0	20,1	11,1	44,4	22	22
M14390-08-08	12	1/2"	- 08	3/4" - 16	9,3	22,1	11,1	49,0	27	22
M14390-08-10	12	1/2"	- 08	7/8" - 14	9,3	27,5	13,0	47,5	27	27
M14390-10-10	16	5/8"	- 10	7/8" - 14	9,3	28,0	13,0	47,5	27	27
M14390-12-12	19	3/4"	- 12	1.1/16" - 12	12,5	27,5	15,0	55,5	32	32

* Brazed solution - Not to be used as a live swivel / Solución soldada - No usar como pieza giratoria viva / Lötanschluss - Nicht zu benutzen als Drehverschraubung / Con saldatura - Da non usare come applicazione rotante

M22612

SAE FEMALE 45° CONE SEAT - SAE J516/J512 (THRUST-WIRE NUT)

HEMBRA SAE ASIEN TO A 45° - SAE J516/J512 (TUERCA CON SEGURO)

DKJ DICHTKOPF GERADE 45° KONUS (UNF-GEWINDE NACH J516/J512, GESTIFTETE MUTTER)

FEMMINA SAE CONO 45° - SAE J516/J512 (DADO SPINATO)

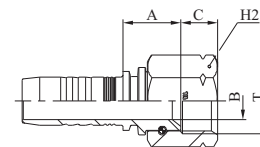

PART. REF.	HOSE BORE			THREAD	DIMENSIONS mm					
	DN	inch	Size		T	B	A	C		

M22612-04-04	6	1/4"	- 04	7/16" - 20	4,0	15,5	8,2			17
M22612-05-06	8	5/16"	- 05	5/8" - 18	7,0	16,5	10,8			22
M22612-06-06	10	3/8"	- 06	5/8" - 18	7,0	16,6	10,8			22
M22612-12-12	19	3/4"	- 12	1.1/16" - 14	15,0	22,7	14,4			32

M22692

90° SAE FEMALE SWEEP ELBOW 45° CONE SEAT - SAE J516/J512 (THRUST-WIRE NUT)

HEMBRA SAE CODO DE 90° ASIEN TO A 45° - SAE J516/J512 (TUERCA CON SEGURO)

DKJ 90° BOGEN 45° KONUS (UNF-GEWINDE NACH SAE J516/J512, GESTIFTETE MUTTER)

FEMMINA SAE 90° CONO 45° - SAE J516/J512 (DADO SPINATO)

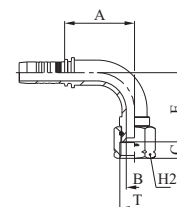

PART. REF.	HOSE BORE			THREAD	DIMENSIONS mm					
	DN	inch	Size		T	B	A	C	E	

M22692-04-04	6	1/4"	- 04	7/16" - 20	4,0	28,3	8,0	27,0		17
M22692-06-06	10	3/8"	- 06	5/8" - 18	7,0	35,5	10,8	33,0		22
M22692-12-12	19	3/4"	- 12	1.1/6" - 14	15,0	62,0	14,4	58,0		32

M12810

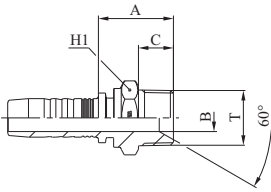

NPTF MALE 60° CONE SEAT - SAE J516/J514
 MACHO NPTF ASIENTO A 60° - SAE J516/J514
 AGN 60° INNENKONUS (NPTF-GEWINDE) - SAE J516/J514
 MASCHIO NPTF CONO 60° - SAE J516 /J514

PART. REF.	HOSE BORE			THREAD	DIMENSIONS mm				
	DN	inch	Size		T	B	A	C	H ₁
M12810-03-02	5	3/16"	- 03	1/8" - 27	4,0	23,6	10,0		12
M12810-03-04	5	3/16"	- 03	1/4" - 18	5,5	29,1	14,5		14
M12810-04-02	6	1/4"	- 04	1/8" - 27	4,0	24,1	10,0		12
M12810-04-04	6	1/4"	- 04	1/4" - 18	5,5	29,0	14,5		14
M12810-04-06	6	1/4"	- 04	3/8" - 18	9,3	31,5	14,5		19
M12810-04-08	6	1/4"	- 04	1/2" - 14	9,3	33,5	19,2		24
M12810-05-04	8	5/16"	- 05	1/4" - 18	5,5	30,0	14,5		14
M12810-05-06	8	5/16"	- 05	3/8" - 18	9,3	32,0	14,5		19
M12810-06-04	10	3/8"	- 06	1/4" - 18	5,5	30,1	14,5		14
M12810-06-06	10	3/8"	- 06	3/8" - 18	9,3	28,6	14,5		19
M12810-06-08	10	3/8"	- 06	1/2" - 14	12,5	34,6	19,2		24
M12810-08-06	12	1/2"	- 08	3/8" - 18	9,3	28,9	14,5		19
M12810-08-08	12	1/2"	- 08	1/2" - 14	12,5	34,9	19,2		24
M12810-08-12	12	1/2"	- 08	3/4" - 14	16,0	35,4	19,2		27
M12810-10-08	16	5/8"	- 10	1/2" - 14	12,5	38,7	19,2		24
M12810-10-12	16	5/8"	- 10	3/4" - 14	16,0	40,2	19,2		27
M12810-12-12	19	3/4"	- 12	3/4" - 14	16,0	36,5	19,2		27
M12810-12-08	19	3/4"	- 12	1/2" - 14	12,5	36,5	13,6		27
M12810-12-16	19	3/4"	- 12	1" - 11,5	19,8	46,0	24,2		36
M12810-16-12	25	1"	- 16	3/4" - 14	15,5	38,8	19,2		32
M12810-16-16	25	1"	- 16	1" - 11,5	19,8	43,8	24,2		36
M12810-16-20	25	1"	- 16	1.1/4" - 11,5	26,0	56,3	25,0		46
M12810-20-20	31	1.1/4"	- 20	1.1/4" - 11,5	26,0	56,5	25,0		46
M12810-24-24	38	1.1/2"	- 24	1.1/2" - 11,5	32,0	57,6	26,0		50
M12810-32-32	51	2"	- 32	2" - 11,5	45,0	64,3	26,5		65
M12810-40-40	63	2.1/2"	- 40	2.1/2" - 8	55,4	78,0	39,9		80
M12810-48-48	76	3"	- 48	3" - 8	68,9	86,0	41,5		100

SAE STANDARD CONNECTIONS

M14110R*

NPTF SWIVEL MALE 60° CONE SEAT - SAE J516/J514
 MACHO NPTF GIRATORIO ROSCA ASIENTO A 60° - SAE J516/J514
 AGN 60° INNENKONUS (NPTF-GEWINDE) - SAE J516/J514
 MASCHIO NPTF CONO 60° GIREVOLE - SAE J516/J514

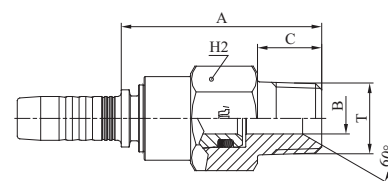

PART. REF.	HOSE BORE			THREAD	DIMENSIONS mm				
	DN	inch	Size		T	B	A	C	H ₂
M14110-04-02R	6	1/4"	- 04	1/8" - 27	3,0	41,9	10,0		17
M14110-04-04R	6	1/4"	- 04	1/4" - 18	4,0	46,4	14,5		17
M14110-04-06R	6	1/4"	- 04	3/8" - 18	7,0	46,4	14,5		19
M14110-06-04R	10	3/8"	- 06	1/4" - 18	4,0	50,5	14,5		22
M14110-06-06R	10	3/8"	- 06	3/8" - 18	7,0	50,5	14,5		22
M14110-06-08R	10	3/8"	- 06	1/2" - 14	9,3	55,2	19,2		24
M14110-08-06R	12	1/2"	- 08	3/8" - 18	7,0	51,5	14,5		27
M14110-08-08R	12	1/2"	- 08	1/2" - 14	9,3	59,0	19,2		27
M14110-12-12R	19	3/4"	- 12	3/4" - 14	16,0	57,9	19,2		32
M14110-16-16R	25	1"	- 16	1" - 11,5	19,8	65,8	24,2		38

* Not to be used as a live swivel / No usar como una pieza giratoria viva / Nicht zu benutzen als Drehverschraubung / Da non usare come applicazione rotante

M22812

NPSM FEMALE 60° CONE - SAE J516/J514 (THRUST-WIRE NUT)
 HEMBRA NPSM ASIENTO A 60° - SAE J516/J514 (TUERCA CON SEGURO)
 DK NPSM 60° KONUS - SAE J516/J514 (NPTF-GEWINDE, GESTIFTETE MUTTER)
 FEMMINA NPSM CONO 60° - SAE J516/J514 (DADO SPINATO)

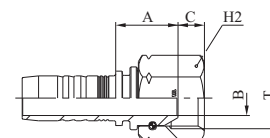

PART. REF.	HOSE BORE			THREAD	DIMENSIONS mm				
	DN	inch	Size		T	B	A	C	H ₂
M22812-04-04	6	1/4"	- 04	1/4" - 18	4,0	17,5	4,2		19
M22812-06-04	10	3/8"	- 06	1/4" - 18	4,0	18,0	4,2		19
M22812-06-06	10	3/8"	- 06	3/8" - 18	7,0	20,9	6,0		22
M22812-08-08	12	1/2"	- 08	1/2" - 14	9,3	22,8	6,5		27
M22812-12-12	19	3/4"	- 12	3/4" - 14	15,0	24,5	9,0		32
M22812-16-16	25	1"	- 16	1" - 11,5	19,8	27,3	10,5		38

M23311

ISO/SAE CODE 61 FLANGE - SAE J516 / ISO 12151-3
 BRIDA ISO/SAE CODIGO 61 - SAE J516 / ISO 12151-3
 ISO/SAE CODE 61 FLANSCH - SAE J516 / ISO 12151-3
 FLANGIA ISO/SAE CODE 61 - SAE J516 / ISO 12151-3

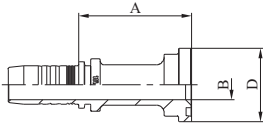

PART. REF.	HOSE BORE			FLANGE	DIMENSIONS mm					
	DN	inch	Size		B	A	D			
M23311-08-08	12	1/2"	- 08	1/2"	9,3	50,9	30,3			
M23311-08-12	12	1/2"	- 08	3/4"	15,0	57,7	38,0			
M23311-10-08	16	5/8"	- 10	3/4"	9,3	51,0	30,3			
M23311-10-12	16	1/2"	- 10	3/4"	15,0	65,7	38,0			
M23311-12-12	19	3/4"	- 12	3/4"	15,0	58,0	38,0			
M23311-12-16	19	3/4"	- 12	1"	20,0	58,0	44,6			
M23311-12-20	19	3/4"	- 12	1.1/4"	26,0	69,5	51,0			
M23311-16-12	25	1"	- 16	3/4"	15,0	60,5	38,0			
M23311-16-16	25	1"	- 16	1"	19,8	64,3	44,6			
M23311-16-20	25	1"	- 16	1.1/4"	26,0	70,3	51,0			
M23311-20-16	31	1.1/4"	- 20	1"	20,0	64,5	44,6			
M23311-20-20	31	1.1/4"	- 20	1.1/4"	26,0	70,5	51,0			
M23311-20-24	31	1.1/4"	- 20	1.1/2"	32,0	72,5	60,5			
M23311-24-24	38	1.1/2"	- 24	1.1/2"	32,0	75,6	60,5			
M23311-24-32	38	1.1/2"	- 24	2"	42,0	75,6	71,6			
M23311-32-32	51	2"	- 32	2"	42,0	78,9	71,6			
M23311-32-40	51	2"	- 32	2.1/2"	56,0	80,9	84,3			
M23311-38-40	60	2.3/8"	- 38	2.1/2"	56,0	84,0	84,3			
M23311-40-32	63	2.1/2"	- 40	2"	42,0	78,5	71,6			
M23311-40-40	63	2.1/2"	- 40	2.1/2"	56,0	84,0	84,3			
M23311-40-48	63	2.1/2"	- 40	3"	68,9	79,0	101,6			
M23311-40-56	63	2.1/2"	- 40	3.1/2"	79,0	90,5	114,3			
M23311-40-64	63	2.1/2"	- 40	4"	90,0	96,5	127,0			
M23311-48-48	76	3"	- 48	3"	69,0	86,0	101,6			
M23311-56-56	90	3.1/2"	- 56	3.1/2"	79,0	94,5	114,3			
M23311-64-64	102	4"	- 64	4"	90,0	100,5	127,0			

SAE STANDARD CONNECTIONS

M23321

22,5° ISO/SAE CODE 61 FLANGE - SAE J516 / ISO 12151-3

BRIDA 22,5° ISO/SAE CODIGO 61 - SAE J516 / ISO 12151-3

22,5° ISO/SAE CODE 61 FLANSCH - SAE J516 / ISO 12151-3

FLANGIA 22,5° ISO/SAE CODE 61 - SAE J516 / ISO 12151-3

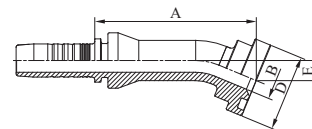

PART. REF.	HOSE BORE			FLANGE	DIMENSIONS mm			
	DN	inch	Size		B	A	D	E
M23321-08-08	12	1/2"	- 08	1/2"	9,3	63,9	30,3	8,0
M23321-12-12	19	3/4"	- 12	3/4"	15,0	74,7	38,0	9,8
M23321-12-16	19	3/4"	- 12	1"	20,0	74,7	44,6	9,8
M23321-16-16	25	1"	- 16	1"	19,8	88,8	44,6	11,5
M23321-16-20	25	1"	- 16	1.1/4"	26,0	88,5	51,0	11,5
M23321-16-24	25	1"	- 16	1.1/2"	32,0	88,5	60,5	11,5
M23321-20-20	31	1.1/4"	- 20	1.1/4"	26,0	100,0	51,0	12,0
M23321-20-20018	31	1.1/4"	- 20	1.1/4"	26,0	99,0	51,0	18,0
M23321-20-24	31	1.1/4"	- 20	1.1/2"	32,0	101,8	60,5	12,8
M23321-24-24	38	1.1/2"	- 24	1.1/2"	32,0	116,5	60,5	14,0
M23321-24-24023	38	1.1/2"	- 24	1.1/2"	32,0	115,0	60,5	23,0
M23321-24-32	38	1.1/2"	- 24	2"	42,0	116,5	71,6	14,0
M23321-32-32	51	2"	- 32	2"	42,0	134,5	71,6	15,0
M23321-40-40*	63	2.1/2"	- 40	2.1/2"	52,0	72,0	84,3	14,0
M23321-40-48*	63	2.1/2"	- 40	3"	52,0	79,0	101,6	17,0
M23321-48-48*	76	3"	- 48	3"	61,0	111,0	101,6	20,5

* All items are made from solid with the exception of (*) / Todos los ítems son fabricados sin soldadura exceptuando (*) / Mit Ausnahme der mit (*) bezeichneten Positionen sind alle Armaturen in einteiliger Ausführung / Ad eccezione di (*) tutte le referenze sono a pezzo unico

M23331

30° ISO/SAE CODE 61 FLANGE - SAE J516 / ISO 12151-3
 BRIDA 30° ISO/SAE CODIGO 61 - SAE J516 / ISO 12151-3
 30° ISO/SAE CODE 61 FLANSCH - SAE J516 / ISO 12151-3
 FLANGIA 30° ISO/SAE CODE 61 - SAE J516 / ISO 12151-3

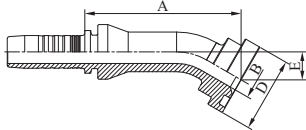

PART. REF.	HOSE BORE			FLANGE	DIMENSIONS mm			
	DN	inch	Size		B	A	D	E
M23331-08-08	12	1/2"	- 08	1/2"	9,3	62,6	30,3	11,2
M23331-08-12	12	1/2"	- 08	3/4"	15,0	63,5	38,0	11,5
M23331-12-12	19	3/4"	- 12	3/4"	15,0	73,2	38,0	13,9
M23331-12-16	19	3/4"	- 12	1"	20,0	73,2	44,6	13,9
M23331-16-16	25	1"	- 16	1"	19,8	86,8	44,6	16,4
M23331-16-20	25	1"	- 16	1.1/4"	26,0	87,0	51,0	16,5
M23331-20-20	31	1.1/4"	- 20	1.1/4"	26,0	98,0	51,0	17,4
M23331-20-24	31	1.1/4"	- 20	1.1/2"	32,0	100,0	60,5	18,5
M23331-20-24044	31	1.1/4"	- 20	1.1/2"	32,0	131,5	60,5	44,0
M23331-24-24	38	1.1/2"	- 24	1.1/2"	32,0	114,3	60,5	20,0
M23331-24-32	38	1.1/2"	- 24	2"	42,0	114,5	71,6	20,0
M23331-32-32	51	2"	- 32	2"	42,0	132,0	71,6	22,0
M23331-40-40*	63	2.1/2"	- 40	2.1/2"	52,0	79,5	84,3	20,5
M23331-40-48*	63	2.1/2"	- 40	3"	52,0	85,5	101,6	24,5
M23331-48-48*	76	3"	- 48	3"	61,0	110,5	101,6	27,5

* All items are made from solid with the exception of (*) / Todos los ítems son fabricados sin soldadura exceptuando (*) / Mit Ausnahme der mit (*) bezeichneten Positionen sind alle Armaturen in einteiliger Ausführung / Ad eccezione di (*) tutte le referenze sono a pezzo unico

SAE STANDARD CONNECTIONS

M23341

45° ISO/SAE CODE 61 FLANGE - SAE J516 / ISO 12151-3

BRIDA 45° ISO/SAE CODIGO 61 - SAE J516 / ISO 12151-3

45° ISO/SAE CODE 61 FLANSCH - SAE J516 / ISO 12151-3

FLANGIA 45° ISO/SAE CODE 61 - SAE J516 / ISO 12151-3

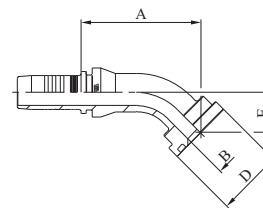

PART. REF.	HOSE BORE			FLANGE	DIMENSIONS mm			
	DN	inch	Size		B	A	D	E
M23341-06-08	10	3/8"	- 06	1/2"	9,3	52,5	30,3	17,0
M23341-08-08	12	1/2"	- 08	1/2"	9,3	58,5	30,3	18,5
M23341-08-12	12	1/2"	- 08	3/4"	15,0	59,5	38,0	19,0
M23341-08-16	12	1/2"	- 08	1"	20,0	59,5	44,6	19,0
M23341-10-12	16	5/8"	- 10	3/4"	15,0	61,0	38,0	22,0
M23341-12-12	19	3/4"	- 12	3/4"	15,0	68,5	38,0	23,0
M23341-12-16	19	3/4"	- 12	1"	20,0	68,5	44,6	23,0
M23341-16-12	25	1"	- 16	3/4"	15,0	74,5	38,0	23,0
M23341-16-16	25	1"	- 16	1"	19,8	81,5	44,6	27,5
M23341-16-20	25	1"	- 16	1.1/4"	26,0	81,5	51,0	27,5
M23341-20-16	31	1.1/4"	- 20	1"	19,8	84,5	44,6	29,5
M23341-20-20	31	1.1/4"	- 20	1.1/4"	26,0	92,0	51,0	29,5
M23341-20-24	31	1.1/4"	- 20	1.1/2"	32,0	93,5	60,5	31,0
M23341-24-24	38	1.1/2"	- 24	1.1/2"	32,0	107,5	60,5	34,5
M23341-24-32	38	1.1/2"	- 24	2"	42,0	107,5	71,6	34,5
M23341-32-32	51	2"	- 32	2"	42,0	124,0	71,6	39,0
M23341-32-40	51	2"	- 32	2.1/2"	56,0	136,5	84,3	49,5
M23341-40-32	63	2.1/2"	- 40	2"	42,0	152,0	71,5	48,5
M23341-40-40*	63	2.1/2"	- 40	2.1/2"	56,0	74,5	84,3	30,0
M23341-40-48*	63	2.1/2"	- 40	3"	52,0	79,5	101,6	36,0
M23341-48-48*	76	3"	- 48	3"	61,0	109,0	101,6	41,0
M23341-56-56*	90	3.1/2"	- 56	3.1/2"	79,0	115,0	114,3	47,5
M23341-56-64*	90	3.1/2"	- 56	4"	79,0	118,5	127,0	51,0
M23341-64-64*	102	4"	- 64	4"	90,0	132,0	127,0	56,5

* All items are made from solid with the exception of (*) / Todos los ítems son fabricados sin soldadura exceptuando (*) / Mit Ausnahme der mit (*) bezeichneten Positionen sind alle Armaturen in einteiliger Ausführung / Ad eccezione di (*) tutte le referenze sono a pezzo unico

M23361

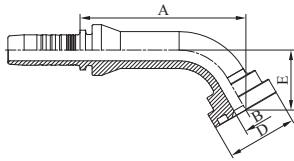

60° ISO/SAE CODE 61 FLANGE - SAE J516 / ISO 12151-3
 BRIDA 60° ISO/SAE CODIGO 61 - SAE J516 / ISO 12151-3
 60° ISO/SAE CODE 61 FLANSCH - SAE J516 / ISO 12151-3
 FLANGIA 60° ISO/SAE CODE 61 - SAE J516 / ISO 12151-3

PART. REF.	HOSE BORE			FLANGE	DIMENSIONS mm			
	DN	inch	Size		B	A	D	E
M23361-08-08	12	1/2"	- 08	1/2"	9,3	71,5	30,3	25,8
M23361-08-12	12	1/2"	- 08	3/4"	15,0	72,5	38,0	26,5
M23361-12-12	19	3/4"	- 12	3/4"	15,0	86,9	38,0	33,0
M23361-12-16	19	3/4"	- 12	1"	20,0	87,0	44,6	33,0
M23361-16-16	25	1"	- 16	1"	19,8	104,0	44,6	39,0
M23361-16-20	25	1"	- 16	1.1/4"	26,0	104,0	44,6	39,0
M23361-20-20	31	1.1/4"	- 20	1.1/4"	26,0	120,0	51,0	43,0
M23361-20-20065	31	1.1/4"	- 20	1.1/4"	26,0	107,5	51,0	65,0
M23361-20-24	31	1.1/4"	- 20	1.1/2"	32,0	121,0	60,5	44,7
M23361-24-20	38	1.1/2"	- 24	1.1/4"	26,0	141,5	51,0	46,5
M23361-24-24	38	1.1/2"	- 24	1.1/2"	32,0	143,6	60,5	50,7
M23361-24-32	38	1.1/2"	- 24	2"	42,0	143,5	71,6	51,0
M23361-32-32	51	2"	- 32	2"	42,0	129,0	71,6	58,0
M23361-40-40*	63	2.1/2"	- 40	2.1/2"	52,0	84,5	84,3	47,5
M23361-40-48*	63	2.1/2"	- 40	3"	52,0	88,5	101,6	55,0
M23361-48-48*	76	3"	- 48	3"	61,0	120,0	101,6	64,0

* All items are made from solid with the exception of (*) / Todos los ítems son fabricados sin soldadura exceptuando (*) / Mit Ausnahme der mit (*) bezeichneten Positionen sind alle Armaturen in einteiliger Ausführung / Ad eccezione di (*) tutte le referenze sono a pezzo unico

SAE STANDARD CONNECTIONS

M23371

67,5° ISO/SAE CODE 61 FLANGE - SAE J516 / ISO 12151-3

BRIDA 67,5° ISO/SAE CODIGO 61 - SAE J516 / ISO 12151-3

67,5° ISO/SAE CODE 61 FLANSCH - SAE J516 / ISO 12151-3

FLANGIA 67,5° ISO/SAE CODE 61 - SAE J516 / ISO 12151-3

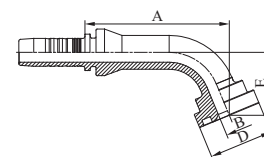

PART. REF.	HOSE BORE			FLANGE	DIMENSIONS mm			
	DN	inch	Size		B	A	D	E
M23371-08-08	12	1/2"	- 08	1/2"	9,3	67,9	30,3	29,3
M23371-08-12	12	1/2"	- 08	3/4"	15,0	68,5	38,0	30,5
M23371-08-16	12	1/2"	- 08	1"	20,0	68,5	44,6	30,5
M23371-12-12	19	3/4"	- 12	3/4"	15,0	82,2	38,0	38,0
M23371-12-16	19	3/4"	- 12	1"	20,0	82,2	44,6	38,0
M23371-12-20	19	3/4"	- 12	1.1/4"	26,0	82,5	51,0	38,0
M23371-16-16	25	1"	- 16	1"	19,8	98,6	44,6	45,0
M23371-16-20	25	1"	- 16	1.1/4"	26,0	98,5	51,0	45,0
M23371-20-20	31	1.1/4"	- 20	1.1/4"	26,0	114,0	51,0	50,0
M23371-20-24	31	1.1/4"	- 20	1.1/2"	32,0	115,0	60,5	52,0
M23371-24-24	38	1.1/2"	- 24	1.1/2"	32,0	136,4	60,5	59,2
M23371-24-32	38	1.1/2"	- 24	2"	42,0	136,5	71,6	59,0
M23371-32-32	51	2"	- 32	2"	42,0	162,0	71,6	68,5
M23371-32-32085	51	2"	- 32	2"	42,0	151,5	71,6	85,0
M23371-32-40	51	2"	- 32	2.1/2"	56,0	171,5	84,3	83,5
M23371-40-40*	63	2.1/2"	- 40	2.1/2"	52,0	87,5	84,3	57,5
M23371-40-48*	63	2.1/2"	- 40	3"	52,0	91,0	101,6	65,0

* All items are made from solid with the exception of (*) / Todos los ítems son fabricados sin soldadura exceptuando (*) / Mit Ausnahme der mit (*) bezeichneten Positionen sind alle Armaturen in einteiliger Ausführung / Ad eccezione di (*) tutte le referenze sono a pezzo unico

M23391

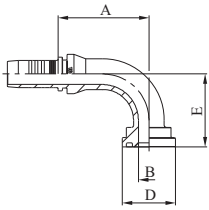

90° ISO/SAE CODE 61 FLANGE - SAE J516 / ISO 12151-3
 BRIDA 90° ISO/SAE CODIGO 61 - SAE J516 / ISO 12151-3
 90° ISO/SAE CODE 61 FLANSCH - SAE J516 / ISO 12151-3
 FLANGIA 90° ISO/SAE CODE 61 - SAE J516 / ISO 12151-3

PART. REF.	HOSE BORE			FLANGE	DIMENSIONS mm			
	DN	inch	Size		B	A	D	E
M23391-06-08	10	3/8"	- 06	1/2"	9,3	45,0	30,3	35,0
M23391-06-08041	10	3/8"	- 06	1/2"	9,3	45,0	30,3	41,0
M23391-08-08	12	1/2"	- 08	1/2"	9,3	54,5	30,3	40,0
M23391-08-12	12	1/2"	- 08	3/4"	15,0	54,5	38,0	41,0
M23391-08-16	12	1/2"	- 08	1"	20,0	54,5	44,6	66,0
M23391-10-08	16	5/8"	- 10	1/2"	9,3	56,0	30,3	46,5
M23391-10-12	16	5/8"	- 10	3/4"	15,0	56,0	38,0	47,5
M23391-12-12	19	3/4"	- 12	3/4"	15,0	64,5	38,0	52,0
M23391-12-16	19	3/4"	- 12	1"	20,0	64,5	44,6	52,0
M23391-12-20	19	3/4"	- 12	1.1/4"	26,0	64,5	51,0	52,0
M23391-16-16	25	1"	- 16	1"	19,8	77,5	44,6	62,0
M23391-16-20	25	1"	- 16	1.1/4"	26,0	77,5	51,0	62,0
M23391-16-24	25	1"	- 16	1.1/2"	32,0	77,5	60,5	64,0
M23391-20-16	31	1.1/4"	- 20	1"	20,0	80,0	44,6	66,0
M23391-20-20	31	1.1/4"	- 20	1.1/4"	26,0	90,5	51,0	70,0
M23391-20-24	31	1.1/4"	- 20	1.1/2"	32,0	90,5	60,5	72,0
M23391-20-32	31	1.1/4"	- 20	2"	42,0	93,5	71,6	76,0
M23391-24-20	38	1.1/2"	- 24	1.1/4"	26,0	104,5	51,0	75,0
M23391-24-24	38	1.1/2"	- 24	1.1/2"	32,0	108,0	60,5	84,0
M23391-24-32	38	1.1/2"	- 24	2"	42,0	108,0	71,6	84,0
M23391-32-24	51	2"	- 32	1.1/2"	32,0	133,0	60,5	84,0
M23391-32-32	51	2"	- 32	2"	42,0	129,0	71,6	99,0
M23391-32-40	51	2"	- 32	2.1/2"	56,0	132,5	84,3	116,0
M23391-40-32	63	2.1/2"	- 40	2"	42,0	149,5	71,6	114,0
M23391-40-40*	63	2.1/2"	- 40	2.1/2"	52,0	88,5	84,3	88,0
M23391-40-48*	63	2.1/2"	- 40	3"	52,0	88,5	101,6	95,0
M23391-48-48*	76	3"	- 48	3"	61,0	124,0	101,6	115,0
M23391-48-56*	76	3"	- 48	3.1/2"	61,0	124,0	114,3	115,0
M23391-56-56*	90	3.1/2"	- 56	3.1/2"	79,0	134,5	114,3	134,5
M23391-64-64*	102	4"	- 64	4"	90,0	153,5	127,0	158,5

* All items are made from solid with the exception of (*) / Todos los ítems son fabricados sin soldadura exceptuando (*) / Mit Ausnahme der mit (*) bezeichneten Positionen sind alle Armaturen in einteiliger Ausführung / Ad eccezione di (*) tutte le referenze sono a pezzo unico

SAE STANDARD CONNECTIONS

M23391 LONG DROP

90° LONG DROP ISO/SAE CODE 61 FLANGE - SAE J516 / ISO 12151-3
 BRIDA 90° LARGA ISO/SAE CODIGO 61 - SAE J516 / ISO 12151-3
 90° LONG DROP ISO/SAE CODE 61 FLANSCH - SAE J516 / ISO 12151-3
 FLANGIA 90° CURVA LUNGA ISO/SAE CODE 61 - SAE J516 / ISO 12151-3

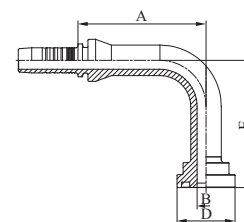

PART. REF.	HOSE BORE			FLANGE	DIMENSIONS mm			
	DN	inch	Size		B	A	D	E
M23391-16-20117	25	1"	- 16	1.1/4"	26,0	77,5	51,0	117
M23391-16-24107	25	1"	- 16	1.1/2"	32,0	77,5	60,5	107
M23391-20-20091	31	1.1/4"	- 20	1.1/4"	26,0	90,5	51,0	91
M23391-20-20100	31	1.1/4"	- 20	1.1/4"	26,0	90,5	51,0	100
M23391-20-20112	31	1.1/4"	- 20	1.1/4"	26,0	90,5	51,0	112
M23391-20-20130	31	1.1/4"	- 20	1.1/4"	26,0	90,5	51,0	130
M23391-20-20168	31	1.1/4"	- 20	1.1/4"	26,0	90,5	51,0	168
M23391-20-24118	31	1.1/4"	- 20	1.1/2"	32,0	90,5	60,5	118
M23391-20-24130	31	1.1/4"	- 20	1.1/2"	32,0	90,5	60,5	130
M23391-24-24148	38	1.1/2"	- 24	1.1/2"	32,0	108,0	60,5	148
M23391-24-24172	38	1.1/2"	- 24	1.1/2"	32,0	108,0	60,5	172
M23391-24-32115	38	1.1/2"	- 24	2"	42,0	108,0	71,6	115
M23391-24-32172	38	1.1/2"	- 24	2"	42,0	108,0	71,6	172
M23391-32-32203	51	2"	- 32	2"	42,0	129,0	71,6	203

M23301P

110° ISO/SAE CODE 61 FLANGE - SAE J516 / ISO 12151-3
 BRIDA 110° ISO/SAE CODIGO 61 - SAE J516 / ISO 12151-3
 110° ISO/SAE CODE 61 FLANSCH - SAE J516 / ISO 12151-3
 FLANGIA 110° ISO/SAE CODE 61 - SAE J516 / ISO 12151-3

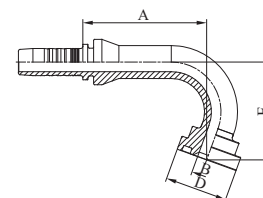

PART. REF.	HOSE BORE			FLANGE	DIMENSIONS mm			
	DN	inch	Size		B	A	D	E
M23301-08-12P	12	1/2"	- 08	3/4"	15,0	47,5	38,0	48,5
M23301-12-12P	19	3/4"	- 12	3/4"	15,0	89,0	38,0	62
M23301-12-16P	19	3/4"	- 12	1"	20,0	89,0	44,6	62
M23301-16-16P	25	1"	- 16	1"	19,8	88,5	44,6	79
M23301-16-20133P	25	1"	- 16	1.1/4"	26,0	77,0	51,0	133
M23301-20-20P	31	1.1/4"	- 20	1.1/4"	26,0	102,0	51,0	89
M23301-20-24P	31	1.1/4"	- 20	1.1/2"	32,0	108,5	60,5	93
M23301-24-24119P	38	1.1/2"	- 24	1.1/2"	32,0	105,5	60,5	119
M23301-32-32P	51	2"	- 32	2"	42,0	142,0	71,6	123

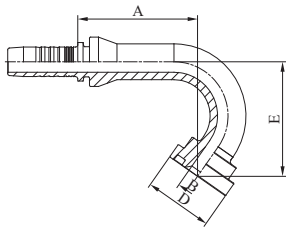

M23301S

125° ISO/SAE CODE 61 FLANGE - SAE J516 / ISO 12151-3
 BRIDA 125° ISO/SAE CODIGO 61 - SAE J516 / ISO 12151-3
 125° ISO/SAE CODE 61 FLANSCH - SAE J516 / ISO 12151-3
 FLANGIA 125° ISO/SAE CODE 61 - SAE J516 / ISO 12151-3

PART. REF.	HOSE BORE			FLANGE	DIMENSIONS mm					
	DN	inch	Size		B	A	D	E		
M23301-32-32151S	51	2"	- 32	2"	42,0	118,5	71,6	151,0		

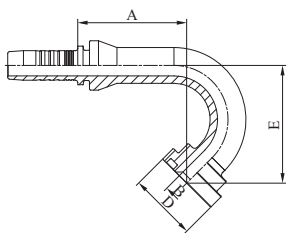

M23301T

135° ISO/SAE CODE 61 FLANGE - SAE J516 / ISO 12151-3
 BRIDA 135° ISO/SAE CODIGO 61 - SAE J516 / ISO 12151-3
 135° ISO/SAE CODE 61 FLANSCH - SAE J516 / ISO 12151-3
 FLANGIA 135° ISO/SAE CODE 61 - SAE J516 / ISO 12151-3

PART. REF.	HOSE BORE			FLANGE	DIMENSIONS mm					
	DN	inch	Size		B	A	D	E		
M23301-12-12T	19	3/4"	- 12	3/4"	15,0	74,5	38,0	70,0		
M23301-12-16T	19	3/4"	- 12	1"	20,0	74,5	44,6	70,0		
M23301-16-16T	25	1"	- 16	1"	19,8	70,0	44,6	88,5		

SAE STANDARD CONNECTIONS

M23611

ISO/SAE CODE 62 FLANGE - SAE J516 / ISO 12151-3

BRIDA ISO/SAE CODIGO 62 - SAE J516 / ISO 12151-3

ISO/SAE CODE 62 FLANSCH - SAE J516/ISO 12151-3

FLANGIA ISO/SAE CODE 62 - SAE J516 / ISO 12151-3

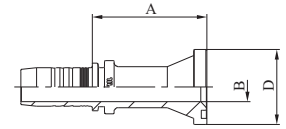

PART. REF.	HOSE BORE			FLANGE	DIMENSIONS mm					
	DN	inch	Size		B	A	D			
M23611-08-08	12	1/2"	- 08	1/2"	9,3	52,1	31,8			
M23611-08-12	12	1/2"	- 08	3/4"	15,0	68,4	41,5			
M23611-10-08	16	5/8"	- 10	1/2"	9,3	52,0	31,8			
M23611-10-12	16	5/8"	- 10	3/4"	15,0	70,2	41,5			
M23611-10-16	16	5/8"	- 10	1"	20,0	80,0	47,7			
M23611-12-12	19	3/4"	- 12	3/4"	15,0	69,0	41,5			
M23611-12-16	19	3/4"	- 12	1"	20,0	81,0	47,7			
M23611-16-16	25	1"	- 16	1"	19,8	82,3	47,7			
M23611-16-20	25	1"	- 16	1.1/4"	26,0	89,8	54,2			
M23611-20-16	31	1.1/4"	- 20	1"	20,0	82,5	47,7			
M23611-20-20	31	1.1/4"	- 20	1.1/4"	26,0	84,5	54,2			
M23611-20-24	31	1.1/4"	- 20	1.1/2"	32,0	90,5	63,7			
M23611-24-24	38	1.1/2"	- 24	1.1/2"	32,0	92,6	63,7			
M23611-32-32	51	2"	- 32	2"	42,0	107,9	79,6			

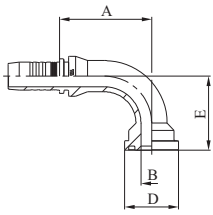

M23691

90° ISO/SAE CODE 62 FLANGE - SAE J516 / ISO 12151-3
 BRIDA 90° ISO/SAE CODIGO 62 - SAE J516 / ISO 12151-3
 90° ISO/SAE CODE 61 FLANSCH - SAE J516 / ISO 12151-3
 FLANGIA 90° ISO/SAE CODE 62 - SAE J516 / ISO 12151-3

PART. REF.	HOSE BORE			FLANGE	DIMENSIONS mm			
	DN	inch	Size		B	A	D	E
M23691-08-08	12	1/2"	- 08	1/2"	9,3	54,5	31,8	45,0
M23691-08-12	12	1/2"	- 08	3/4"	15,0	54,5	41,5	53,0
M23691-10-08	16	5/8"	- 10	1/2"	9,3	57,5	31,8	45,0
M23691-10-12	16	5/8"	- 10	3/4"	15,0	56,0	41,5	58,0
M23691-10-16	16	5/8"	- 10	1"	19,8	55,7	47,7	65,0
M23691-12-12	19	3/4"	- 12	3/4"	15,0	64,0	41,5	59,0
M23691-12-16	19	3/4"	- 12	1"	20,0	64,5	47,7	65,0
M23691-16-16	25	1"	- 16	1"	19,8	73,5	47,7	68,0
M23691-16-20	25	1"	- 16	1.1/4"	26,0	73,5	54,2	75,0
M23691-20-16	31	1.1/4"	- 20	1"	20,0	82,5	47,7	68,0
M23691-20-20	31	1.1/4"	- 20	1.1/4"	26,0	85,5	54,2	81,0
M23691-20-24	31	1.1/4"	- 20	1.1/2"	32,0	85,5	63,7	91,5
M23691-24-24	38	1.1/2"	- 24	1.1/2"	32,0	106,0	63,7	94,5
M23691-24-32	38	1.1/2"	- 24	2"	42,0	106,0	79,6	110,5
M23691-32-32	51	2"	- 32	2"	42,0	138,0	79,6	132,0

MULTIFIT TYPE



SAE STANDARD CONNECTIONS

M23641

45° ISO/SAE CODE 62 FLANGE - SAE J516 / ISO 12151-3

BRIDA 45° ISO/SAE CODIGO 62 - SAE J516 / ISO 12151-3

45° ISO/SAE CODE 62 FLANSCH - SAE J516 / ISO 12151-3

FLANGIA 45° ISO/SAE CODE 62 - SAE J516 / ISO 12151-3

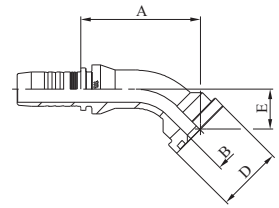

PART. REF.	HOSE BORE			FLANGE	DIMENSIONS mm					
	DN	inch	Size		B	A	D	E		
M23641-08-08	12	1/2"	- 08	1/2"	9,3	62,0	31,8	22,0		
M23641-08-12	12	1/2"	- 08	3/4"	15,0	68,0	41,5	27,5		
M23641-10-08	16	5/8"	- 10	1/2"	9,3	62,5	31,8	23,5		
M23641-10-12	16	5/8"	- 10	3/4"	15,0	67,5	41,5	31,0		
M23641-12-12	19	3/4"	- 12	3/4"	15,0	73,0	41,5	28,0		
M23641-12-16	19	3/4"	- 12	1"	20,0	77,0	47,7	32,5		
M23641-16-12	25	1"	- 16	3/4"	15,0	80,0	41,5	30,0		
M23641-16-16	25	1"	- 16	1"	19,8	83,5	47,7	32,5		
M23641-16-20	25	1"	- 16	1.1/4"	26,0	88,5	54,2	37,5		
M23641-20-20	31	1.1/4"	- 20	1.1/4"	26,0	95,5	54,2	37,5		
M23641-20-24	31	1.1/4"	- 20	1.1/2"	32,0	102,5	63,7	45,0		
M23641-24-24	38	1.1/2"	- 24	1.1/2"	32,0	118,0	63,7	44,0		
M23641-24-32	38	1.1/2"	- 24	2"	42,0	129,0	79,6	55,5		
M23641-32-32	51	2"	- 32	2"	42,0	151,5	79,6	60,5		

M22010

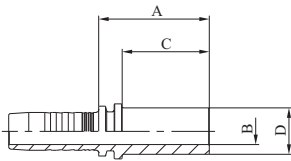

METRIC STANDPIPE LIGHT DUTY - DIN 2353 / ISO 8434-1
 ESPIGA LISA METRICA RECTA SERIE LIGERA - DIN 2353 / ISO 8434-1
 BEL - DIN 2353 / ISO 8434-1
 ESTREMITÀ TUBOLARE SERIE LEGGERA - DIN 2353 / ISO 8434-1

PART. REF.	HOSE BORE			PIPE	DIMENSIONS mm						
	DN	inch	Size		D	B	A	C			
M22010-03-04	5	3/16"	- 03	4	2,0	29,6	22,0				
M22010-03-06	5	3/16"	- 03	6	3,0	28,6	22,0				
M22010-04-06	6	1/4"	- 04	6	3,0	29,5	22,0				
M22010-05-08	8	5/16"	- 05	8	5,5	30,0	22,0				
M22010-05-10	8	5/16"	- 05	10	7,0	30,5	23,0				
M22010-06-10	10	3/8"	- 06	10	7,0	30,6	23,0				
M22010-06-12	10	3/8"	- 06	12	8,0	30,6	23,0				
M22010-06-15	10	3/8"	- 06	15	10,5	32,6	25,0				
M22010-08-12	12	1/2"	- 08	12	8,0	30,9	23,0				
M22010-08-15	12	1/2"	- 08	15	10,5	32,9	25,0				
M22010-08-18	12	1/2"	- 08	18	12,5	33,9	26,0				
M22010-10-18	16	5/8"	- 10	18	12,5	34,2	26,0				
M22010-10-22	16	5/8"	- 10	22	15,0	36,2	28,0				
M22010-12-18	19	3/4"	- 12	18	15,0	36,2	26,0				
M22010-12-22	19	3/4"	- 12	22	15,0	38,0	28,0				
M22010-16-28	25	1"	- 16	28	20,5	41,3	30,0				
M22010-20-35	31	1.1/4"	- 20	35	26,0	48,5	36,0				
M22010-24-42	38	1.1/2"	- 24	42	32,0	52,6	40,0				

DIN STANDARD CONNECTIONS

M22110

METRIC STANDPIPE HEAVY DUTY - DIN 2353 / ISO 8434-1

ESPIGA LISA METRICA RECTA SERIE PESADA - DIN 2353 / ISO 8434-1

BES - DIN 2353 / ISO 8434-1

ESTREMITÀ TUBOLARE SERIE PESANTE - DIN 2353 / ISO 8434-1

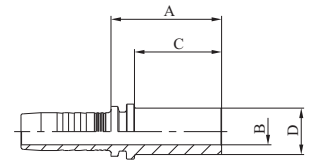

PART. REF.	HOSE BORE			PIPE	DIMENSIONS mm			
	DN	inch	Size		D	B	A	C
M22110-03-08	5	3/16"	- 03	8	3,0	30,6	24,0	
M22110-03-10	5	3/16"	- 03	10	3,0	29,5	22,0	
M22110-04-08	6	1/4"	- 04	8	4,0	31,5	24,0	
M22110-04-10	6	1/4"	- 04	10	4,0	33,5	26,0	
M22110-04-12	6	1/4"	- 04	12	7,0	33,5	26,0	
M22110-05-12	8	5/16"	- 05	12	7,0	33,5	26,0	
M22110-06-14	10	3/8"	- 06	14	8,0	36,6	29,0	
M22110-08-14	12	1/2"	- 08	14	9,3	36,9	29,0	
M22110-08-16	12	1/2"	- 08	16	10,5	37,9	30,0	
M22110-10-20	16	5/8"	- 10	20	12,5	44,2	36,0	
M22110-12-20	19	3/4"	- 12	20	15,0	46,0	36,0	
M22110-12-25	19	3/4"	- 12	25	15,0	50,0	40,0	
M22110-16-25	25	1"	- 16	25	15,0	51,3	40,0	
M22110-16-30	25	1"	- 16	30	20,5	55,3	44,0	
M22110-16-38	25	1"	- 16	38	26,0	61,3	50,0	
M22110-20-30	31	1.1/4"	- 20	30	20,5	56,5	44,0	
M22110-20-38	31	1.1/4"	- 20	38	26,0	62,5	50,0	
M22110-24-38	38	1.1/2"	- 24	38	26,0	62,6	50,0	

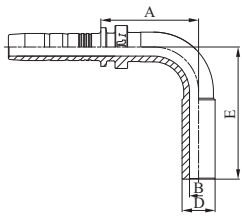

M22090

90° METRIC STANDPIPE LIGHT DUTY - DIN 2353 / ISO 8434-1
 ESPIGA LISA METRICA SERIE LIGERA CODO DE 90° - DIN 2353 / ISO 8434-1
 BEL 90° BOGEN - DIN 2353 / ISO 8434-1
 ESTREMITÀ TUBOLARE 90° SERIE LEGGERA - DIN 2353 / ISO 8434-1

PART. REF.	HOSE BORE			PIPE	DIMENSIONS mm				
	DN	inch	Size		D	B	A	E	
M22090-03-06	5	3/16"	- 03	6	3,0	22,5		34,0	
M22090-04-06	6	1/4"	- 04	6	3,0	23,0		34,0	
M22090-05-10	8	5/16"	- 05	10	7,0	29,5		40,0	
M22090-06-10	10	3/8"	- 06	10	7,0	34,0		42,5	
M22090-06-12	10	3/8"	- 06	12	8,0	34,0		45,0	
M22090-08-12	12	1/2"	- 08	12	8,0	34,5		45,0	
M22090-08-15	12	1/2"	- 08	15	10,5	42,0		52,0	
M22090-08-18	12	1/2"	- 08	18	12,5	42,0		55,0	
M22090-10-18	16	5/8"	- 10	18	12,5	49,0		59,0	
M22090-10-22	16	5/8"	- 10	22	15,0	53,5		63,0	
M22090-12-22	19	3/4"	- 12	22	15,0	54,5		63,0	
M22090-16-28	25	1"	- 16	28	19,8	67,5		75,0	
M22090-20-35	31	1.1/4"	- 20	35	26,0	80,5		94,0	

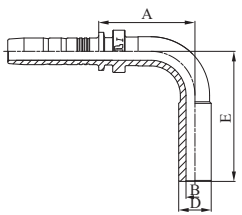

M22190

90° METRIC STANDPIPE HEAVY DUTY - DIN 2353 / ISO 8434-1
 ESPIGA LISA METRICA SERIE PESADA CODO DE 90° - DIN 2353 / ISO 8434-1
 BES 90° BOGEN - DIN 2353 / ISO 8434-1
 ESTREMITÀ TUBOLARE 90° SERIE PESANTE - DIN 2353 / ISO 8434-1

PART. REF.	HOSE BORE			PIPE	DIMENSIONS mm				
	DN	inch	Size		D	B	A	E	
M22190-04-08	6	1/4"	- 04	8	4,0	27,0		38,0	
M22190-04-10	6	1/4"	- 04	10	6,0	27,0		41,0	
M22190-04-12	6	1/4"	- 04	12	7,0	27,0		44,0	
M22190-05-12	8	5/16"	- 05	12	7,0	30,5		44,0	
M22190-06-14	10	3/8"	- 06	14	9,3	35,0		51,0	
M22190-08-14	12	1/2"	- 08	14	9,3	42,0		53,5	
M22190-08-16	12	1/2"	- 08	16	10,5	43,0		55,0	
M22190-10-20	16	5/8"	- 10	20	12,5	49,0		66,5	
M22190-12-20	19	3/4"	- 12	20	15,0	54,5		69,0	
M22190-12-25	19	3/4"	- 12	25	15,0	57,5		75,0	
M22190-16-25	25	1"	- 16	25	15,0	61,5		76,5	
M22190-16-30	25	1"	- 16	30	19,8	69,5		87,0	

DIN STANDARD CONNECTIONS

M22040

45° METRIC STANDPIPE LIGHT DUTY - DIN 2353 / ISO 8434-1
 ESPIGA LISA METRICA SERIE LIGERA CODO DE 45° - DIN 2353 / ISO 8434-1
 BEL 45° BOGEN - DIN 2353 / ISO 8434-1
 ESTREMITÀ TUBOLARE 45° SERIE LEGGERA - DIN 2353 / ISO 8434-1

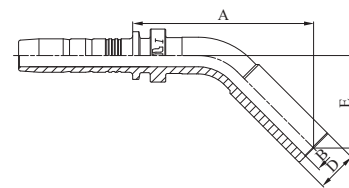

PART. REF.	HOSE BORE			PIPE	DIMENSIONS mm					
	DN	inch	Size		D	B	A	E		
M22040-03-06	5	3/16"	- 03	6	3,0	37,5		20,5		
M22040-04-06	6	1/4"	- 04	6	3,0	38,0		20,5		
M22040-05-10	8	5/16"	- 05	10	7,0	44,5		22,5		
M22040-06-10	10	3/8"	- 06	10	7,0	47,5		23,0		
M22040-06-12	10	3/8"	- 06	12	8,0	49,5		25,0		
M22040-08-15	12	1/2"	- 08	15	10,5	58,0		28,0		
M22040-10-18	16	5/8"	- 10	18	12,5	63,5		30,5		
M22040-12-22	19	3/4"	- 12	22	15,0	69,0		32,0		
M22040-16-28	25	1"	- 16	28	19,8	81,5		37,0		

M22140

45° METRIC STANDPIPE HEAVY DUTY - DIN 2353 / ISO 8434-1
 ESPIGA LISA METRICA SERIE PESADA CODO DE 45° - DIN 2353 / ISO 8434-1
 BES 45° BOGEN - DIN 2353 / ISO 8434-1
 ESTREMITÀ TUBOLARE 45° SERIE PESANTE - DIN 2353 / ISO 8434-1

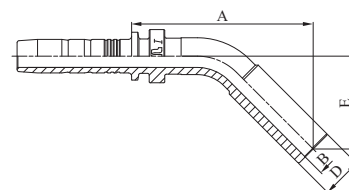

PART. REF.	HOSE BORE			PIPE	DIMENSIONS mm					
	DN	inch	Size		D	B	A	E		
M22140-04-08	6	1/4"	- 04	8	4,0	42,0		22,0		
M22140-04-10	6	1/4"	- 04	10	6,0	44,0		24,0		
M22140-06-14	10	3/8"	- 06	14	9,3	54,5		29,0		
M22140-08-16	12	1/2"	- 08	16	10,5	61,0		30,0		
M22140-10-20	16	5/8"	- 10	20	12,5	69,0		36,0		
M22140-12-25	19	3/4"	- 12	25	15,0	80,5		40,5		
M22140-16-25	25	1"	- 16	25	15,0	82,0		41,0		

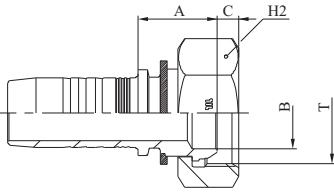

M21013

METRIC FEMALE 60° CONE - DIN 20078/3863
 HEMBRA METRICA ASIEN TO A 60° - DIN 20078/3863
 DKM 60° KONUS - DIN 20078/3863
 FEMMINA METRICA CONO 60° - DIN 20078/3863

PART. REF.	HOSE BORE			THREAD	DIMENSIONS mm				
	DN	inch	Size		T	B	A	C	H ₂
M21013-10-30	16	5/8"	- 10	M 30x1,5	20,0	20,0	8,1		36
M21013-12-30	19	3/4"	- 12	M 30x1,5	20,0	21,0	8,1		36
M21013-16-38	25	1"	- 16	M 38x1,5	26,0	22,8	7,6		46
M21013-20-45	31	1.1/4"	- 20	M 45x1,5	33,0	23,5	8,1		50
M21013-24-52	38	1.1/2"	- 24	M 52x1,5	40,0	25,0	8,1		60

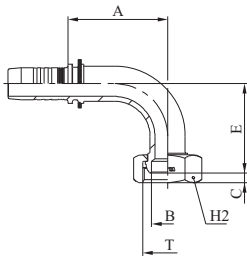

M21093

90° METRIC FEMALE SWEPT ELBOW 60° CONE - DIN 20078/3863
 HEMBRA METRICA CODO DE 90° ASIEN TO A 60° - DIN 20078/3863
 DKM 90° BOGEN 60° KONUS - DIN 20078/3863
 FEMMINA METRICA 90° CONO 60° - DIN 20078/3863

PART. REF.	HOSE BORE			THREAD	DIMENSIONS mm				
	DN	inch	Size		T	B	A	C	E
M21093-12-30	19	3/4"	- 12	M 30x1,5	20,0	61,5	8,1	54,5	36
M21093-16-38	25	1"	- 16	M 38x1,5	26,0	76,5	7,6	63,0	46
M21093-20-45	31	1.1/4"	- 20	M 45x1,5	33,0	92,0	8,1	81,0	50

DIN STANDARD CONNECTIONS

M21312

METRIC FEMALE MULTISEAL - DIN 20078/3868 (THRUST-WIRE NUT)
 HEMBRA METRICA ASIENTO UNIVERSAL - DIN 20078/3868 (TUERCA CON SEGURO)
 DKL UNIVERSALKONUS - DIN 20078/3868 (GESTIFTETE MUTTER)
 FEMMINA METRICA CONO UNIVERSALE - DIN 20078/3868 (DADO SPINATO)

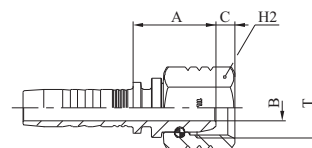

M21313

METRIC FEMALE MULTISEAL - DIN 20078/3868 (SLIP-ON NUT)
 HEMBRA METRICA ASIENTO UNIVERSAL - DIN 20078/3868 (TUERCA LIBRE)
 DKL UNIVERSALKONUS - DIN 20078/3868 (HINTERLEGTE MUTTER)
 FEMMINA METRICA CONO UNIVERSALE - DIN 20078/3868 (DADO PASSANTE)

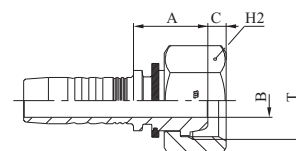

PART. REF.	HOSE BORE			THREAD	PIPE	DIMENSIONS mm				
	DN	inch	Size			T	mm	B	A	C
M21313-03-12	5	3/16"	- 03	M 12x1,5	6	3,0	18,6	3,7		14
M21312-04-12	6	1/4"	- 04	M 12x1,5	6	4,0	19,5	4,0		17
M21313-04-14	6	1/4"	- 04	M 14x1,5	8	4,0	19,5	3,8		17
M21313-04-16	6	1/4"	- 04	M 16x1,5	10	4,0	19,5	4,0		19
M21313-05-16	8	5/16"	- 05	M 16x1,5	10	5,5	19,5	4,0		19
M21313-05-18	8	5/16"	- 05	M 18x1,5	12	5,5	19,6	4,0		22
M21312-06-14	10	3/8"	- 06	M 14x1,5	8	4,0	19,5	3,9		17
M21312-06-16	10	3/8"	- 06	M 16x1,5	10	7,0	21,6	5,0		19
M21313-06-18	10	3/8"	- 06	M 18x1,5	12	7,0	20,1	4,0		22
M21313-06-22	10	3/8"	- 06	M 22x1,5	15	7,0	21,1	5,2		27
M21312-08-18	12	1/2"	- 08	M 18x1,5	12	7,0	23,0	5,9		22
M21313-08-22	12	1/2"	- 08	M 22x1,5	15	9,3	21,5	5,2		27
M21313-10-26	16	5/8"	- 10	M 26x1,5	18	12,5	22,1	5,5		32

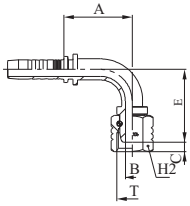

M21392

90° METRIC FEMALE SWEPT ELBOW MULTISEAL DIN 20078/3868 (THRUST-WIRE NUT)
 HEMBRA METRICA CODO DE 90° ASIENTO UNIVERSAL DIN 20078/3868 (TUERCA CON SEGURO)
 DKL UNIVERSALKONUS 90° BOGEN - DIN 20078/3868 (GESTIFTETE MUTTER)
 FEMMINA METRICA 90° CONO UNIVERSALE - DIN 20078/3868 (DADO SPINATO)

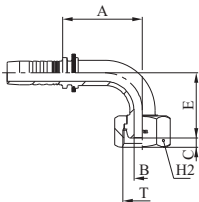

M21393

90° METRIC FEMALE SWEPT ELBOW MULTISEAL DIN 20078/3868 (SLIP-ON NUT)
 HEMBRA METRICA CODO DE 90° ASIENTO UNIVERSAL DIN 20078/3868 (TUERCA LIBRE)
 DKL UNIVERSALKONUS 90° BOGEN - DIN 20078/3868 (HINTERLEGTE MUTTER)
 FEMMINA METRICA 90° CONO UNIVERSALE - DIN 20078/3868 (DADO PASSANTE)

PART. REF.	HOSE BORE			THREAD	PIPE	DIMENSIONS mm				
	DN	inch	Size			T	mm	B	A	C
M21393-03-12	5	3/16"	- 03	M 12x1,5	6	3,0	26,0	3,7	27,0	14
M21392-04-12	6	1/4"	- 04	M 12x1,5	6	4,0	28,0	4,0	30,5	17
M21393-04-14	6	1/4"	- 04	M 14x1,5	8	4,0	29,5	3,8	29,5	17
M21393-04-16	6	1/4"	- 04	M 16x1,5	10	4,0	29,5	4,0	29,5	19
M21393-05-16	8	5/16"	- 05	M 16x1,5	10	5,5	32,0	4,0	29,0	19
M21393-05-18	8	5/16"	- 05	M 18x1,5	12	7,0	32,0	4,0	30,5	22
M21392-06-16	10	3/8"	- 06	M 16x1,5	10	7,0	35,5	5,0	38,0	19
M21393-06-18	10	3/8"	- 06	M 18x1,5	12	7,0	36,5	4,0	31,5	22
M21393-06-22	10	3/8"	- 06	M 22x1,5	15	7,0	36,5	5,2	32,0	27
M21393-08-22	12	1/2"	- 08	M 22x1,5	15	9,3	45,0	5,2	36,5	27
M21393-10-26	16	5/8"	- 10	M 26x1,5	18	12,5	51,5	5,5	50,0	32
M21392-12-26	19	3/4"	- 12	M 26x1,5	18	12,5	61,5	3,6	63,0	32

DIN STANDARD CONNECTIONS

M21342

45° METRIC FEMALE SWEPT ELBOW MULTISEAL DIN 20078/3868 (THRUST-WIRE NUT)
 HEMBRA METRICA CODO DE 45° ASIENTO UNIVERSAL DIN 20078/3868 (TUERCA CON SEGURO)
 DKL UNIVERSALKONUS 45° BOGEN - DIN 20078/3868 (GESTIFTETE MUTTER)
 FEMMINA METRICA 45° CONO UNIVERSALE - DIN 20078/3868 (DADO SPINATO)

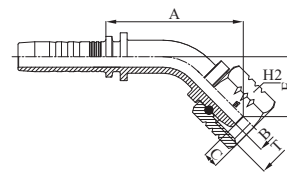

M21343

45° METRIC FEMALE SWEPT ELBOW MULTISEAL DIN 20078/3868 (SLIP-ON NUT)
 HEMBRA METRICA CODO DE 45° ASIENTO UNIVERSAL DIN 20078/3868 (TUERCA LIBRE)
 DKL UNIVERSALKONUS 45° BOGEN - DIN 20078/3868 (HINTERLEGTE MUTTER)
 FEMMINA METRICA 45° CONO UNIVERSALE - DIN 20078/3868 (DADO PASSANTE)

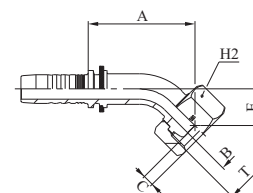

PART. REF.	HOSE BORE			THREAD	PIPE	DIMENSIONS mm				
	DN	inch	Size			T	mm	B	A	C
M21343-04-14	6	1/4"	- 04	M 14x1,5	8	4,0	36,5	3,8	15,0	17
M21343-04-16	6	1/4"	- 04	M 16x1,5	10	4,0	36,5	4,0	15,0	19
M21342-05-14	8	5/16"	- 05	M 14x1,5	8	4,0	40,0	3,9	19,5	17
M21343-05-16	8	5/16"	- 05	M 16x1,5	10	5,5	39,0	4,0	15,0	19
M21342-06-16	10	3/8"	- 06	M 16x1,5	10	4,0	46,0	5,0	20,0	19
M21343-06-18	10	3/8"	- 06	M 18x1,5	12	7,0	42,0	4,0	15,5	22
M21343-06-22	10	3/8"	- 06	M 22x1,5	15	7,0	42,5	5,2	15,5	27
M21343-08-22	12	1/2"	- 08	M 22x1,5	15	9,3	49,5	5,2	17,0	27
M21343-10-26	16	5/8"	- 10	M 26x1,5	18	12,5	60,0	5,5	24,0	32

M11110

METRIC MALE 24° CONE SEAT LIGHT DUTY - DIN 20066 / ISO 12151-2
 MACHO METRICO ASIEN TO A 24° SERIE LIGERA DIN 20066 / ISO 12151-2
 CEL - DIN 20066 / ISO 12151-2
 MASCHIO METRICO 24° SERIE LEGGERA - DIN 20066 / ISO 12151-2

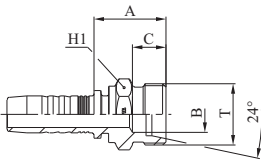

PART. REF.	HOSE BORE			THREAD	PIPE	DIMENSIONS mm					
	DN	inch	Size			T	B	A	C	H ₁	H ₂
M11110-03-12	5	3/16"	- 03	M 12x1,5	6	3,0	21,0	10,0		14	
M11110-04-12	6	1/4"	- 04	M 12x1,5	6	4,0	21,5	10,0		14	
M11110-04-14	6	1/4"	- 04	M 14x1,5	8	4,0	21,5	10,0		14	
M11110-04-16	6	1/4"	- 04	M 16x1,5	10	7,0	23,5	11,0		17	
M11110-04-18	6	1/4"	- 04	M 18x1,5	12	9,0	23,5	11,0		19	
M11110-05-16	8	5/16"	- 05	M 16x1,5	10	7,0	24,0	11,0		17	
M11110-05-18	8	5/16"	- 05	M 18x1,5	12	9,0	24,0	11,0		19	
M11110-06-16	10	3/8"	- 06	M 16x1,5	10	7,0	24,1	11,0		17	
M11110-06-18	10	3/8"	- 06	M 18x1,5	12	9,0	24,6	11,0		19	
M11110-06-22	10	3/8"	- 06	M 22x1,5	15	10,0	25,6	12,0		22	
M11110-06-26	10	3/8"	- 06	M 26x1,5	18	12,5	26,5	12,0		27	
M11110-08-16	12	1/2"	- 08	M 16x1,5	10	7,0	24,5	11,0		22	
M11110-08-18	12	1/2"	- 08	M 18x1,5	12	9,3	24,5	11,0		22	
M11110-08-22	12	1/2"	- 08	M 22x1,5	15	10,0	25,6	12,0		22	
M11110-08-26	12	1/2"	- 08	M 26x1,5	18	12,5	26,4	12,0		27	
M11110-10-22	16	5/8"	- 10	M 22x1,5	15	10,0	25,5	12,0		22	
M11110-10-26	16	5/8"	- 10	M 26x1,5	18	12,5	26,7	12,0		27	
M11110-10-30	16	5/8"	- 10	M 30x2	22	15,0	28,5	14,0		30	
M11110-12-26	19	3/4"	- 12	M 26x1,5	18	15,0	28,5	12,0		27	
M11110-12-30	19	3/4"	- 12	M 30x2	22	15,0	30,0	14,0		30	
M11110-12-36	19	3/4"	- 12	M 36x2	28	19,8	31,2	14,0		36	
M11110-16-36	25	1"	- 16	M 36x2	28	20,0	32,3	14,0		36	
M11110-20-45	31	1.1/4"	- 20	M 45x2	35	26,0	40,5	16,0		46	
M11110-24-52	38	1.1/2"	- 24	M 52x2	42	32,0	42,6	16,0		55	

DIN STANDARD CONNECTIONS

M21512

METRIC O-RING FEMALE 24° CONE LIGHT DUTY - DIN 20066 / ISO 12151-2 (THRUST-WIRE NUT)
 HEMBRA METRICA CON O-RING ASIEN TO A 24° SERIE LIGERA DIN 20066 / ISO 12151-2 (TUERCA CON SEGURO)
 DKOL - DIN 20066 / ISO 12151-2 (GESTIFTETE MUTTER)
 FEMMINA METRICA CONO 24° O-RING SERIE LEGGERA DIN 20066 / ISO 12151-2 (DADO SPINATO)

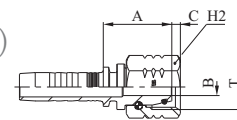

M21513

METRIC O-RING FEMALE 24° CONE LIGHT DUTY - DIN 20066 / ISO 12151-2 (SLIP-ON NUT)
 HEMBRA METRICA CON O-RING ASIEN TO A 24° SERIE LIGERA DIN 20066 / ISO 12151-2 (TUERCA LIBRE)
 DKOL - DIN 20066 / ISO 12151-2 (HINTERLEGTE MUTTER)
 FEMMINA METRICA CONO 24° O-RING SERIE LEGGERA DIN 20066 / ISO 12151-2 (DADO PASSANTE)

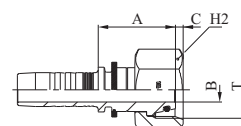

PART. REF.	HOSE BORE			THREAD	PIPE	DIMENSIONS mm				
	DN	inch	Size			T	mm	B	A	C
M21513-03-12	5	3/16"	- 03	M 12x1,5	6	3,0	21,9	1,7		14
M21513-03-14	5	3/16"	- 03	M 14x1,5	8	4,5	24,5	1,7		17
M21512-04-12	6	1/4"	- 04	M 12x1,5	6	3,0	21,1	2,2		17
M21513-04-14	6	1/4"	- 04	M 14x1,5	8	4,0	22,1	1,7		17
M21513-04-16	6	1/4"	- 04	M 16x1,5	10	6,0	22,6	2,1		19
M21513-04-18	6	1/4"	- 04	M 18x1,5	12	7,0	21,9	2,3		22
M21512-05-14	8	5/16"	- 05	M 14x1,5	8	4,0	20,0	1,7		17
M21513-05-16	8	5/16"	- 05	M 16x1,5	10	6,0	22,6	2,1		19
M21513-05-18	8	5/16"	- 05	M 18x1,5	12	7,0	21,9	2,3		22
M21512-06-16	10	3/8"	- 06	M 16x1,5	10	6,0	23,1	3,0		19
M21513-06-18	10	3/8"	- 06	M 18x1,5	12	7,0	22,4	2,3		22
M21513-06-22	10	3/8"	- 06	M 22x1,5	15	9,3	25,0	2,3		27
M21512-08-18	12	1/2"	- 08	M 18x1,5	12	7,0	29,0	2,9		22
M21513-08-22	12	1/2"	- 08	M 22x1,5	15	9,3	25,4	2,3		27
M21513-08-26	12	1/2"	- 08	M 26x1,5	18	12,5	26,1	2,5		32
M21512-10-18	16	5/8"	- 10	M 18x1,5	12	7,0	29,0	2,9		22
M21512-10-22	16	5/8"	- 10	M 22x1,5	15	9,5	26,5	2,4		27
M21513-10-26	16	5/8"	- 10	M 26x1,5	18	12,5	26,0	2,5		32
M21513-10-30	16	5/8"	- 10	M 30x2	22	15,0	34,0	3,6		36
M21513-10-36	16	5/8"	- 10	M 36x2	28	20,0	30,5	3,8		41
M21512-12-26	19	3/4"	- 12	M 26x1,5	18	12,5	31,1	3,6		32
M21513-12-30	19	3/4"	- 12	M 30x2	22	15,0	28,2	3,6		36
M21513-12-36	19	3/4"	- 12	M 36x2	28	20,0	28,3	3,8		41
M21512-16-30	25	1"	- 16	M 30x2	22	15,0	34,0	3,6		36
M21513-16-36	25	1"	- 16	M 36x2	28	19,8	29,4	3,8		41
M21513-16-45	25	1"	- 16	M 45x2	35	26,0	39,0	5,1		50
M21512-20-36	31	1.1/4"	- 20	M 36x2	28	19,8	35,5	5,0		41
M21513-20-45	31	1.1/4"	- 20	M 45x2	35	26,0	32,9	5,1		50
M21513-20-52	31	1.1/4"	- 20	M 52x2	42	32,0	32,5	5,1		60
M21512-24-45	38	1.1/2"	- 24	M 45x2	35	26,0	42,5	5,8		50
M21513-24-52	38	1.1/2"	- 24	M 52x2	42	32,0	32,8	5,1		60

M21592

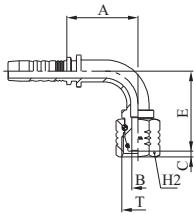

90° METRIC O-RING FEMALE SWEEP ELBOW 24° CONE LIGHT DUTY
 DIN 20066 / ISO 12151-2 (THRUST-WIRE NUT)
 HEMBRA METRICA CON O-RING CODO DE 90° ASIEN TO A 24° SERIE LIGERA
 DIN 20066 / ISO 12151-2 (TUERCA CON SEGURO)
 DKOL 90° BOGEN - DIN 20066 / ISO 12151-2 (GESTIFTETE MUTTER)
 FEMMINA METRICA 90° CONO 24° O-RING SERIE LEGGERA DIN 20066 / ISO 12151-2 (DADO SPINATO)

M21593

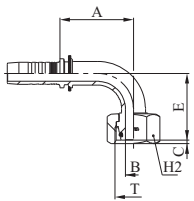

90° METRIC O-RING FEMALE SWEEP ELBOW 24° CONE LIGHT DUTY
 DIN 20066 / ISO 12151-2 (SLIP-ON NUT)
 HEMBRA METRICA CON O-RING CODO DE 90° ASIEN TO A 24° SERIE LIGERA
 DIN 20066 / ISO 12151-2 (TUERCA LIBRE)
 DKOL 90° BOGEN - DIN 20066 / ISO 12151-2 (HINTERLEGTE MUTTER)
 FEMMINA METRICA 90° CONO 24° O-RING SERIE LEGGERA DIN 20066 / ISO 12151-2 (DADO PASSANTE)

PART. REF.	HOSE BORE			THREAD	PIPE	DIMENSIONS mm				
	DN	inch	Size			T	mm	B	A	C
M21593-03-12	5	3/16"	- 03	M 12x1,5	6	3,0	26,0	1,7	30,0	14
M21593-03-14	5	3/16"	- 03	M 14x1,5	8	4,0	29,0	1,7	31,5	17
M21592-04-12	6	1/4"	- 04	M 12x1,5	6	3,0	28,5	2,2	32,5	17
M21593-04-14	6	1/4"	- 04	M 14x1,5	8	4,0	29,5	1,7	31,5	17
M21593-04-16	6	1/4"	- 04	M 16x1,5	10	6,0	29,5	2,1	32,0	19
M21593-04-18	6	1/4"	- 04	M 18x1,5	12	7,0	29,5	2,3	33,0	22
M21592-05-14	8	5/16"	- 05	M 14x1,5	8	4,0	31,0	1,7	33,0	17
M21593-05-16	8	5/16"	- 05	M 16x1,5	10	6,0	32,0	2,1	32,5	19
M21593-05-18	8	5/16"	- 05	M 18x1,5	12	7,0	32,0	2,3	32,5	22
M21593-05-22	8	5/16"	- 05	M 22x1,5	15	9,3	36,0	2,3	35,0	27
M21592-06-16	10	3/8"	- 06	M 16x1,5	10	6,0	35,5	3,0	40,0	19
M21593-06-18	10	3/8"	- 06	M 18x1,5	12	7,0	36,5	2,3	33,5	22
M21593-06-22	10	3/8"	- 06	M 22x1,5	15	9,3	36,5	2,3	35,0	27
M21592-08-18	12	1/2"	- 08	M 18x1,5	12	7,0	44,0	2,9	48,0	22
M21593-08-22	12	1/2"	- 08	M 22x1,5	15	9,3	45,0	2,3	39,5	27
M21593-08-26	12	1/2"	- 08	M 26x1,5	18	12,5	45,0	2,5	40,0	32
M21592-10-22	16	5/8"	- 10	M 22x1,5	15	9,3	53,5	3,0	57,5	27
M21593-10-26	16	5/8"	- 10	M 26x1,5	18	12,5	51,5	2,5	53,0	32
M21593-10-30	16	5/8"	- 10	M 30x2	22	15,0	51,5	3,6	54,0	36
M21592-12-26	19	3/4"	- 12	M 26x1,5	18	12,5	61,5	3,6	63,0	32
M21593-12-30	19	3/4"	- 12	M 30x2	22	15,0	61,5	3,6	59,0	36
M21593-12-36	19	3/4"	- 12	M 36x2	28	19,8	61,5	3,8	61,0	41
M21592-16-30	25	1"	- 16	M 30x2	22	15,0	79,5	3,6	80,5	36
M21593-16-36	25	1"	- 16	M 36x2	28	19,8	76,5	3,8	69,5	41
M21593-16-45	25	1"	- 16	M 45x2	35	26,0	79,0	5,1	72,0	50
M21592-20-36	31	1.1/4"	- 20	M 36x2	28	19,8	93,5	5,0	92,0	41
M21593-20-45	31	1.1/4"	- 20	M 45x2	35	26,0	93,5	5,1	81,0	50
M21592-24-36	38	1.1/2"	- 24	M 36x2	28	19,8	97,0	5,0	68,0	41
M21593-24-52	38	1.1/2"	- 24	M 52x2	42	32,0	107,5	5,1	98,0	60

DIN STANDARD CONNECTIONS

M21542

45° METRIC O-RING FEMALE SWEPT ELBOW 24° CONE LIGHT DUTY
 DIN 20066 / ISO 12151-2 (THRUST-WIRE NUT)
 HEMBRA METRICA CON O-RING CODO DE 45° ASIENTO A 24° SERIE LIGERA
 DIN 20066 / ISO 12151-2 (TUERCA CON SEGURO)
 DKOL 45° BOGEN - DIN 20066 / ISO 12151-2 (GESTIFTETE MUTTER)
 FEMMINA METRICA 45° CONO 24° O-RING SERIE LEGGERA
 DIN 20066 / ISO 12151-2 (DADO SPINATO)

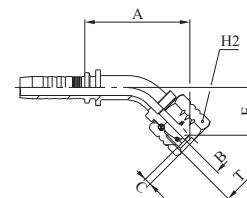

M21543

45° METRIC O-RING FEMALE SWEPT ELBOW 24° CONE LIGHT DUTY
 DIN 20066 / ISO 12151-2 (SLIP-ON NUT)
 HEMBRA METRICA CON O-RING CODO DE 45° ASIENTO A 24° SERIE LIGERA
 DIN 20066 / ISO 12151-2 (TUERCA LIBRE)
 DKOL 45° BOGEN - DIN 20066 / ISO 12151-2 (HINTERLEGTE MUTTER)
 FEMMINA METRICA 45° CONO 24° O-RING SERIE LEGGERA DIN 20066 / ISO 12151-2 (DADO PASSANTE)

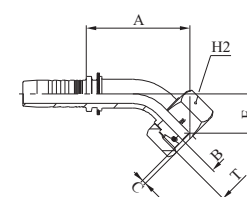

PART. REF.	HOSE BORE			THREAD	PIPE	DIMENSIONS mm					
	DN	inch	Size			T	mm	B	A	C	E
M21543-03-12	5	3/16"	- 03	M 12x1,5	6	3,0	35,0	1,7	16,0		14
M21542-04-12	6	1/4"	- 04	M 12x1,5	6	3,0	39,0	2,2	18,0		17
M21543-04-14	6	1/4"	- 04	M 14x1,5	8	4,0	38,0	1,7	16,5		17
M21543-04-16	6	1/4"	- 04	M 16x1,5	10	6,0	38,0	2,1	17,0		19
M21543-04-18	6	1/4"	- 04	M 18x1,5	12	7,0	38,5	2,3	17,5		22
M21543-05-16	8	5/16"	- 05	M 16x1,5	10	6,0	41,5	2,1	17,5		19
M21543-05-18	8	5/16"	- 05	M 18x1,5	12	7,0	41,5	2,3	17,0		22
M21542-06-16	10	3/8"	- 06	M 16x1,5	10	6,0	47,5	3,0	21,5		19
M21543-06-18	10	3/8"	- 06	M 18x1,5	12	7,0	43,5	2,3	16,5		22
M21543-06-22	10	3/8"	- 06	M 22x1,5	15	9,3	45,0	2,3	18,0		27
M21542-08-18	12	1/2"	- 08	M 18x1,5	12	7,0	56,5	2,9	25,0		22
M21543-08-22	12	1/2"	- 08	M 22x1,5	15	9,3	52,0	2,3	19,0		27
M21543-08-26	12	1/2"	- 08	M 26x1,5	18	12,5	52,5	2,5	19,5		32
M21542-10-22	16	5/8"	- 10	M 22x1,5	15	9,3	65,5	2,4	29,0		27
M21543-10-26	16	5/8"	- 10	M 26x1,5	18	12,5	62,0	2,5	26,5		32
M21542-12-26	19	3/4"	- 12	M 26x1,5	18	12,5	73,0	3,6	31,0		32
M21543-12-30	19	3/4"	- 12	M 30x2	22	15,0	71,0	3,6	28,5		36
M21543-12-36	19	3/4"	- 12	M 36x2	28	19,8	72,0	3,8	30,0		41
M21543-16-36	25	1"	- 16	M 36x2	28	19,8	85,0	3,8	32,0		41
M21542-20-36	31	1.1/4"	- 20	M 36x2	28	19,8	107,5	5,0	44,0		41
M21543-20-45	31	1.1/4"	- 20	M 45x2	35	26,0	99,5	5,1	36,0		50
M21542-24-36	38	1.1/2"	- 24	M 36x2	28	19,8	117,5	5,0	37,0		41
M21543-24-52	38	1.1/2"	- 24	M 52x2	42	32,0	117,0	5,1	44,5		60

M11210

METRIC MALE 24° CONE SEAT HEAVY DUTY - DIN 20066 / ISO 12151-2
 MACHO METRICO ASIEN TO A 24° - SERIE PESADA DIN 20066 / ISO 12151-2
 CES - DIN 20066 / ISO 12151-2
 MASCHIO METRICO 24° - SERIE PESANTE DIN 20066 / ISO 12151-2

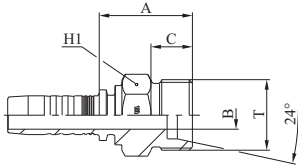

PART. REF.	HOSE BORE			THREAD	PIPE	DIMENSIONS mm				
	DN	inch	Size			T	B	A	C	H ₁
M11210-04-16	6	1/4"	- 04	M 16x1,5	8	4,0	25,5	12,0		17
M11210-04-18	6	1/4"	- 04	M 18x1,5	10	6,0	26,5	12,0		19
M11210-04-20	6	1/4"	- 04	M 20x1,5	12	7,0	29,0	12,0		22
M11210-05-16	8	5/16"	- 05	M 16x1,5	8	5,5	26,0	12,0		17
M11210-05-18	8	5/16"	- 05	M 18x1,5	10	7,0	26,5	12,0		19
M11210-05-20	8	5/16"	- 05	M 20x1,5	12	7,0	29,0	12,0		22
M11210-06-18	10	3/8"	- 06	M 18x1,5	10	7,0	27,1	12,0		19
M11210-06-20	10	3/8"	- 06	M 20x1,5	12	7,0	29,1	12,0		22
M11210-06-22	10	3/8"	- 06	M 22x1,5	14	8,0	31,1	14,0		22
M11210-08-22	12	1/2"	- 08	M 22x1,5	14	9,3	31,5	14,0		22
M11210-08-24	12	1/2"	- 08	M 24x1,5	16	9,3	31,6	14,0		24
M11210-10-30	16	5/8"	- 10	M 30x2	20	15,0	35,7	16,0		30
M11210-10-36	16	5/8"	- 10	M 36x2	25	19,8	40,0	18,0		36
M11210-12-30	19	3/4"	- 12	M 30x2	20	15,0	37,0	16,0		30
M11210-12-36	19	3/4"	- 12	M 36x2	25	19,8	41,0	18,0		36
M11210-16-36	25	1"	- 16	M 36x2	25	19,8	42,3	18,0		36
M11210-16-42	25	1"	- 16	M 42x2	30	25,0	44,3	20,0		46
M11210-20-52	31	1.1/4"	- 20	M 52x2	38	30,0	50,5	22,0		55

DIN STANDARD CONNECTIONS

M21612

METRIC O-RING FEMALE 24° CONE HEAVY DUTY

DIN 20066 / ISO 12151-2 (THRUST-WIRE NUT)

HEMBRA METRICA CON O-RING ASIEN TO A 24° SERIE PESADA

DIN 20066 / ISO 12151-2 (TUERCA CON SEGURO)

DKOS - DIN 20066 / ISO 12151-2 (GESTIFTETE MUTTER)

FEMMINA METRICA CONO 24° O-RING SERIE PESANTE

DIN 20066 / ISO 12151-2 (DADO SPINATO)

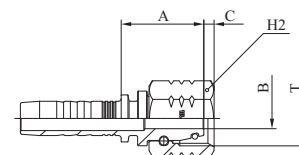

M21613

METRIC O-RING FEMALE 24° CONE HEAVY DUTY - DIN 20066 / ISO 12151-2 (SLIP-ON NUT)

HEMBRA METRICA CON O-RING ASIEN TO A 24° SERIE PESADA

DIN 20066 / ISO 12151-2 (TUERCA LIBRE)

DKOS - DIN 20066 / ISO 12151-2 (HINTERLEGTE MUTTER)

FEMMINA METRICA CONO 24° O-RING SERIE PESANTE

DIN 20066 / ISO 12151-2 (DADO PASSANTE)

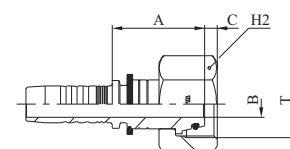

PART. REF.	HOSE BORE			THREAD	PIPE	DIMENSIONS mm				
	DN	inch	Size			T	mm	B	A	C
M21613-03-14	5	3/16"	- 03	M 14x1,5	6	2,5	25,5	3,5		17
M21613-03-16	5	3/16"	- 03	M 16x1,5	8	3,2	21,9	3,4		19
M21613-04-14	6	1/4"	- 04	M 14x1,5	6	3,0	23,5	3,5		17
M21613-04-16	6	1/4"	- 04	M 16x1,5	8	4,0	22,2	3,4		19
M21613-04-18	6	1/4"	- 04	M 18x1,5	10	4,0	28,0	3,0		22
M21613-04-20	6	1/4"	04	M 20x1,5	12	7,0	25,7	2,5		24
M21613-05-18	8	5/16"	- 05	M 18x1,5	10	5,5	28,0	3,0		22
M21613-05-20	8	5/16"	- 05	M 20x1,5	12	5,5	24,8	2,5		24
M21613-06-18	10	3/8"	- 06	M 18x1,5	10	7,0	28,5	3,0		22
M21613-06-20	10	3/8"	- 06	M 20x1,5	12	7,0	25,3	2,5		24
M21613-06-22	10	3/8"	- 06	M 22x1,5	14	7,0	32,6	3,0		27
M21613-06-24	10	3/8"	- 06	M 24x1,5	16	7,0	32,0	3,0		30
M21612-08-20	12	1/2"	- 08	M 20x1,5	12	7,0	29,0	2,5		24
M21612-08-22	12	1/2"	- 08	M 22x1,5	14	7,0	27,5	2,5		27
M21613-08-24	12	1/2"	- 08	M 24x1,5	16	9,3	26,7	3,0		30
M21613-08-30	12	1/2"	- 08	M 30x2	20	12,5	37,0	3,5		36
M21612-10-24	16	5/8"	- 10	M 24x1,5	16	9,3	29,5	4,0		30
M21613-10-30	16	5/8"	- 10	M 30x2	20	12,5	30,6	3,5		36
M21613-10-36	16	5/8"	- 10	M 36x2	25	15,0	40,0	4,5		41
M21612-12-24	19	3/4"	- 12	M 24x1,5	16	9,3	30,5	4,0		30
M21612-12-30	19	3/4"	- 12	M 30x2	20	12,5	33,5	2,2		36
M21613-12-36	19	3/4"	- 12	M 36x2	25	15,0	34,1	4,5		41
M21612-16-30	25	1"	- 16	M 30x2	20	12,5	34,5	2,2		36
M21612-16-36	25	1"	- 16	M 36x2	25	15,0	35,3	1,7		41
M21613-16-42	25	1"	- 16	M 42x2	30	19,8	35,4	6,3		50
M21613-20-52	31	1.1/4"	- 20	M 52x2	38	26,0	37,5	8,0		60
M21613-24-52	38	1.1/2"	- 24	M 52x2	38	26,0	49,6	8,0		60

M21692

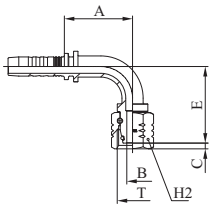

90° METRIC O-RING FEMALE SWEEP ELBOW 24° CONE HEAVY DUTY
 DIN 20066 / ISO 12151-2 (THRUST-WIRE NUT)
 HEMBRA METRICA CON O-RING CODO DE 90° ASIEN TO A 24° SERIE PESADA
 DIN 20066 / ISO 12151-2 (TUERCA CON SEGURO)
 DKOS 90° BOGEN - DIN 20066 / ISO 12151-2 (GESTIFTETE MUTTER)
 FEMMINA METRICA 90° CONO 24° O-RING SERIE PESANTE DIN 20066 / ISO 12151-2 (DADO SPINATO)

M21693

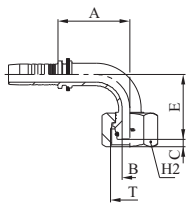

90° METRIC O-RING FEMALE SWEEP ELBOW 24° CONE HEAVY DUTY
 DIN 20066 / ISO 12151-2 (SLIP-ON NUT)
 HEMBRA METRICA CON O-RING CODO DE 90° ASIEN TO A 24° SERIE PESADA
 DIN 20066 / ISO 12151-2 (TUERCA LIBRE)
 DKOS 90° BOGEN - DIN 20066 / ISO 12151-2 (HINTERLEGTE MUTTER)
 FEMMINA METRICA 90° CONO 24° O-RING SERIE PESANTE DIN 20066 / ISO 12151-2 (DADO PASSANTE)

PART. REF.	HOSE BORE			THREAD	PIPE	DIMENSIONS mm				
------------	-----------	--	--	--------	------	---------------	--	--	--	--

	DN	inch	Size	T	mm	B	A	C	E	H ₂
M21693-03-14	5	3/16"	- 03	M 14x1,5	6	3,0	26,0	3,5	30,0	17
M21693-03-16	5	3/16"	- 03	M 16x1,5	8	3,0	26,0	3,4	29,5	19
M21693-04-14	6	1/4"	- 04	M 14x1,5	6	3,0	29,5	3,5	32,5	17
M21693-04-16	6	1/4"	- 04	M 16x1,5	8	4,0	29,5	3,4	29,5	19
M21693-04-18	6	1/4"	- 04	M 18x1,5	10	4,0	29,5	3,0	31,0	22
M21693-04-20	6	1/4"	- 04	M 20x1,5	12	5,5	29,5	2,5	34,5	24
M21693-05-18	8	5/16"	- 05	M 18x1,5	10	4,0	32,0	3,0	33,5	22
M21693-05-20	8	5/16"	- 05	M 20x1,5	12	5,5	32,0	2,5	34,0	24
M21692-06-18	10	3/8"	- 06	M 18x1,5	10	4,0	35,5	3,9	42,5	22
M21693-06-20	10	3/8"	- 06	M 20x1,5	12	7,0	36,5	2,5	35,0	24
M21693-06-22	10	3/8"	- 06	M 22x1,5	14	7,0	36,5	3,0	37,0	27
M21693-06-24	10	3/8"	- 06	M 24x1,5	16	9,3	36,5	3,0	36,0	30
M21692-08-22	12	1/2"	- 08	M 22x1,5	14	7,0	44,0	2,5	48,5	27
M21693-08-24	12	1/2"	- 08	M 24x1,5	16	9,3	45,0	3,0	40,5	30
M21693-08-30	12	1/2"	- 08	M 30x2	20	12,5	45,0	3,5	44,5	36
M21692-10-24	16	5/8"	- 10	M 24x1,5	16	9,3	55,0	4,0	60,0	30
M21693-10-30	16	5/8"	- 10	M 30x2	20	12,5	51,5	3,5	57,5	36
M21692-12-30	19	3/4"	- 12	M 30x2	20	12,5	61,5	2,2	67,5	36
M21693-12-36	19	3/4"	- 12	M 36x2	25	15,0	61,5	4,5	64,5	41
M21692-16-36	25	1"	- 16	M 36x2	25	15,0	79,5	1,7	86,0	41
M21693-16-42	25	1"	- 16	M 42x2	30	19,8	79,0	6,3	74,5	50
M21693-20-52	31	1.1/4"	- 20	M 52x2	38	26,0	93,5	8,0	85,5	60
M21692-24-52	38	1.1/2"	- 24	M 52x2	38	24,7	91,5	8,8	95,5	60

DIN STANDARD CONNECTIONS

M21642

45° METRIC O-RING FEMALE SWEEP ELBOW 24° CONE HEAVY DUTY
 DIN 20066 / ISO 12151-2 (THRUST-WIRE NUT)
 HEMBRA METRICA CON O-RING CODO DE 45° CONO 24° SERIE PESADA
 DIN 20066 / ISO 12151-2 (TUERCA CON SEGURO)
 DKOS 45° BOGEN - DIN 20066 / ISO 12151-2 (GESTIFTETE MUTTER)
 FEMMINA METRICA 45° CONO 24° O-RING SERIE PESANTE
 DIN 20066 / ISO 12151-2 (DADO SPINATO)

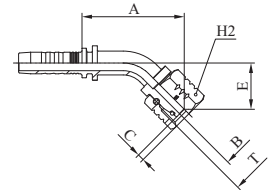

M21643

45° METRIC O-RING FEMALE SWEEP ELBOW 24° CONE HEAVY DUTY
 DIN 20066 / ISO 12151-2 (SLIP-ON NUT)
 HEMBRA METRICA CON O-RING CODO DE 45° ASIEN TO A 24° SERIE PESADA
 DIN 20066 / ISO 12151-2 (TUERCA LIBRE)
 DKOS 45° BOGEN - DIN 20066 / ISO 12151-2 (HINTERLEGTE MUTTER)
 FEMMINA METRICA 45° CONO 24° O-RING SERIE PESANTE
 DIN 20066 / ISO 12151-2 (DADO PASSANTE)

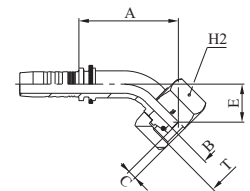

PART. REF.	HOSE BORE			THREAD	PIPE	DIMENSIONS mm					
	DN	inch	Size			T	mm	B	A	C	E
M21643-04-14	6	1/4"	- 04	M 14x1,5	6	3,0	38,5	3,5	17,5		17
M21643-04-16	6	1/4"	- 04	M 16x1,5	8	4,0	36,0	3,4	15,0		19
M21643-04-18	6	1/4"	- 04	M 18x1,5	10	4,0	37,5	3,0	16,5		22
M21643-05-18	8	5/16"	- 05	M 18x1,5	10	4,0	42,5	3,0	18,0		22
M21643-05-20	8	5/16"	- 05	M 20x1,5	12	5,5	42,5	2,5	18,5		24
M21642-06-18	10	3/8"	- 06	M 18x1,5	10	4,0	49,0	3,9	23,0		22
M21643-06-20	10	3/8"	- 06	M 20x1,5	12	7,0	45,0	2,5	18,0		24
M21643-06-22	10	3/8"	- 06	M 22x1,5	14	7,0	46,5	3,0	19,5		27
M21642-08-22	12	1/2"	- 08	M 22x1,5	14	7,0	57,5	2,5	25,5		27
M21643-08-24	12	1/2"	- 08	M 24x1,5	16	9,3	52,5	3,0	20,0		30
M21643-10-30	16	5/8"	- 10	M 30x2	20	12,5	65,5	3,5	29,5		36
M21642-12-30	19	3/4"	- 12	M 30x2	20	12,5	76,5	2,2	34,0		36
M21643-12-36	19	3/4"	- 12	M 36x2	25	15,0	75,0	4,5	32,5		41
M21642-16-36	25	1"	- 16	M 36x2	25	15,0	98,0	1,7	43,5		41
M21643-16-42	25	1"	- 16	M 42x2	30	19,8	90,0	6,3	35,5		50
M21643-20-52	31	1.1/4"	- 20	M 52x2	38	26,0	103,0	8,0	39,5		60

M11710

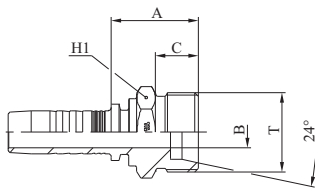

FRENCH METRIC MALE 24° CONE SEAT MILLIMETRIC TYPE
 MACHO METRICO FRANCES ASIEN TO A 24° TIPO MILIMETRICO
 AGFM 24° INNENKONUS (FR. REIHE MILL.)
 MASCHIO METRICO 24° SERIE MILLIMETRICA FRANCESE

PART. REF.	HOSE BORE			THREAD	PIPE	DIMENSIONS mm				
	DN	inch	Size			T	mm	B	A	C
M11710-10-2718	16	5/8"	- 10	M 27x1,5	18	12,5	28,7	14,0		28
M11710-10-2720	16	5/8"	- 10	M 27x1,5	20	12,5	28,7	14,0		28
M11710-12-30	19	3/4"	- 12	M 30x1,5	22	15,0	30,0	14,0		30
M11710-12-33	19	3/4"	- 12	M 33x1,5	25	15,0	31,0	14,0		34

M21713

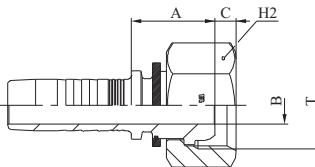

FRENCH METRIC FEMALE MILLIMETRIC TYPE (SLIP-ON NUT)
 HEMBRA METRICA FRANCES TIPO MILIMETRICO (TUERCA LIBRE)
 DKFM (FR. REIHE MILL., HINTERLEGTE MUTTER)
 FEMMINA METRICA SERIE MILLIMETRICA FRANCESE (DADO PASSANTE)

PART. REF.	HOSE BORE			THREAD	PIPE	DIMENSIONS mm				
	DN	inch	Size			T	mm	B	A	C
M21713-10-2718	16	5/8"	- 10	M 27x1,5	18	12,5	22,2	5,1		32
M21713-10-2720	16	5/8"	- 10	M 27x1,5	20	12,5	22,2	5,1		32
M21713-12-30	19	3/4"	- 12	M 30x1,5	22	15,0	25,5	4,1		36
M21713-12-33	19	3/4"	- 12	M 33x1,5	25	15,0	25,5	4,1		38
M21713-16-36	25	1"	- 16	M 36x1,5	28	19,8	27,8	4,8		41
M21713-16-39	25	1"	- 16	M 39x1,5	30	19,8	28,3	4,3		46

M11810

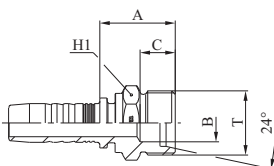

FRENCH METRIC MALE 24° CONE SEAT GAZ TYPE
 MACHO METRICO FRANCES ASIEN TO A 24° TIPO GAZ
 AGF 24° INNENKONUS (FR. REIHE GAS)
 MASCHIO METRICO 24° SERIE GAZ FRANCESE

PART. REF.	HOSE BORE			THREAD	PIPE	DIMENSIONS mm				
	DN	inch	Size			T	mm	B	A	C
M11810-05-20	8	5/16"	- 05	M 20x1,5	13,25	8,0	27,0	12,0		22
M11810-06-20	10	3/8"	- 06	M 20x1,5	13,25	8,0	27,6	12,0		22
M11810-06-24	10	3/8"	- 06	M 24x1,5	16,75	12,0	28,1	12,0		24
M11810-08-24	12	1/2"	- 08	M 24x1,5	16,75	12,0	28,4	12,0		24
M11810-10-30	16	5/8"	- 10	M 30x1,5	21,25	15,0	31,7	14,0		30
M11810-12-36	19	3/4"	- 12	M 36x1,5	26,75	21,0	34,0	14,0		36
M11810-16-45	25	1"	- 16	M 45x1,5	33,50	26,0	39,3	16,0		46

NF STANDARD CONNECTIONS

M21813

FRENCH METRIC FEMALE GAZ TYPE (SLIP-ON NUT)
 HEMBRA METRICA FRANCES TIPO GAZ (TUERCA LIBRE)
 DKF (FR. REIHE GAS, HINTERLEGTE MUTTER)
 FEMMINA METRICA SERIE GAZ FRANCESE (DADO PASSANTE)

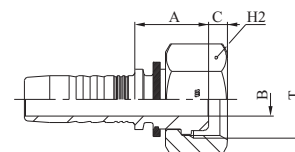

PART. REF.	HOSE BORE			THREAD	PIPE	DIMENSIONS mm				
	DN	inch	Size			T	mm	B	A	C
M21813-04-20	6	1/4"	- 04	M 20x1,5	13,25	7,0	22,1	4,3		24
M21813-05-20	8	5/16"	- 05	M 20x1,5	13,25	7,0	22,1	4,3		24
M21813-06-20	10	3/8"	- 06	M 20x1,5	13,25	7,0	22,6	4,3		24
M21813-06-24	10	3/8"	- 06	M 24x1,5	16,75	9,3	25,6	4,0		30
M21813-08-24	12	1/2"	- 08	M 24x1,5	16,75	9,3	26,5	4,0		30
M21813-08-30	12	1/2"	- 08	M 30x1,5	21,25	12,5	23,6	5,1		36
M21813-10-30	16	5/8"	- 10	M 30x1,5	21,25	12,5	23,7	5,1		36
M21813-12-36	19	3/4"	- 12	M 36x1,5	26,75	15,0	27,0	4,8		41
M21813-16-45	25	1"	- 16	M 45x1,5	33,50	19,8	26,8	4,6		50

M21893

90° FRENCH METRIC FEMALE GAZ TYPE (SLIP-ON NUT)
 HEMBRA METRICA FRANCES CODO DE 90° TIPO GAZ (TUERCA LIBRE)
 DKF 90° BOGEN (FR. REIHE MILL., HINTERLEGTE MUTTER)
 FEMMINA METRICA 90° SERIE GAZ FRANCESE (DADO PASSANTE)

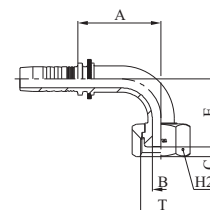

PART. REF.	HOSE BORE			THREAD	PIPE	DIMENSIONS mm				
	DN	inch	Size			T	mm	B	A	C
M21893-05-20	8	5/16"	- 05	M 20x1,5	13,25	7,0	32,0	4,3	29,5	24
M21893-06-20	10	3/8"	- 06	M 20x1,5	13,25	7,0	36,5	4,3	33,5	24
M21893-08-24	12	1/2"	- 08	M 24x1,5	16,75	12,0	45,0	4,0	41,0	30
M21893-10-30	16	5/8"	- 10	M 30x1,5	21,25	12,5	51,5	5,1	53,5	36
M21893-12-36	19	3/4"	- 12	M 36x1,5	26,75	15,0	61,5	4,8	60,0	41

M24011

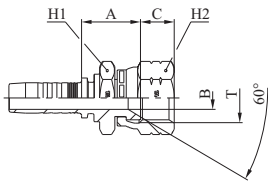

JIS METRIC FEMALE 60° CONE SEAT (KOMATSU) JIS B 8363 (CRIMPED-BACK NUT)
 HEMBRA METRICA JIS ASIEN TO A 60° (KOMATSU) JIS B 8363 (TUERCA PRENSADA)
 DK KOMATSU MIT 60° KONUS (NACH JIS B 8363, PRESSMUTTER)
 FEMMINA METRICA GIAPPONESE CONO 60° TIPO KOMATSU JIS B 8363 (DADO PRESSATO)

M24012

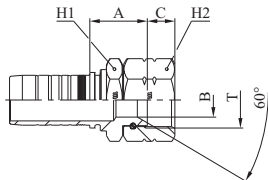

JIS METRIC FEMALE 60° CONE SEAT (KOMATSU) JIS B 8363 (THRUST-WIRE NUT)
 HEMBRA METRICA JIS ASIEN TO A 60° (KOMATSU) JIS B 8363 (TUERCA CON SEGURO)
 DK KOMATSU MIT 60° KONUS (NACH JIS B 8363, GESTIFTETE MUTTER)
 FEMMINA METRICA GIAPPONESE CONO 60° TIPO KOMATSU JIS B 8363 (DADO SPINATO)

PART. REF.	HOSE BORE			THREAD	DIMENSIONS mm					
	DN	inch	Size		T	B	A	C	H ₁	H ₂
M24011-04-14	6	1/4"	- 04	M 14x1,5	4,0	23,0	10,5		19	19
M24011-04-18	6	1/4"	- 04	M 18x1,5	4,0	22,6	11,5		24	24
M24011-05-16	8	5/16"	- 05	M 16x1,5	5,5	22,5	9,3		21	21
M24011-06-14	10	3/8"	- 06	M 14x1,5	4,0	23,6	10,5		19	19
M24011-06-18	10	3/8"	- 06	M 18x1,5	7,0	23,6	11,5		24	24
M24011-08-22	12	1/2"	- 08	M 22x1,5	9,3	24,9	14,0		27	27
M24011-10-24	16	5/8"	- 10	M 24x1,5	12,5	26,7	15,1		32	32
M24011-12-30	19	3/4"	- 12	M 30x1,5	15,0	31,5	18,3		36	36
M24011-16-33	25	1"	- 16	M 33x1,5	19,8	33,3	21,3		41	41
M24011-20-36	31	1.1/4"	- 20	M 36x1,5	19,8	41,0	20,0		46	46
M24012-24-42	38	1.1/2"	- 24	M 42x1,5	26,0	44,0	18,8		55	55

JIS STANDARD CONNECTIONS

M23811

JIS BSP FEMALE 60° CONE SEAT (TOYOTA) - JIS B 8363 (CRIMPED-BACK NUT)
 HEMBRA JIS BSP ASIENTO A 60° (TOYOTA) - JIS B 8363 (TUERCA PRENSADA)
 DK TOYOTA MIT 60° KONUS MIT KONTERSECHSKANT (NACH JIS B 8363, PRESSMUTTER)
 FEMMINA GAS GIAPPONESE CONO 60° TIPO TOYOTA JIS B 8363 (DADO PRESSATO)

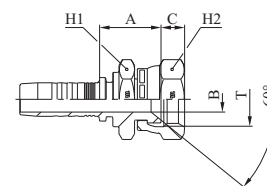

PART. REF.	HOSE BORE			THREAD	DIMENSIONS mm					
	DN	inch	Size		T	B	A	C	H ₁	H ₂
M23811-04-04	6	1/4"	- 04	1/4" - 19	4,0	18,5	8,3		19	19
M23811-06-06	10	3/8"	- 06	3/8" - 19	7,0	23,1	10,0		22	22
M23811-08-08	12	1/2"	- 08	1/2" - 14	9,3	23,0	11,5		27	27
M23811-12-12	19	3/4"	- 12	3/4" - 14	15,0	26,0	13,5		32	32
M23811-16-16	25	1"	- 16	1" - 11	19,8	30,3	14,5		38	38

M20711

JIS BSP FEMALE 60° CONE (NISSAN) - JIS B 8363 (CRIMPED-BACK NUT)
 HEMBRA JIS BSP ASIENTO A 60° (NISSAN) - JIS B 8363 (TUERCA PRENSADA)
 DK NISSAN MIT 60° KONUS MIT KONTERSECHSKANT (NACH JIS B 8363, PRESSMUTTER)
 FEMMINA GIAPPONESE CONO 60° TIPO NISSAN JIS B 8363 (DADO PRESSATO)

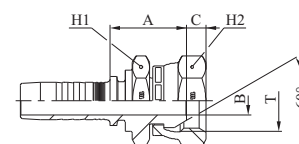

M20712

JIS BSP FEMALE 60° CONE (NISSAN) - JIS B 8363 (THRUST-WIRE NUT)
 HEMBRA JIS BSP ASIENTO A 60° (NISSAN) - JIS 8363 (TUERCA CON SEGURO)
 DK NISSAN MIT 60° KONUS MIT KONTERSECHSKANT (NACH JIS B 8363, GESTIFTETE MUTTER)
 FEMMINA GIAPPONESE CONO 60° TIPO NISSAN JIS B 8363 (DADO SPINATO)

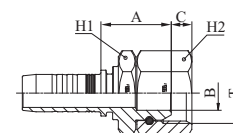

PART. REF.	HOSE BORE			THREAD	DIMENSIONS mm					
	DN	inch	Size		T	B	A	C	H ₁	H ₂
M20711-04-04	6	1/4"	- 04	1/4" - 19	4,0	22,5	4,5		19	19
M20711-06-06	10	3/8"	- 06	3/8" - 19	7,0	24,6	6,4		22	22
M20711-08-08	12	1/2"	- 08	1/2" - 14	9,3	26,4	6,7		27	27
M20712-10-08	16	5/8"	- 10	1/2" - 14	9,3	28,8	6,5		27	27
M20712-10-12	16	5/8"	- 10	3/4" - 14	15,0	30,7	9,0		32	32
M20711-12-12	19	3/4"	- 12	3/4" - 14	15,0	30,0	8,9		32	32
M20712-16-16	25	1"	- 16	1" - 11	19,8	35,5	10,5		38	38

M24111

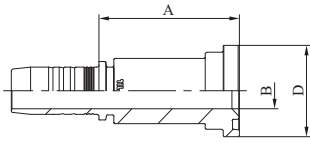

STRAIGHT KOMATSU FLANGE
BRIDA RECTA KOMATSU
FLANSCH GERADE KOMATSU
FLANGIA DRITTA SERIE KOMATSU

PART. REF.	HOSE BORE			FLANGE	DIMENSIONS mm					
	DN	inch	Size		B	A	D			
M24111-08-10	12	1/2"	- 08	5/8"	14,0	66,0	34,0			
M24111-10-10	16	5/8"	- 10	5/8"	14,0	65,7	34,0			
M24111-12-10	19	3/4"	- 12	5/8"	14,0	66,5	34,0			

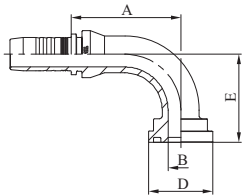

M24191

90° KOMATSU FLANGE
BRIDA KOMATSU CODO DE 90°
FLANSCH 90° BOGEN KOMATSU
FLANGIA 90° SERIE KOMATSU

PART. REF.	HOSE BORE			FLANGE	DIMENSIONS mm					
	DN	inch	Size		B	A	C	E		
M24191-10-10	16	5/8"	- 10	5/8"	14,0	56,0	34,0	47,5		
M24191-12-10	19	3/4"	- 12	5/8"	14,0	56,0	34,0	47,5		

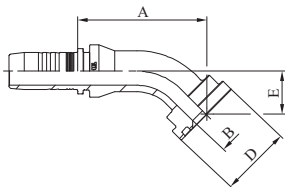

M24141

45° KOMATSU FLANGE
BRIDA KOMATSU CODO DE 45°
FLANSCH 45° BOGEN KOMATSU
FLANGIA 45° SERIE KOMATSU

PART. REF.	HOSE BORE			FLANGE	DIMENSIONS mm					
	DN	inch	Size		B	A	C	E		
M24141-10-10	16	5/8"	- 10	5/8"	14,0	61,0	34,0	22,0		

ORIGINAL EQUIPMENT CONNECTIONS

M23911

STRAIGHT SUPERCAT FLANGE
BRIDA RECTA SUPERCAT
FLANSCH GERADE SUPERCAT
FLANGIA DRITTA SERIE SUPERCAT

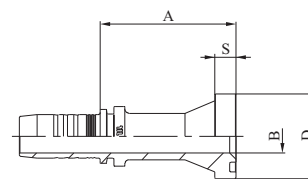

PART. REF.	HOSE BORE			FLANGE	DIMENSIONS mm			
	DN	inch	Size		B	A	D	S
M23911-12-12	19	3/4"	- 12	3/4"	15,0	74,5	41,5	14,3
M23911-16-16	25	1"	- 16	1"	19,8	86,8	47,7	14,3
M23911-16-20	25	1"	- 16	1.1/4"	26,0	92,3	54,0	14,3
M23911-20-20	31	1.1/4"	- 20	1.1/4"	26,0	86,0	54,0	14,3
M23911-24-24	38	1.1/2"	- 24	1.1/2"	32,0	94,0	63,6	14,3

M23991

90° SUPERCAT FLANGE
BRIDA SUPERCAT CODO DE 90°
FLANSCH 90° BOGEN SUPERCAT
FLANGIA 90° SERIE SUPERCAT

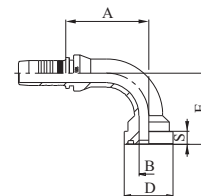

PART. REF.	HOSE BORE			FLANGE	DIMENSIONS mm				
	DN	inch	Size		B	A	D	E	S
M23991-12-12	19	3/4"	- 12	3/4"	15,0	64,5	41,5	64,5	14,3
M23991-16-16	25	1"	- 16	1"	19,8	77,5	47,7	76,5	14,3
M23991-16-20	25	1"	- 16	1.1/4"	26,0	75,5	54,0	80,5	14,3
M23991-20-20	31	1.1/4"	- 20	1.1/4"	26,0	85,5	54,0	87,0	14,3

M23941

45° SUPERCAT FLANGE
BRIDA SUPERCAT CODO DE 45°
FLANSCH 45° BOGEN SUPERCAT
FLANGIA 45° SERIE SUPERCAT

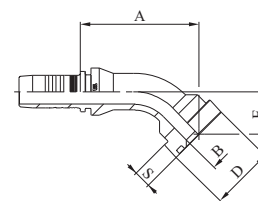

PART. REF.	HOSE BORE			FLANGE	DIMENSIONS mm				
	DN	inch	Size		B	A	D	E	S
M23941-12-12	19	3/4"	- 12	3/4"	15,0	77,0	41,5	32,0	14,3
M23941-16-16	25	1"	- 16	1"	19,8	89,5	47,7	36,5	14,3
M23941-16-20	25	1"	- 16	1.1/4"	26,0	92,5	54,0	40,5	14,3
M23941-20-20	31	1.1/4"	- 20	1.1/4"	26,0	99,0	54,0	41,5	14,3

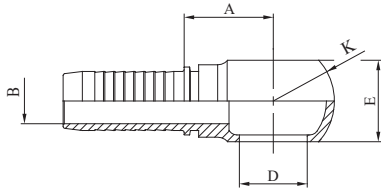

O20310

BSP BANJO
 BSP BANJO
 RINGNIPPEL, ZÖLLIG (BSP GEWINDE)
 OCCHIELLO GAS

PART. REF.	HOSE BORE			BSP BOLT	DIMENSIONS mm				
	DN	inch	Size		B	A	D	E	K
O20310-04-04	6	1/4"	- 04	1/4" - 19	4,1	22	13,3	14,0	24,0
O20310-04-06	6	1/4"	- 04	3/8" - 19	4,1	21	16,7	18,0	28,0
O20310-05-04	8	5/16"	- 05	1/4" - 19	5,1	22	13,3	14,0	24,0
O20310-05-06	8	5/16"	- 05	3/8" - 19	5,1	23	16,7	18,0	28,0
O20310-06-06	10	3/8"	- 06	3/8" - 19	7,1	24,1	16,7	18,0	28,0
O20310-06-08	10	3/8"	- 06	1/2" - 14	7,1	27,1	21,2	22,0	35,0
O20310-08-08	12	1/2"	- 08	1/2" - 14	9,6	27,5	21,2	22,0	35,0
O20310-10-10	16	5/8"	- 10	5/8" - 14	12,1	28,2	23,0	23,5	38,0
O20310-12-12	19	3/4"	- 12	3/4" - 14	15,0	36,5	26,7	29,0	45,0
O20310-16-16	25	1"	- 16	1" - 11	20,0	44,5	33,4	36,0	54,0

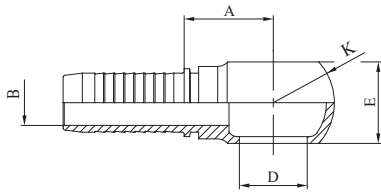

O20910

METRIC BANJO - DIN 7642
 BANJO METRICO - DIN 7642
 RINGNIPPEL, METRISCH - DIN 7642
 OCCHIELLO METRICO - DIN 7642

PART. REF.	HOSE BORE			MATIC BOLT	DIMENSIONS mm				
	DN	inch	Size		B	A	D	E	K
O20910-04-12	6	1/4"	- 04	M12 x 1,5	4,1	21	12,0	12,0	20,0
O20910-04-14	6	1/4"	- 04	M14 x 1,5	4,1	21,5	14,0	14,0	24,0
O20910-05-14	8	5/16"	- 05	M14 x 1,5	5,1	23,1	14,0	14,0	24,0
O20910-06-14	10	3/8"	- 06	M14 x 1,5	7,1	24,1	14,0	14,0	24,0
O20910-06-16	10	3/8"	- 06	M16 x 1,5	7,1	24,1	16,0	18,0	28,0
O20910-06-18	10	3/8"	- 06	M18 x 1,5	7,1	27,1	18,0	20,0	32,0
O20910-08-18	12	1/2"	- 08	M18 x 1,5	9,6	27,5	18,0	20,0	32,0
O20910-08-22	12	1/2"	- 08	M22 x 1,5	9,6	27,5	22,0	22,0	35,0
O20910-10-22	16	5/8"	- 10	M22 x 1,5	12,1	28,2	22,0	23,5	38,0
O20910-12-26	19	3/4"	- 12	M26 x 1,5	15,0	36,5	26,0	29,0	45,0

ACCESSORIES

M..IP

BRAZING TAIL

ESPIGA SOLDABLE (SALVAVIDAS)

EINLÖTNIPPEL

INSERTO A SILDARE

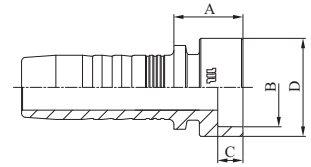

PART. REF.	HOSE BORE			DIMENSIONS mm					
	DN	inch	Size	B	A	C	D		
M03IP06	5	3/16"	- 03	6,0	11,5	5,0	10,0		
M04IP08	6	1/4"	- 04	8,0	13,0	5,0	12,0		
M05IP10	8	5/16"	- 05	10,0	13,5	6,0	14,0		
M06IP12	10	3/8"	- 06	12,0	13,5	6,0	16,0		
M06IP14	10	3/8"	- 06	14,0	13,5	6,0	18,0		
M08IP15	12	1/2"	- 08	15,0	14,0	6,0	20,0		
M08IP16	12	1/2"	- 08	16,0	14,0	6,0	20,0		
M10IP18	16	5/8"	- 10	18,0	15,0	7,0	23,0		
M12IP22	19	3/4"	- 12	22,0	16,0	7,0	26,0		
M16IP28	25	1"	- 16	28,0	18,5	8,0	34,0		
M20IP35	31	1.1/4"	- 20	35,0	21,5	9,0	40,0		
M24IP40	38	1.1/2"	- 24	40,0	21,5	9,0	50,0		
M32IP50	51	2"	- 32	50,0	23,0	10,0	60,0		
M40IP60	63	2.1/2"	- 40	60,0	22,0	10,0	73,0		
M48IP70	76	3"	- 48	70,0	38,0	10,0	89,0		

M10050

DOUBLE CONNECTOR

CONECTOR DOBLE

SCHLAUCHVERBINDER - DOPPELNIPPEL

DOPPIO INSERTO

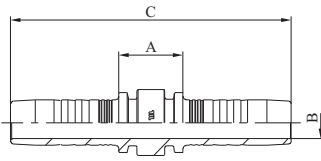

PART. REF.	HOSE BORE			DIMENSIONS mm						
	DN	inch	Size		B	A	C			
M10050-03-03	5	3/16"	- 03		3,0	15,5	58,5			
M10050-04-04	6	1/4"	- 04		4,0	14,0	69,0			
M10050-05-05	8	5/16"	- 05		5,5	14,0	70,0			
M10050-06-06	10	3/8"	- 06		7,0	14,7	73,5			
M10050-08-08	12	1/2"	- 08		9,3	15,8	78,0			
M10050-10-10	16	5/8"	- 10		12,5	15,4	84,0			
M10050-12-12	19	3/4"	- 12		15,0	18,5	91,5			
M10050-16-16	25	1"	- 16		19,8	22,6	119,0			
M10050-20-20	31	1.1/4"	- 20		26,0	23,0	128,0			
M10050-24-24	38	1.1/2"	- 24		32,0	23,5	147,5			

ACCESSORIES

O80210

BSP BOLT
TORNILLO PASADOR BSP
HOHLSCHRAUBE ZÖLLIG
VITE GAS FORATA

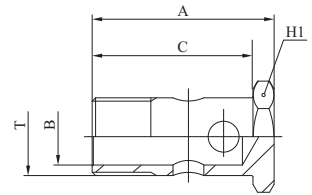

PART. REF.	HOSE BORE			DIMENSIONS mm				
				T	B	A	C	H ₁
O80210-04				1/4" - 19	7,0	32,0	25,0	17
O80210-06				3/8" - 19	9,0	38,0	31,0	22
O80210-08				1/2" - 14	13,0	46,0	38,0	27
O80210-10				5/8" - 14	13,5	49,0	41,0	30
O80210-12				3/4" - 14	17,0	56,0	46,0	32
O80210-16				1" - 11	22,0	69,0	58,0	41

O80810

METRIC BOLT - DIN 7643
TORNILLO PASADOR METRICO - DIN 7643
HOHLSCHRAUBE - METRISCH - DIN 7643
VITE METRICA FORATA - DIN 7643

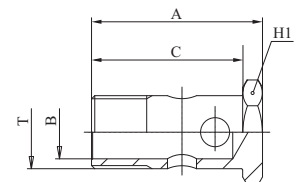

PART. REF.	HOSE BORE			DIMENSIONS mm				
				T	B	A	C	H ₁
O80810-12				M12 x 1,5	6,0	28,0	23,0	17
O80810-14				M14 x 1,5	8,0	32,0	25,0	19
O80810-16				M16 x 1,5	9,0	38,0	31,0	22
O80810-18				M18 x 1,5	11,0	44,0	36,0	24
O80810-22				M22 x 1,5	13,0	46,0	38,0	27
O80810-26				M26 x 1,5	17,0	56,0	46,0	32