

### PROGRAMMA DI PRODUZIONE PRODUCTION RANGE MENGENTEILER

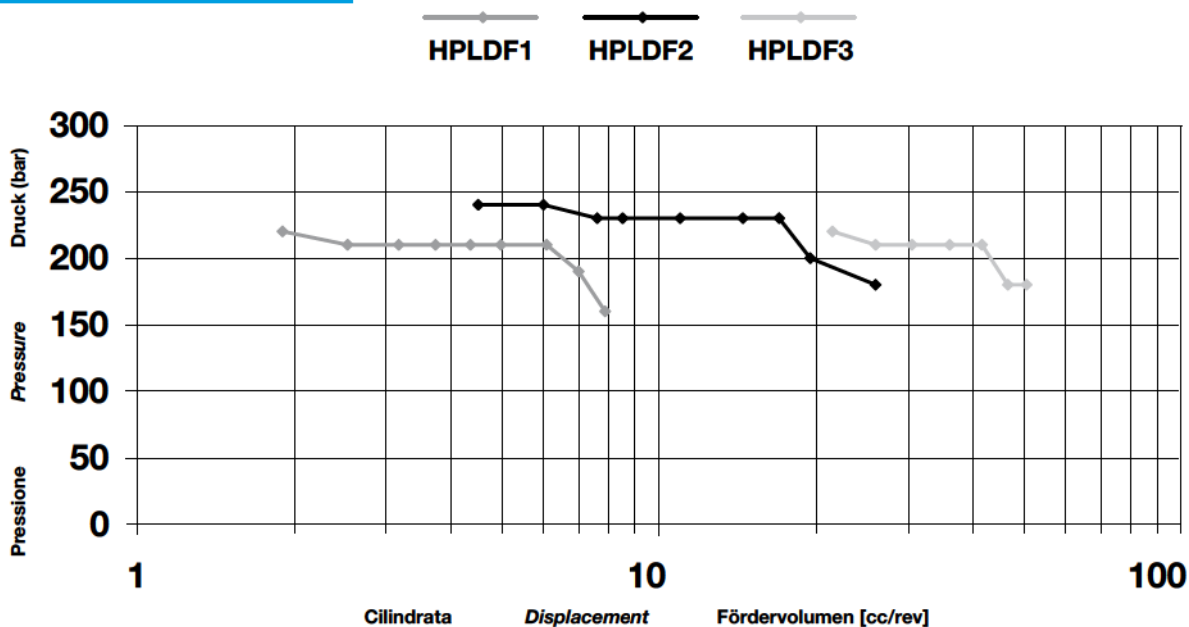

### DATI TECNICI TECHNICAL DATA TECHNISCHE MERKMALE

GRUPPO GROUP BAUREIHE	TIPO TYPE TYP	CILINDRATA TEORICA NOMINAL DISPLACEMENT FÖRDERVOLUMEN (TM)		PRESSIONE PRESSURE DRUCK				ΔP MAX TRA LE SEZIONI ΔP MAX OUTLET BETWEEN SECTIONS ΔP ZWISCHEN DEN STUFEN		VELOCITÀ DI ROTAZIONE SPEED DREHZAHL	
		cm <sup>3</sup>	in <sup>3</sup>	bar	psi	bar	psi	bar	psi	MIN min <sup>-1</sup>	MAX min <sup>-1</sup>
1	19	1,90	0,12	220	3191	260	3771	190	2756	4800	700
	24	2,53	0,15	210	3046	250	3626	180	2611		
	31	3,17	0,19	210	3046	250	3626	180	2611		
	36	3,73	0,23	210	3046	250	3626	180	2611		
	44	4,35	0,27	210	3046	250	3626	180	2611	3600	
	48	4,97	0,30	210	3046	250	3626	180	2611		
	60	6,08	0,37	210	3046	250	3626	180	2611		
	70	7,00	0,43	190	2756	210	3046	160	2321		
80	7,87	0,48	160	2321	180	2611	130	1885			
2	05	4,50	0,27	240	3481	260	3771	210	3046	4000	700
	06	6,00	0,37	240	3481	260	3771	210	3046		
	08	8,50	0,52	230	3336	250	3626	200	2901		
	11	11,00	0,67	230	3336	250	3626	200	2901		
	14	14,50	0,88	230	3336	250	3626	200	2901	3400	
	17	17,00	1,04	230	3336	250	3626	200	2901		
	20	19,50	1,19	200	2901	220	3191	170	2466		
26	26,00	1,59	180	2611	190	2756	150	2176			
3	22	21,50	1,31	220	3191	250	3626	190	2756	3500	700
	26	26,00	1,59	210	3046	250	3626	180	2611		
	31	30,50	1,86	210	3046	250	3626	180	2611		
	36	36,00	2,20	210	3046	250	3626	180	2611		
	41	41,50	2,53	210	3046	250	3626	180	2611		
	47	46,50	2,84	180	2611	210	3046	150	2176		
51	50,50	3,08	180	2611	210	3076	150	2176			



**HPLDF.1**

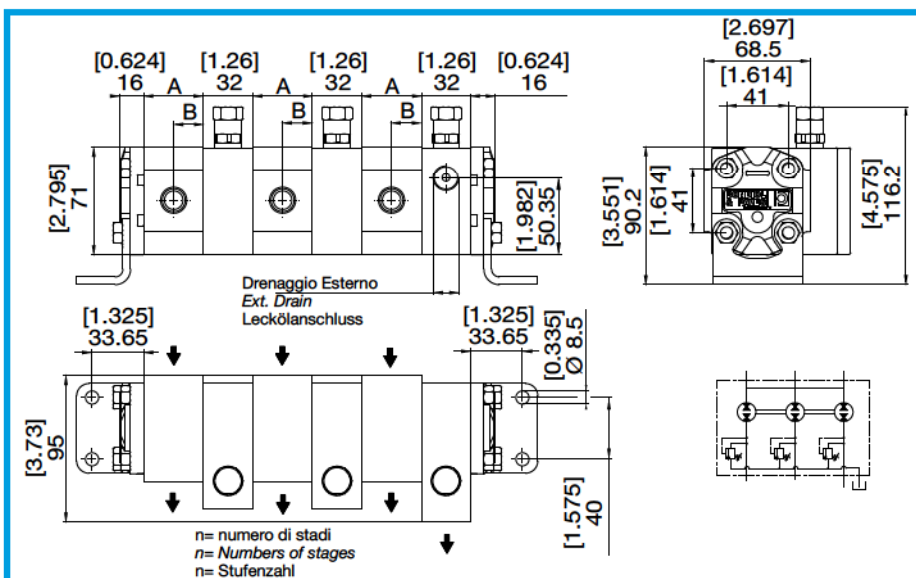
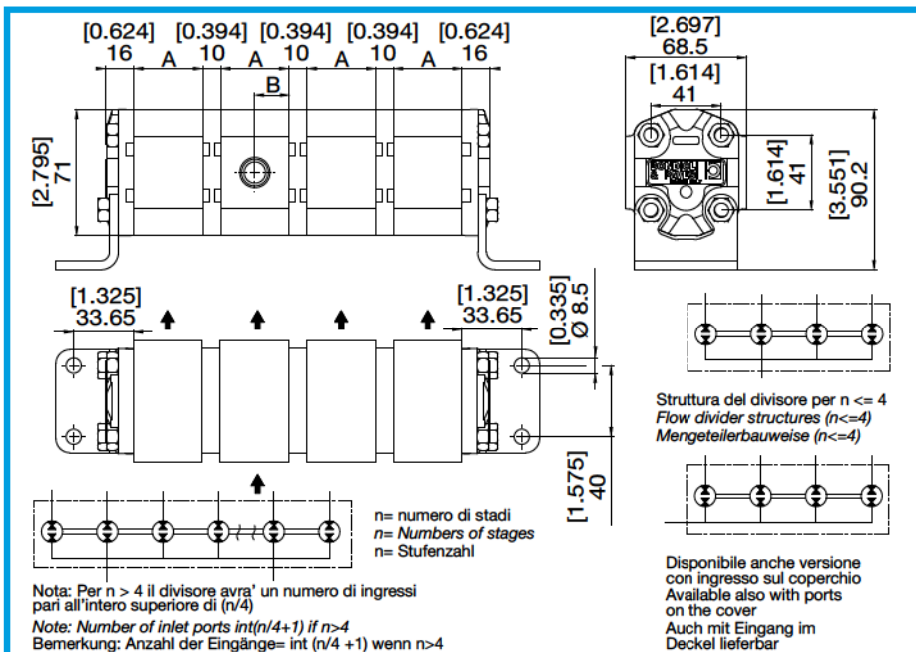
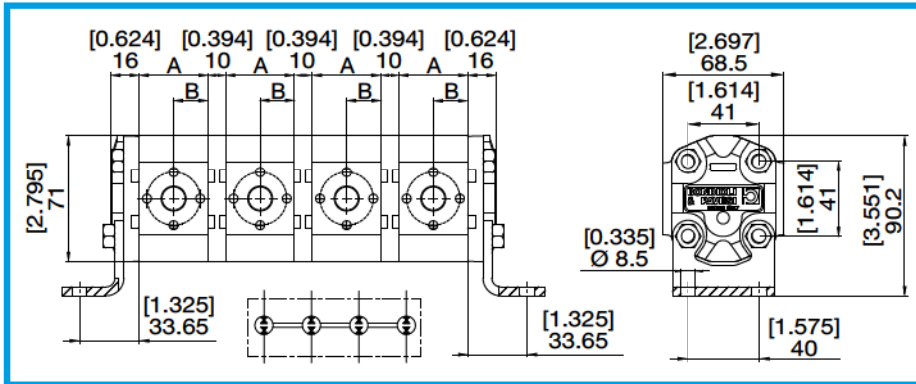

**DIMENSIONI  
SIZE  
ABMESSUNGEN**

GRUPPO GROUP BAUREIHE	TIPO TYPE TYP	A		B	
		mm	in	mm	in
1	19	38,7	1,524	19,4	0,762
	24	38,7	1,524	19,4	0,762
	31	38,7	1,524	19,4	0,762
	36	45,35	1,785	22,7	0,893
	44	45,35	1,785	22,7	0,893
	48	45,35	1,785	22,7	0,893
	60	56,05	2,207	28,0	1,103
	70	56,05	2,207	28,0	1,103
	80	56,05	2,207	28,0	1,103

**DIVISORI DI FLUSSO**  
**FLOW DIVIDERS**  
**MENGETEILER**

**HPLDF..**

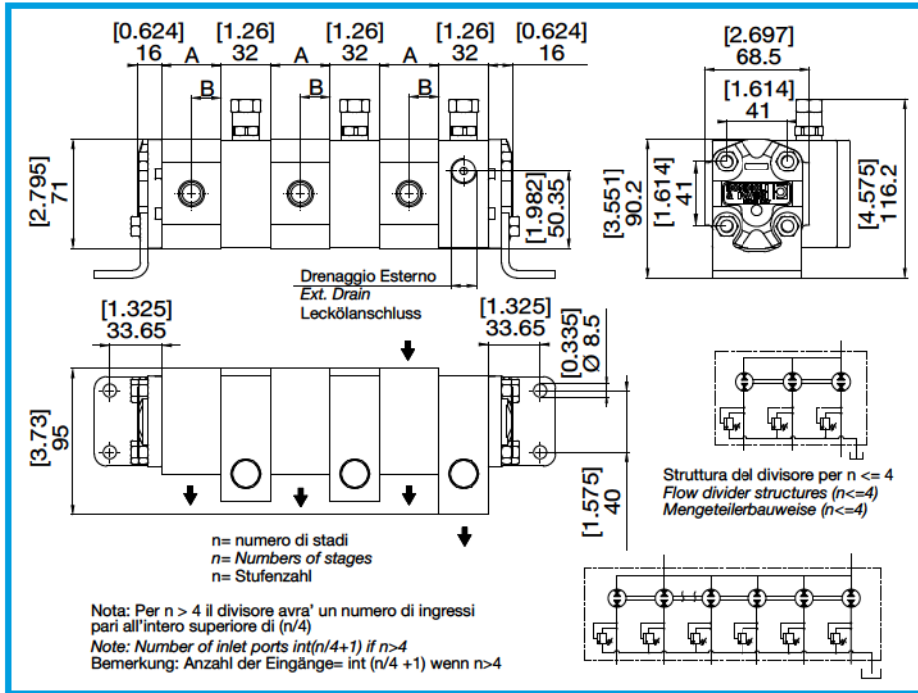

**HPLDF.1**

**DIMENSIONI**  
**SIZE**  
**ABMESSUNGEN**

GRUPPO GROUP BAUREIHE	TIPO TYPE TYP	A		B	
		mm	in	mm	in
1	19	38,7	1,524	19,4	0,762
	24	38,7	1,524	19,4	0,762
	31	38,7	1,524	19,4	0,762
	36	45,35	1,785	22,7	0,893
	44	45,35	1,785	22,7	0,893
	48	45,35	1,785	22,7	0,893
	60	56,05	2,207	28,0	1,103
	70	56,05	2,207	28,0	1,103
	80	56,05	2,207	28,0	1,103

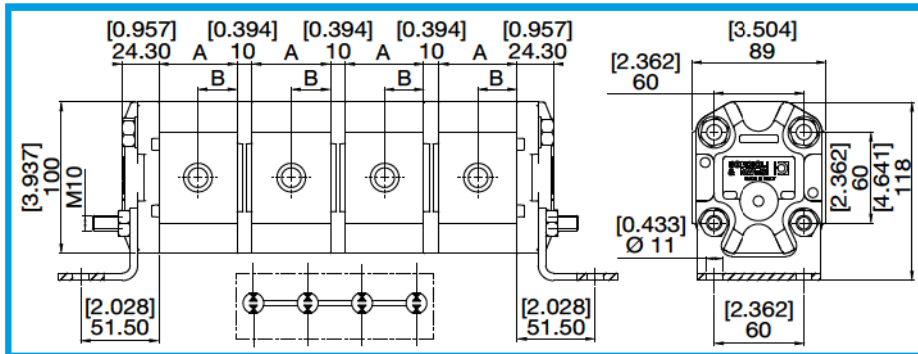

**HPLDF.2**

**DIMENSIONI**  
**SIZE**  
**ABMESSUNGEN**

GRUPPO GROUP BAUREIHE	TIPO TYPE TYP	A		B	
		mm	in	mm	in
2	05	49,15	1,935	24,6	0,968
	06	51,85	2,041	25,9	1,021
	08	56,35	2,219	28,2	1,109
	11	60,85	2,396	30,4	1,198
	14	67,25	2,648	33,6	1,324
	17	71,75	2,825	35,9	1,412
	20	76,25	3,002	38,1	1,501
	26	88,55	3,486	44,3	1,743



**HPLDF.2**

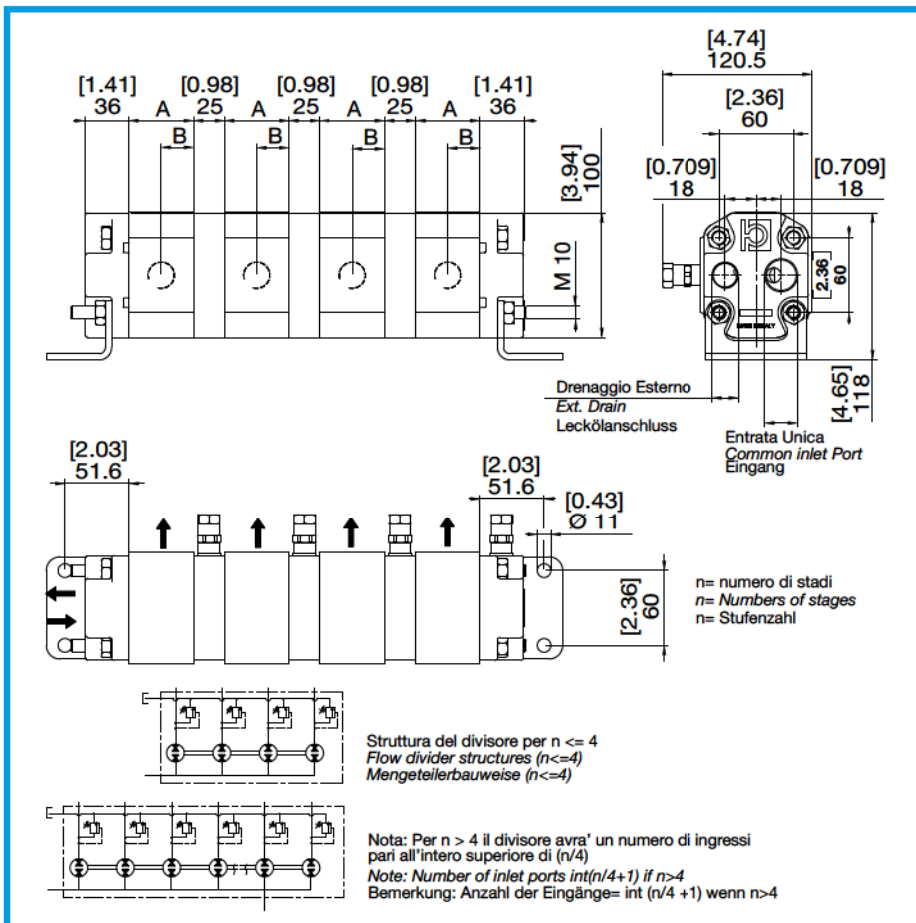
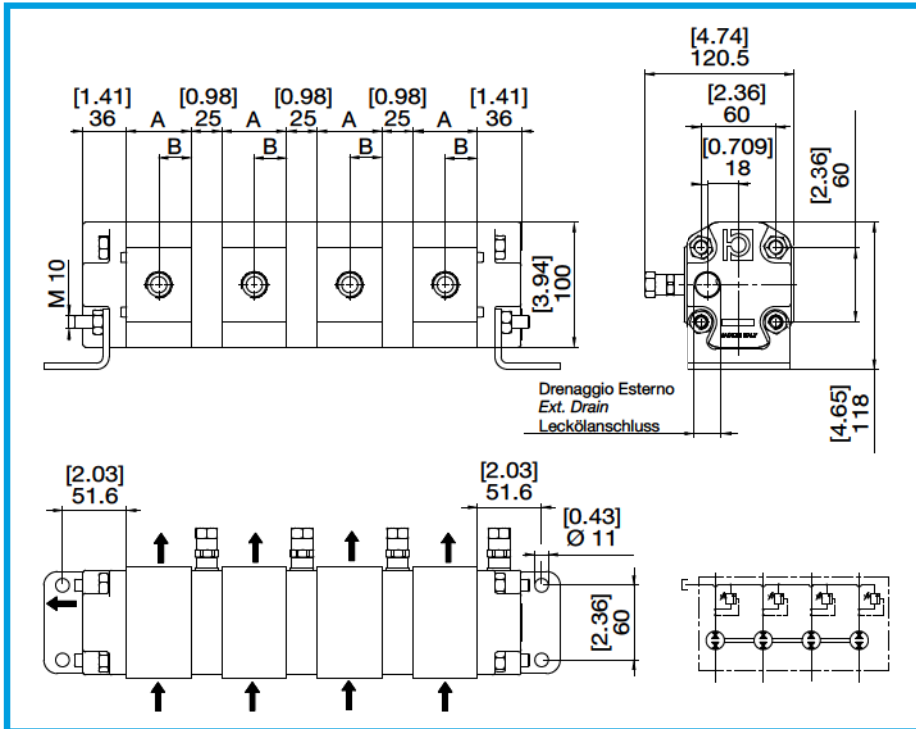

**DIMENSIONI  
SIZE  
ABMESSUNGEN**

GRUPPO GROUP BAUREIHE	TIPO TYPE TYP	A		B	
		mm	in	mm	in
2	05	49,15	1,935	24,6	0,968
	06	51,85	2,041	25,9	1,021
	08	56,35	2,219	28,2	1,109
	11	60,85	2,396	30,4	1,198
	14	67,25	2,648	33,6	1,324
	17	71,75	2,825	35,9	1,412
	20	76,25	3,002	38,1	1,501
	26	88,55	3,486	44,3	1,743

**DIVISORI DI FLUSSO**  
**FLOW DIVIDERS**  
**MENGENTEILER**

**HPLDF..**

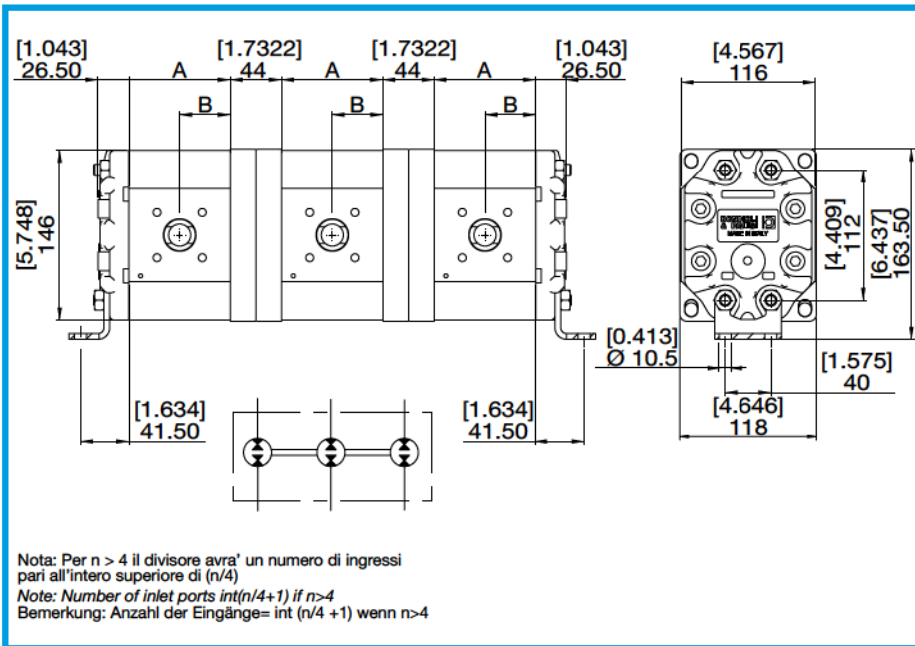

**HPLDF.3**

**DIMENSIONI**  
**SIZE**  
**ABMESSUNGEN**

GRUPPO GROUP BAUREIHE	TIPO TYPE TYP	A		B	
		mm	in	mm	in
<b>3</b>	<b>22</b>	81,07	3,192	40,5	1,594
	<b>26</b>	84,07	3,310	42,0	1,654
	<b>31</b>	87,07	3,428	43,5	1,714
	<b>36</b>	91,07	3,585	45,5	1,793
	<b>41</b>	95,07	3,743	47,5	1,870
	<b>47</b>	98,07	3,861	49,0	1,929
	<b>51</b>	101,07	3,979	50,5	1,990



**BOCCHIE  
PORTS  
ANSCHLÜSSE**

**HPLDF..**

**E** LATERALE  
LATERAL  
SEITLICH

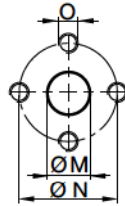

TIPO TYPE TYP	M		N		O
	mm	in	mm	in	
<b>E3</b>	13	0,51	30	1,18	M6
<b>E5</b>	20	0,79	40	1,57	M8
<b>E7</b>	27	1,34	51	2,01	M10

**G** LATERALE  
LATERAL  
SEITLICH  
**T** POSTERIORE  
REAR  
HINTEN

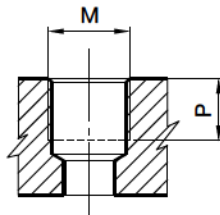

TIPO TYPE TYP	M	P	
		mm	in
<b>G3</b>	3/8" GAS BSPP	12	0,47
<b>G4</b>	1/2" GAS BSPP	16	0,63
<b>G6</b>	3/4" GAS BSPP	19	0,75
<b>G7</b>	1" GAS BSPP	21	0,83
<b>T4</b>	1/2" GAS BSPP	16	0,63
<b>T6</b>	3/4" GAS BSPP	19	0,75

**U** LATERALE  
LATERAL  
SEITLICH  
**C** POSTERIORE  
REAR  
HINTEN

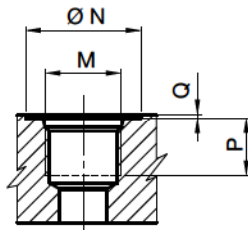

TIPO TYPE TYP	TIPO TYPE TYP	N		P		Q		M
		mm	in	mm	in	mm	in	
<b>U3</b>	3/8"	25	0,98	13	0,3	0,3	0,01	9/16"-18 UNF
<b>U4</b>	1/2"	30	1,18	15	0,3	0,3	0,01	3/4"-16 UNF
<b>U5</b>	5/8"	34	1,34	17	0,67	0,3	0,01	7/8"-14 UNF
<b>U6</b>	3/4"	41	1,61	19	0,75	0,3	0,01	1-1/16"-12 UNF
<b>U7</b>	1"	49	1,93	19	0,75	0,3	0,01	1-5/16"-12 UNF
<b>C5</b>	5/8"	34	1,34	17	0,67	0,3	0,01	7/8"-14 UNF
<b>C6</b>	3/4"	41	1,61	19	0,75	0,3	0,01	1-1/16"-12 UNF



**ISTRUZIONI PER L'ORDINAZIONE**  
**ORDERING INSTRUCTIONS**  
**BESTELLANLEITUNG**

**HPLDF..**

**HPL**

**DF**

**2**

**2**

**11**

**G4 G4**

**B**

**ST**

**--**

**SERIE**  
**SERIES**  
**SERIE**

**PRODOTTO**  
**PRODUCT**  
**PRODUKT**

**DF** - Divisori di flusso  
*Flow dividers*  
 Mengenteiler

**2 - 3 - 4 - 5 - 6**  
 N° degli Stadi  
 N° Stage  
 N° Stufen

**GRUPPO**  
**GROUP**  
**BAUGRÖSSE**

**1 - 2 - 3**

**CILINDRATA**  
**DISPLACEMENT**  
**FÖRDERVOLUMEN**

HPLDF.1	HPLDF.2	HPLDF.3
19 - 1,90	05 - 4,50	22 - 21,50
24 - 2,53	06 - 6,00	26 - 26,00
31 - 3,17	08 - 8,50	31 - 30,50
36 - 3,73	11 - 11,00	36 - 36,00
44 - 4,35	14 - 14,50	41 - 41,50
48 - 4,97	17 - 17,00	47 - 46,50
60 - 6,08	20 - 19,50	51 - 50,50
70 - 7,00	26 - 26,00	
80 - 7,87		

**SET VALVOLE**  
**VALVE SETTING**  
**VENTILEINSTELLUNG**  
 (bar)

**COPERCHI - COVERS - DECKEL**

**ST** - Standard  
**SG** - Versione in ghisa (solo HPLDF.3)  
*Version in cast iron (only HPLDF.3)*  
 Gussversion (nur HPLDF.3)  
**VE** - Con valvole (Vedi sez. valvole)  
*With valves (See valves section)*  
 Mit Ventilen (siehe Ventile Abschnitt)

**GUARNIZIONI**  
**SEALS**  
**DICHTUNGEN**

**B** - NBR

**V** - Viton

**BOCCHIE STD - STANDARD PORT - STANDARD ANSCHLÜSSE**

**HPLDF.1**

**CILINDRATA - DISPLACEMENT - FÖRDER-/SCHLUCKVOLUMEN**

1,9.....4,8			6.....8		
IN/OUT		DRAIN	IN/OUT		DRAIN
E3 E3		G3	E3 E3		G3
G3 G3		G3	G4 G4		G3
U3 U3		U3	U4 U4		U3

**ASPIRAZIONE UNICA COPERCHIO - COVER COMMON INLET - EINGANG DECKEL**

T4 G3		G3	T4 G4		G3
C5 U3		U3	U5 U4		U3

**ASPIRAZIONE UNICA CORPO - BODY COMMON INLET - EINGANG GEHÄUSE**

G4 G3		G3	G6 G4		G3
U4 U3		U3	U5 U4		U3

**HPLDF.2**

**CILINDRATA - DISPLACEMENT - FÖRDER-/SCHLUCKVOLUMEN**

5.....11		14.....20		26	
IN/OUT	DRAIN	IN/OUT	DRAIN	IN/OUT	DRAIN
E3 E3	G4	E5 E5	G4	E5 E5	G4
G4 G4	G4	G6 G6	G4	G6 G6	G4
U5 U5	U4	U6 U6	U4	U6 U6	U4

**ASPIRAZIONE UNICA COPERCHIO - COVER COMMON INLET - EINGANG DECKEL**

T6 G4	G4	T6 G4	G4	T6 G4	G4
C6 U5	U4	C6 U5	U4	C6 U5	U4

**ASPIRAZIONE UNICA CORPO - BODY COMMON INLET - EINGANG GEHÄUSE**

G6 G4	G4	G6 G4	G4	G7 G6	G4
U6 U4	U4	U6 U5	U4	U7 U6	U4

**HPLDF.3**

**CILINDRATA - DISPLACEMENT - FÖRDER-/SCHLUCKVOLUMEN**

22.....31		36.....51	
IN/OUT		IN/OUT	
E5 E5		E7 E7	
G6 G6		G7 G7	
U6 U6		U7 U7	